

REAR BUMPER KIT



P/N 2882021

APPLICATION

Verify accessory fitment at Polaris.com.

BEFORE YOU BEGIN

Read these instructions and check to be sure all parts and tools are accounted for. Please retain these installation instructions for future reference and parts ordering information.

KIT CONTENTS

This Kit includes:

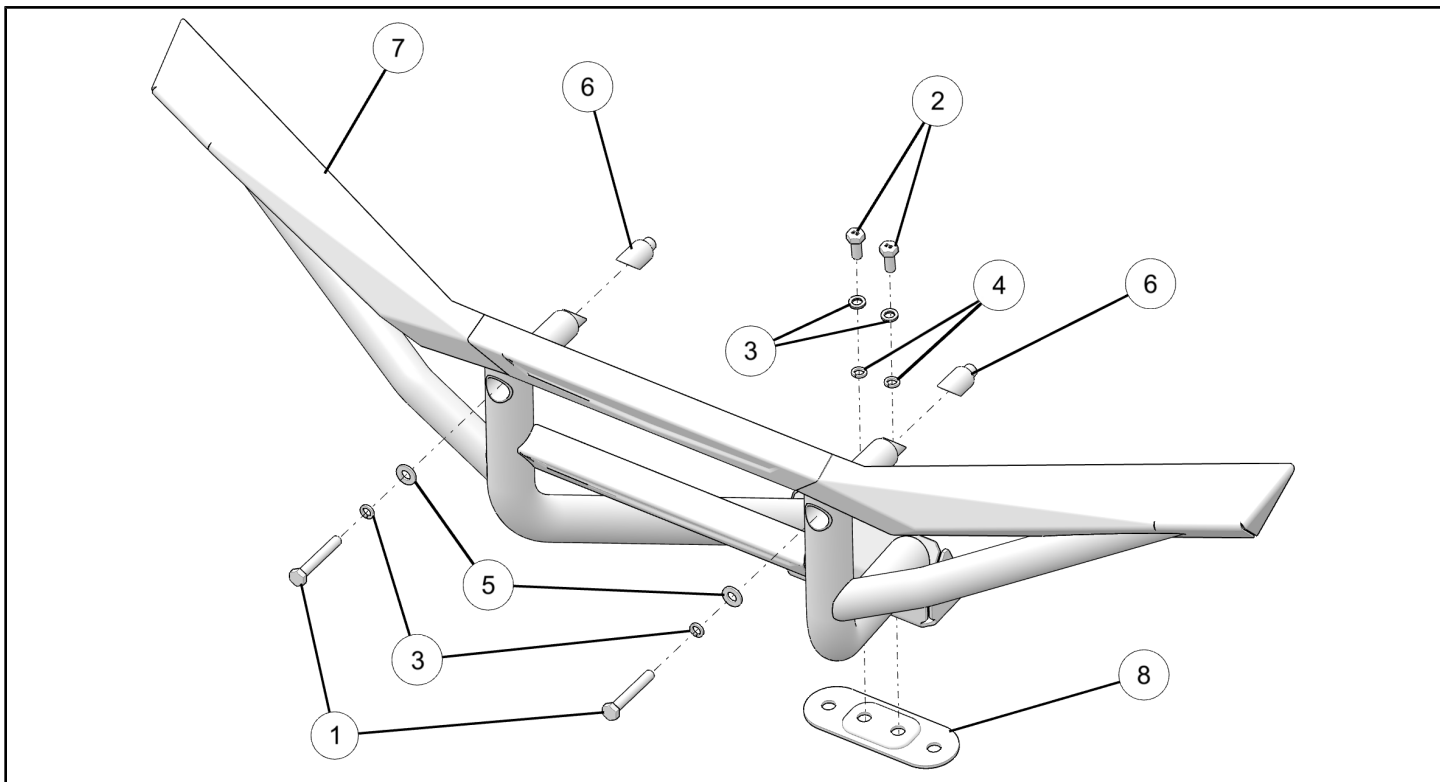

| REF | QTY | PART DESCRIPTION | PART NUMBER |
|-----|-----|---------------------------|-------------|
| 1* | 2 | Hex Bolt - M8 X 1.25 X 55 | - |
| 2* | 2 | Hex Bolt - M8 X 1.25 X 20 | - |
| 3* | 4 | Lock Washer - M8 | - |
| 4* | 2 | Flat Washer - M8 | - |
| 5* | 2 | Washer | - |
| 6* | 2 | Taper Lock Tube | - |
| 7 | 1 | Rear Bumper | - |
| 8* | 1 | Bumper Mounting Plate | - |
| | 1 | Instructions | 9927263 |

Items marked (*) are included in Hardware Kit PN 2206399.

TOOLS REQUIRED

- 13mm Socket and Ratchet Extension

IMPORTANT

Your REAR BUMPER KIT is exclusively designed for your vehicle. Please read the installation instructions thoroughly before beginning. Installation is easier if the vehicle is clean and free of debris. For your safety, and to ensure a satisfactory installation, perform all installation steps correctly in the sequence shown.

ASSEMBLY TIME

Approximately 15 minutes

INSTALLATION INSTRUCTIONS

1. Shift vehicle transmission into "PARK". Turn key to "OFF" position and remove from vehicle.
2. Install two taper lock tubes ⑥ on rear bumper weldment ⑦ using screws ① and washers ③ ⑤. Do not tighten screws ①.
4. Slide the bumper mounting plate ⑧ with nuts facing down into the gap between the top of A-arm pivot and the frame (B). Insert screws ② with lock washers ③ and flat washers ④ through the bumper ⑦ and vehicle frame (B) and thread into the bumper mounting plate ⑧. Tighten both screws ② to below specification.

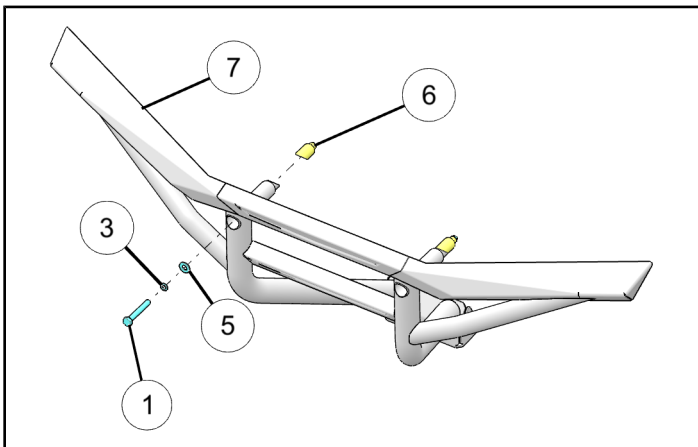

3. Install rear bumper assembly ⑦ by inserting wedge mounts into the bumper mount tubes (A). Push on bumper. Do not tighten screws ① at this time.

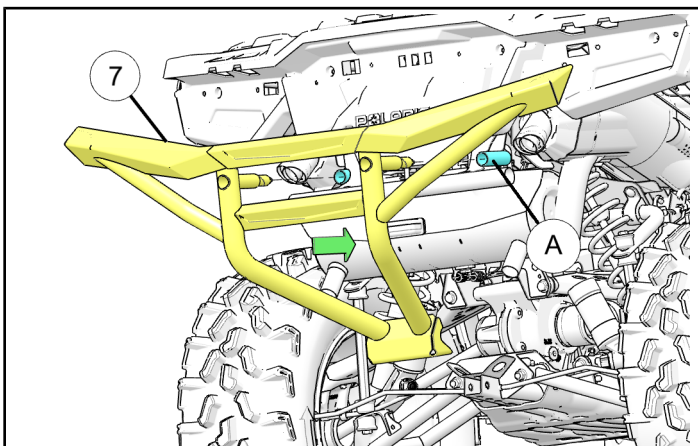

TORQUE

15 ft. lbs. (20 Nm)

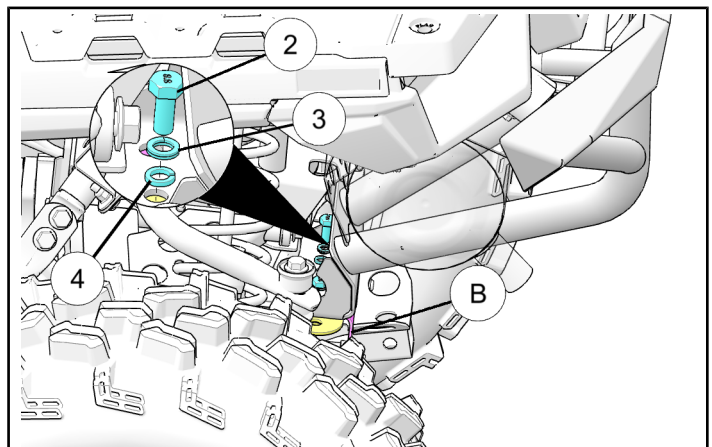
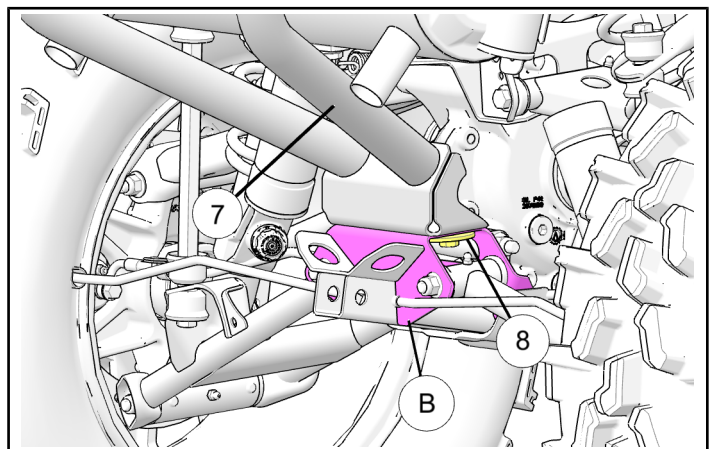

5. Tighten screws ① at this time to below specification. Final rear bumper ⑦ installation is shown below.

TORQUE

15 ft. lbs. (20 Nm)

