

# REAR RACK EXTENDER KIT



P/N 2882023

## APPLICATION

Verify accessory fitment at [Polaris.com](http://Polaris.com).

## BEFORE YOU BEGIN

Read these instructions and check to be sure all parts and tools are accounted for. Please retain these installation instructions for future reference and parts ordering information.

## KIT CONTENTS

This Kit includes:

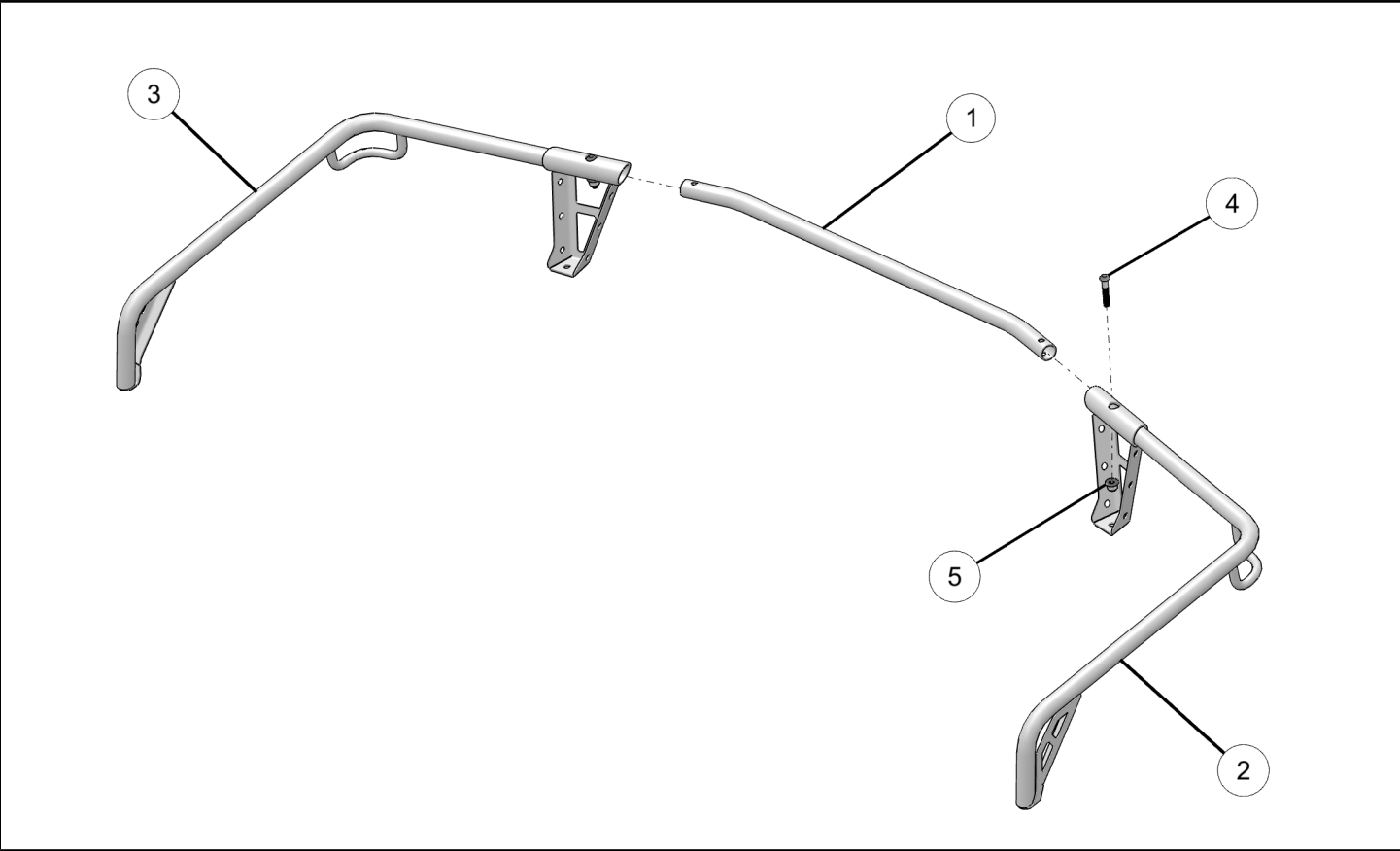

| REF | QTY | PART DESCRIPTION                | PART NUMBER |
|-----|-----|---------------------------------|-------------|
| 1   | 1   | Rear Rack Extender, Center      | -           |
| 2   | 1   | Rear Rack Extender, LH          | -           |
| 3   | 1   | Rear Rack Extender, RH          | -           |
| 4   | 2   | Button Head Cap Screw - M6 X 35 | -           |
| 5   | 2   | Lock Nut - M6 Flange            | -           |
|     | 1   | Instructions                    | 9927748     |

## TOOLS REQUIRED

- Safety Glasses
- Metric Socket Set

- Metric Wrench Set
- Torx Drivers

## IMPORTANT

Your REAR RACK EXTENDER KIT is exclusively designed for your vehicle. Please read the installation instructions thoroughly before beginning. Installation is easier if the vehicle is clean and free of debris. For your safety, and to ensure a satisfactory installation, perform all installation steps correctly in the sequence shown.

## ASSEMBLY TIME

Approximately 15 minutes

## INSTALLATION INSTRUCTIONS

1. Shift vehicle transmission into "PARK". Turn key to "OFF" position and remove from vehicle.
2. Install the rear rack extenders (LH ② and RH ③) to the center rack extender ① using two screws ④ and nuts ⑤. Do not tighten screws at this time.
3. Remove screws (A) from the rear and screws (B) and associated nuts from the front of rear rack (C) as shown. Retain screws (A) and (B) for reuse and discard nuts.

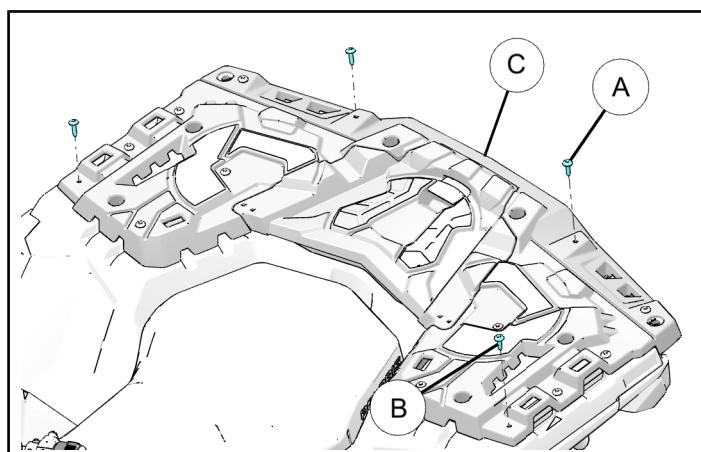
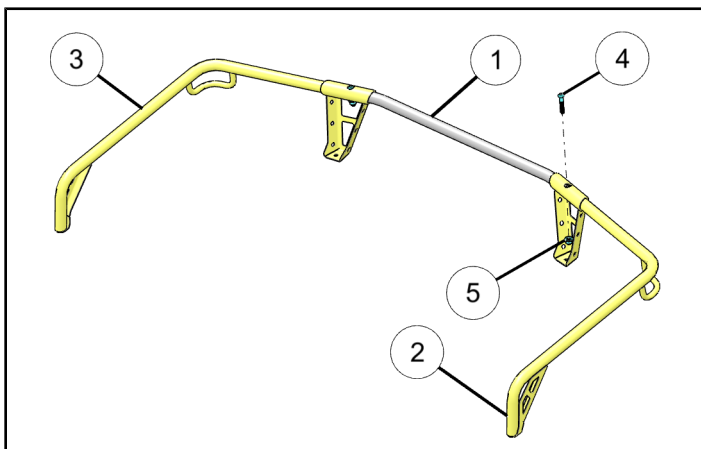
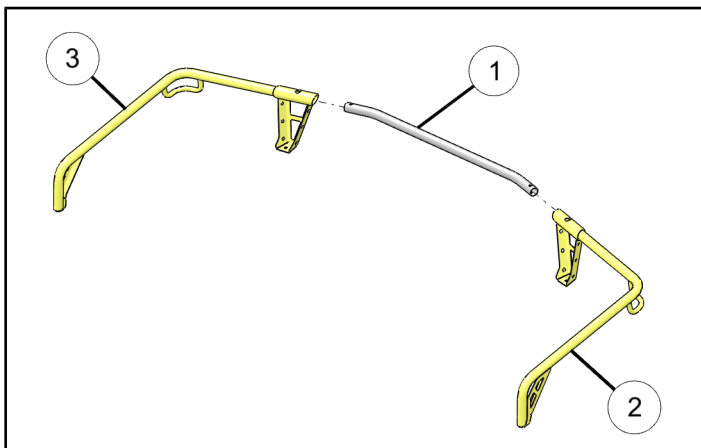

4. Install rear rack extender assembly on rear rack as shown and install two screws (A) removed in Step 3. Tighten fasteners to specification.

### TORQUE

6 ft. lbs. (8.1 Nm)

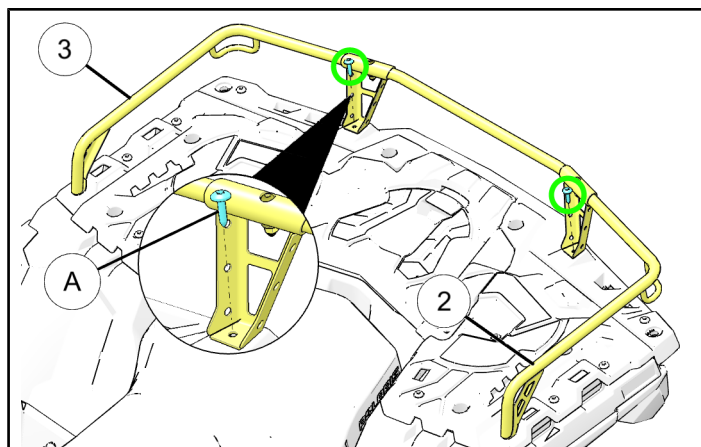

5. Reinstall two screws (B) removed in Step 3 onto the rear rack extender (LH ② and RH ③) from the bottom side of the vehicle as shown. Tighten fasteners to specification.

#### TORQUE

6 ft. lbs. (8.1 Nm)

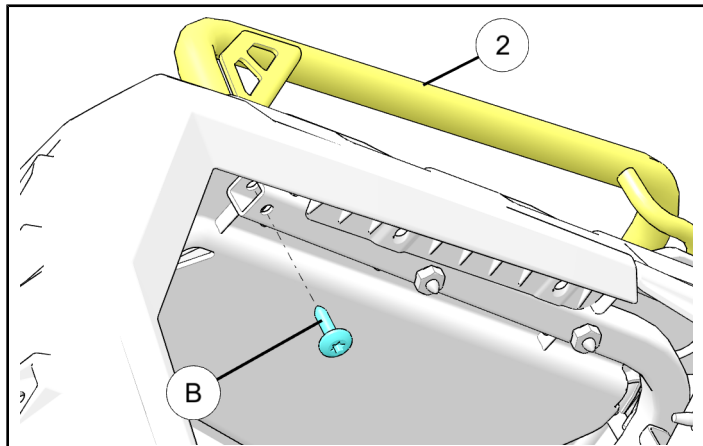

6. Tighten screws ④ and nuts ⑤ at this time to below specification.

#### TORQUE

6 ft. lbs. (8.1 Nm)

#### COMPATIBILITY

Rear rack extender kit is compatible with following accessory kits.

- Gun Mount Kit (PN 2882272)
- Cargo Box Kit (PN 2882026)