

FRONT NUMBER PLATE KIT



P/N 2883767

INTERNATIONAL INSTRUCTIONS

DE DEUTSCH

Laden Sie die neuesten PDF-Anweisungen von www.indianmotorcycle.de herunter.

FR FRANÇAIS

Télécharger les dernières instructions en format PDF sur www.indianmotorcycle.fr.

IT ITALIANO

Scarica l'ultima versione delle istruzioni in formato PDF da www.indianmoto.it.

EN ENGLISH

Download the latest PDF instructions from www.indianmotorcycle.com.

ES ESPAÑOL

Descargue las instrucciones más recientes en formato PDF de www.indianmotorcycle.mx / www.indianmotorcycle.es.

ZH 中文

从www.indianmotorcycle.cn 下载最新的PDF说明。

1

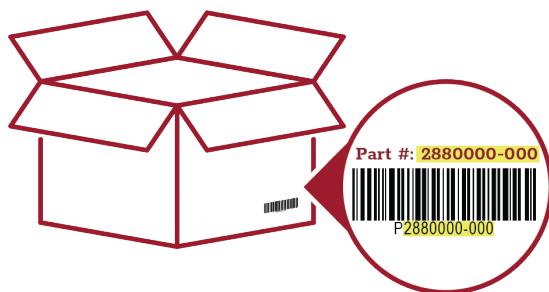

2



3



4



APPLICATION

Verify accessory fitment at www.indianmotorcycle.com.

IMPORTANT

Front Number Plate Kit P/N 2883767 requires removal of headlight cowl and is not compatible with windscreen kits.

BEFORE YOU BEGIN

Read these instructions and check to be sure all parts and tools are accounted for. Please retain these installation instructions for future reference and parts ordering information.

KIT CONTENTS

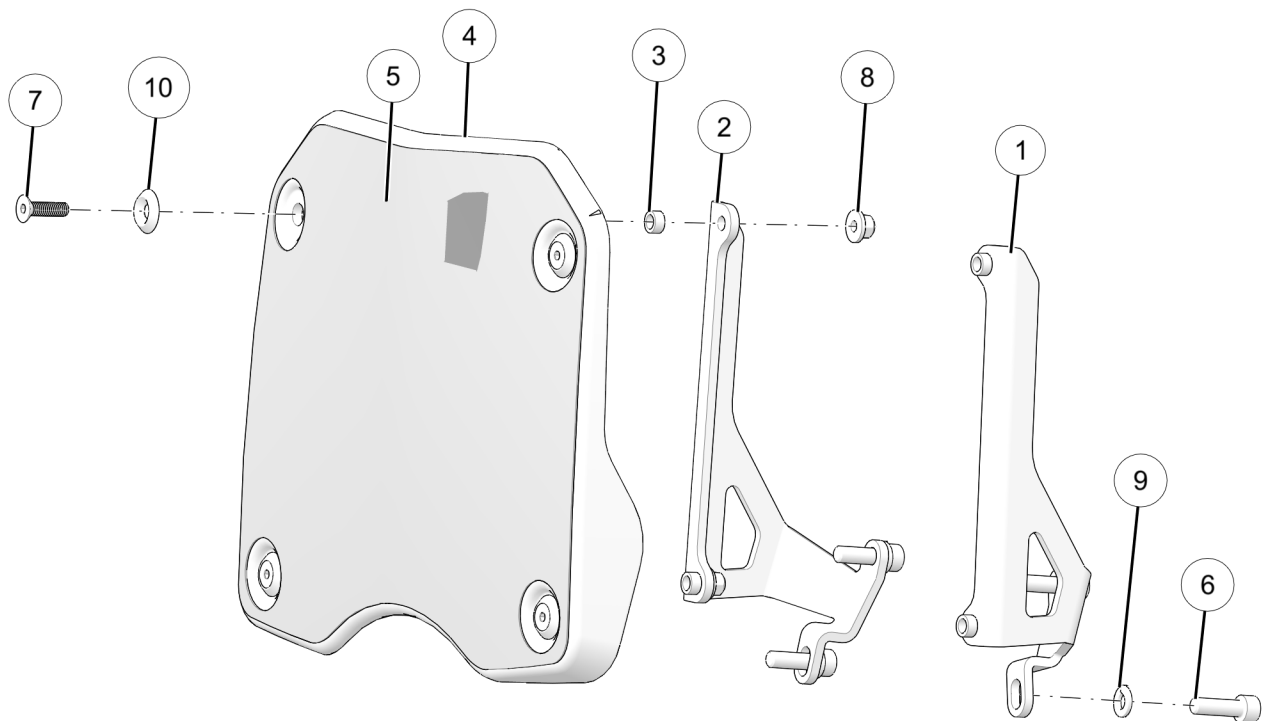

REF	QTY	PART DESCRIPTION	P/N AVAILABLE SEPARATELY
1	1	Weld-Bracket, Front Number Plate, LH	n/a
2	1	Weld-Bracket, Front Number plate, RH	n/a
3	4	Spacer, 5.0 x 8.0 x 4.0	5134403
4	1	Number Plate, Front	5456611
5	1	Decal, Number, Plate, Front	7191114
6	4	Screw-Socket Head, M6 x 1.0 x 20	7517305
7	4	Screw-Flange Head, M5 x 0.8 x 18	7521126
8	4	Nut, M5 x 0.8	7547951

REF	QTY	PART DESCRIPTION	P/N AVAILABLE SEPARATELY
9	4	Washer-Lock, 6 mm	7552616
10	4	Washer-Number plate, 5.3 x 16 x 2.8	7557185
	1	Instructions	9929492

TOOLS REQUIRED

- Safety Glasses
- Hex Key Set, Metric
- Socket Set, Hex Bit, Metric
- Torque Wrench

IMPORTANT

Your accessory kit is exclusively designed for your vehicle. Please read the installation instructions thoroughly before beginning. Installation is easier if the vehicle is clean and free of debris. For your safety, and to ensure a satisfactory installation, perform all installation steps correctly in the sequence shown.

INSTALLATION INSTRUCTIONS

VEHICLE PREPARATION

GENERAL

1. Turn key or ignition switch to OFF position and remove key.
2. Ensure motorcycle is parked on a flat surface, kickstand is fully extended, and vehicle is stable prior to installation.

HEADLIGHT COWL REMOVAL (IF APPLICABLE)

1. Remove four screws (A) and four washers (B) from headlight cowl.

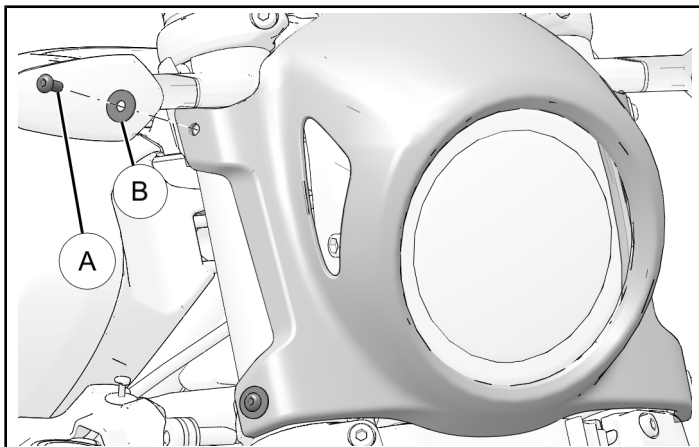

2. Remove headlight cowl from motorcycle.

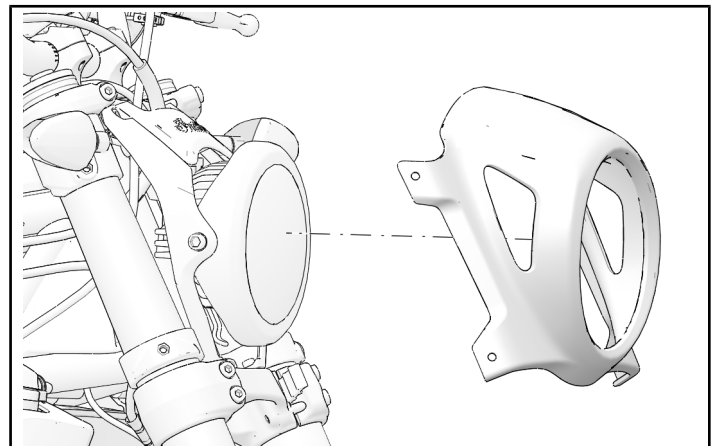

3. Remove and discard two fasteners ③ to remove lower head light cowl mounts from motorcycle.

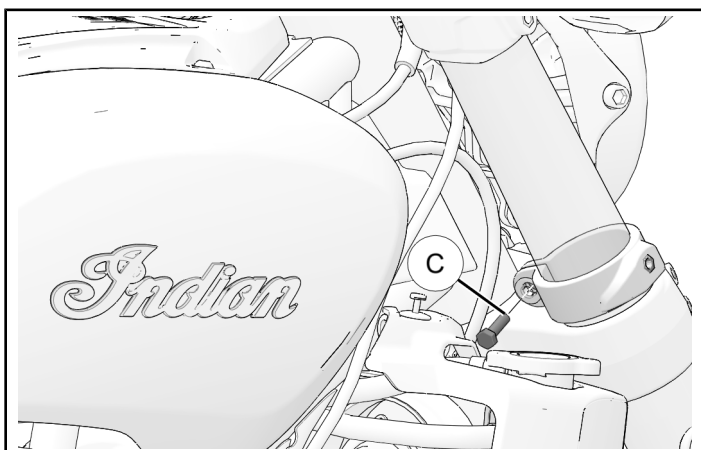
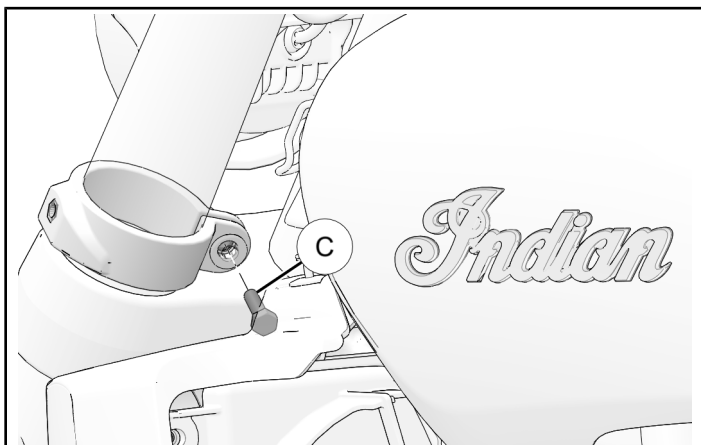

HEADLIGHT REMOVAL

1. Remove and retain two screws ① from top of headlight bracket.

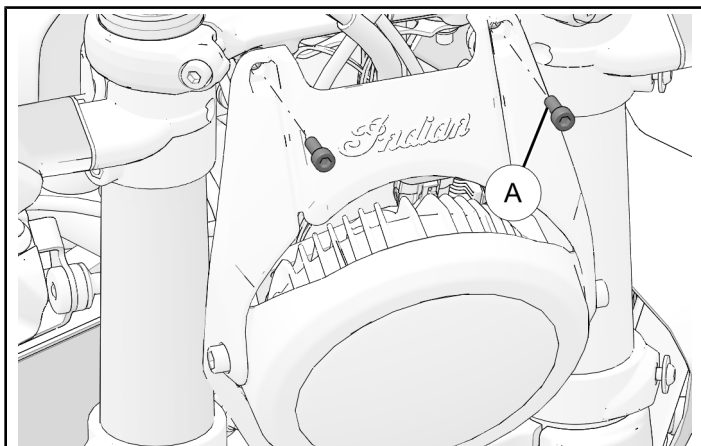

2. Remove and retain two screws ② from bottom of headlight bracket.

TIP

Turn handlebars lock-to-lock to access two screws ② from rear-side.

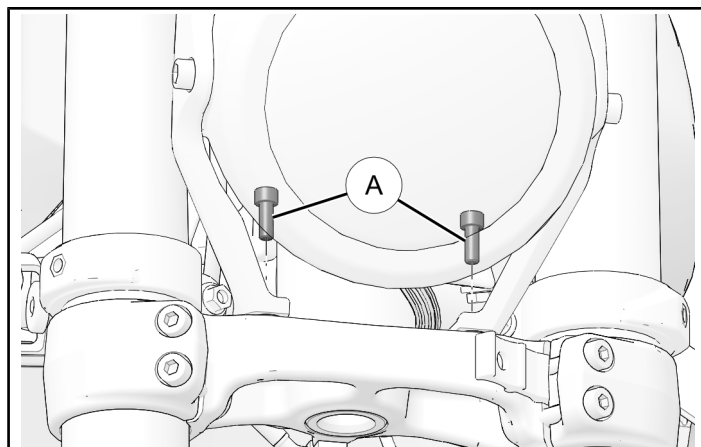

3. With headlight assembly unmounted, tilt assembly forward and slide electronic throttle control (ETC) connection off push-pin clip. It is not necessary to disconnect harnesses.

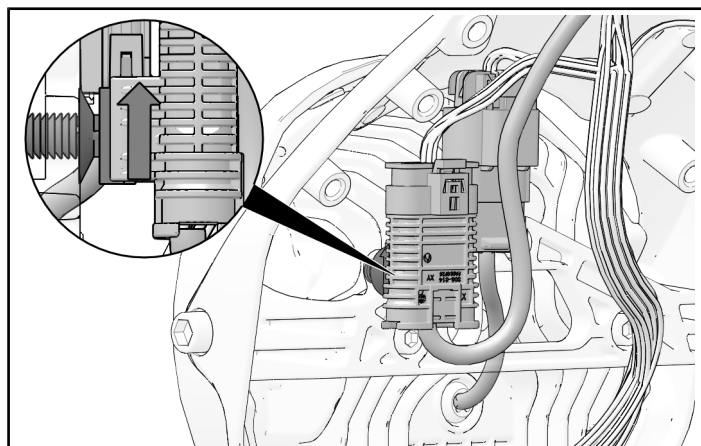

4. Disconnect headlight from chassis harness. Headlight connector will remain installed onto push-pin clip.

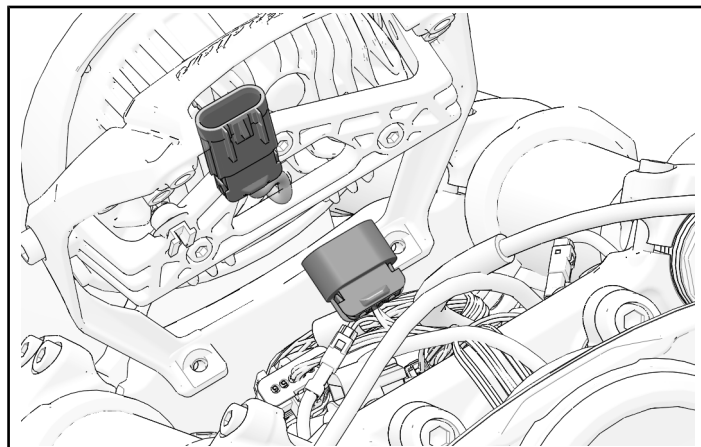

5. Carefully set headlight assembly aside on soft surface as to not scratch finished surfaces.

ACCESSORY INSTALLATION

DECAL APPLICATION

1. Clean application surface with isopropyl alcohol and wait for surface to completely dry before applying decal.

⚠ WARNING

Isopropyl alcohol is hazardous to your health. See isopropyl alcohol packaging for proper handling instructions, including recommended personal protective equipment such as goggles and chemical resistant gloves.

2. Apply decal ⑤ to front number plate.

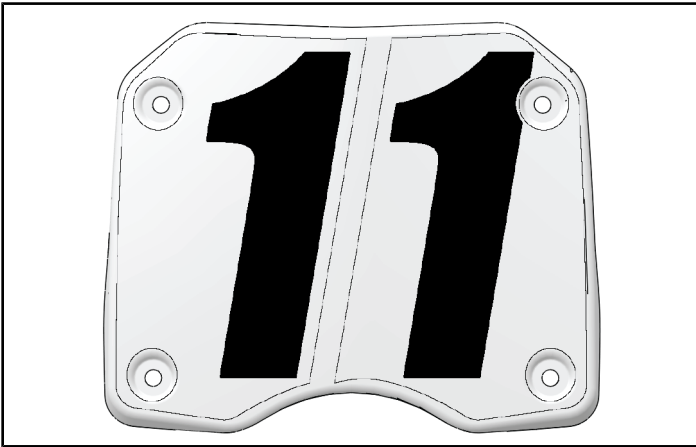

FRONT NUMBER PLATE INSTALLATION

1. Protect face of headlight assembly with cloth or other soft surface before placing face down.

2. Install two number plate brackets ① ② onto back of headlight bracket with four bracket fasteners ⑥ and four lock washers ⑨.

TORQUE

Bracket Fasteners ⑥ (Number Plate Bracket to Headlight Bracket):
96 in-lbs (11 N·m)

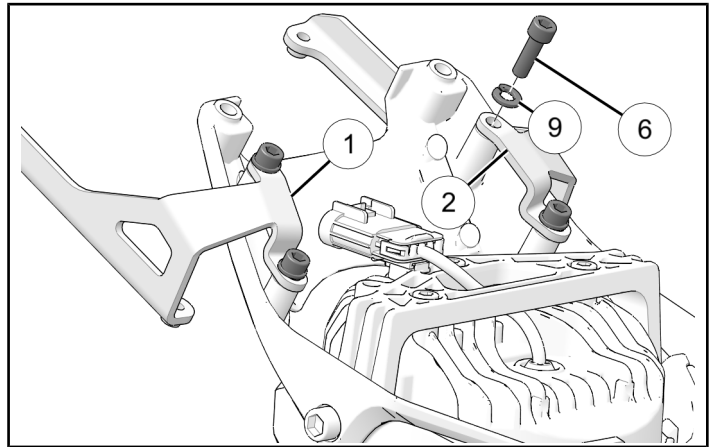

3. Verify alignment with number plate before proceeding. If bracket and number plate do not align, adjust bracket to proper alignment and torque fasteners again.
4. Re-join headlight connector to chassis harness connector.

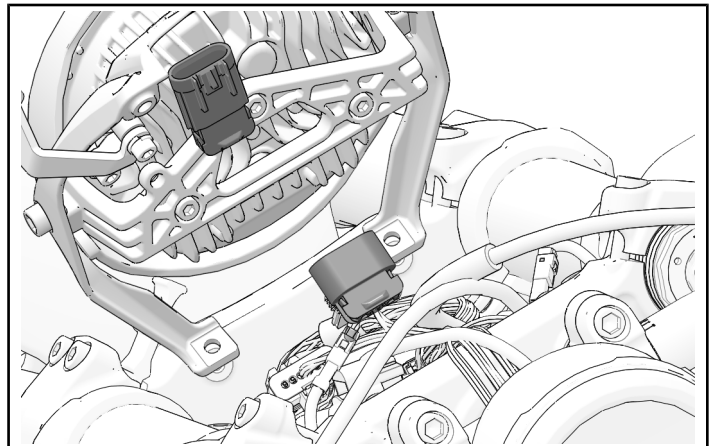

5. Re-mount electronic throttle control (ETC) connection onto push-pin clip.

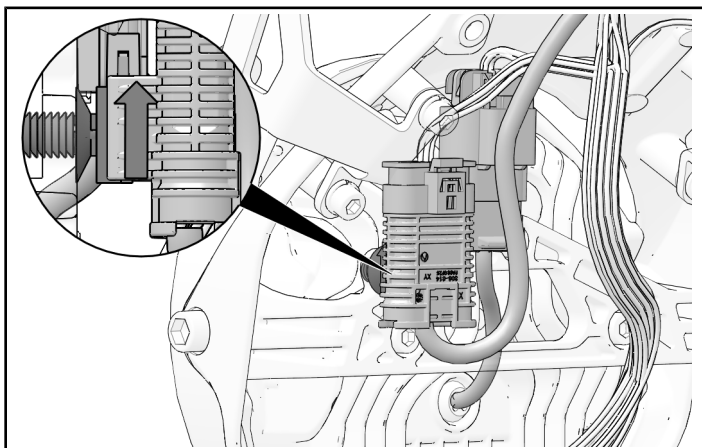

6. Reinstall bottom of headlight assembly with two retained headlight bracket fasteners (A).

Do not torque headlight fasteners at this time.

TIP

Turn handlebar lock-to-lock to access two fasteners from rear.

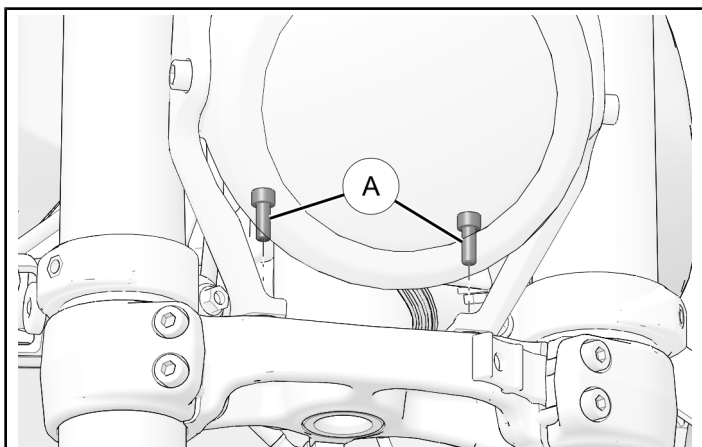

7. Reinstall top of headlight assembly with two retained headlight bracket fasteners (A).

TORQUE

Headlight Bracket Fasteners (A):
84 in-lbs (9.5 N·m)

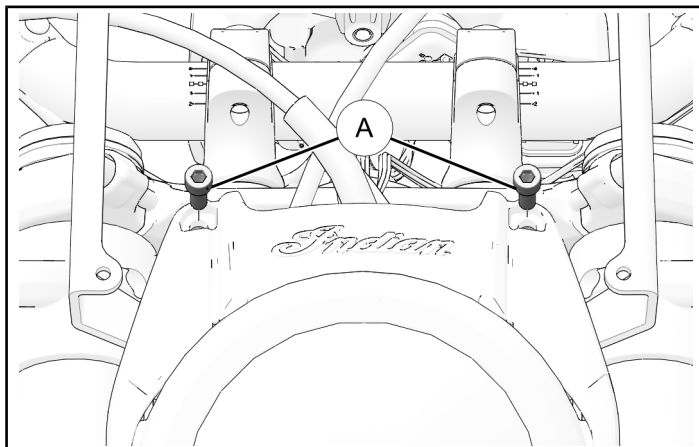

8. Mount front number plate (4) onto two brackets with the following hardware:

- Four bracket fasteners (7)
- Four washers (10)
- Four spacers (3)
- Four nuts (8)

TORQUE

Bracket Fasteners (7) (Bracket to Number Plate):
60 in-lbs (7 N·m)

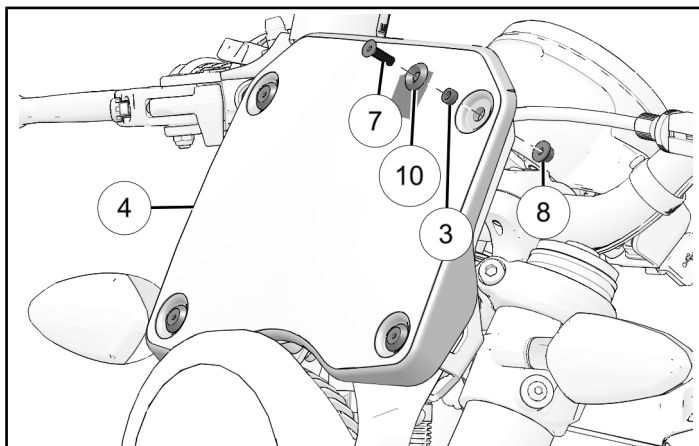

FEEDBACK FORM

A feedback form has been created for the installer to provide any comments, questions or concerns about the installation instructions. The form is viewable on mobile devices by scanning the QR code or by clicking [HERE](#) if viewing on a PC.

