

129/144 REAR BUMPER



P/N 2884257

BEFORE YOU BEGIN

Read these instructions and check to be sure all parts and tools are accounted for. Please retain these installation instructions for future reference and parts ordering information.

KIT CONTENTS

This Kit includes:

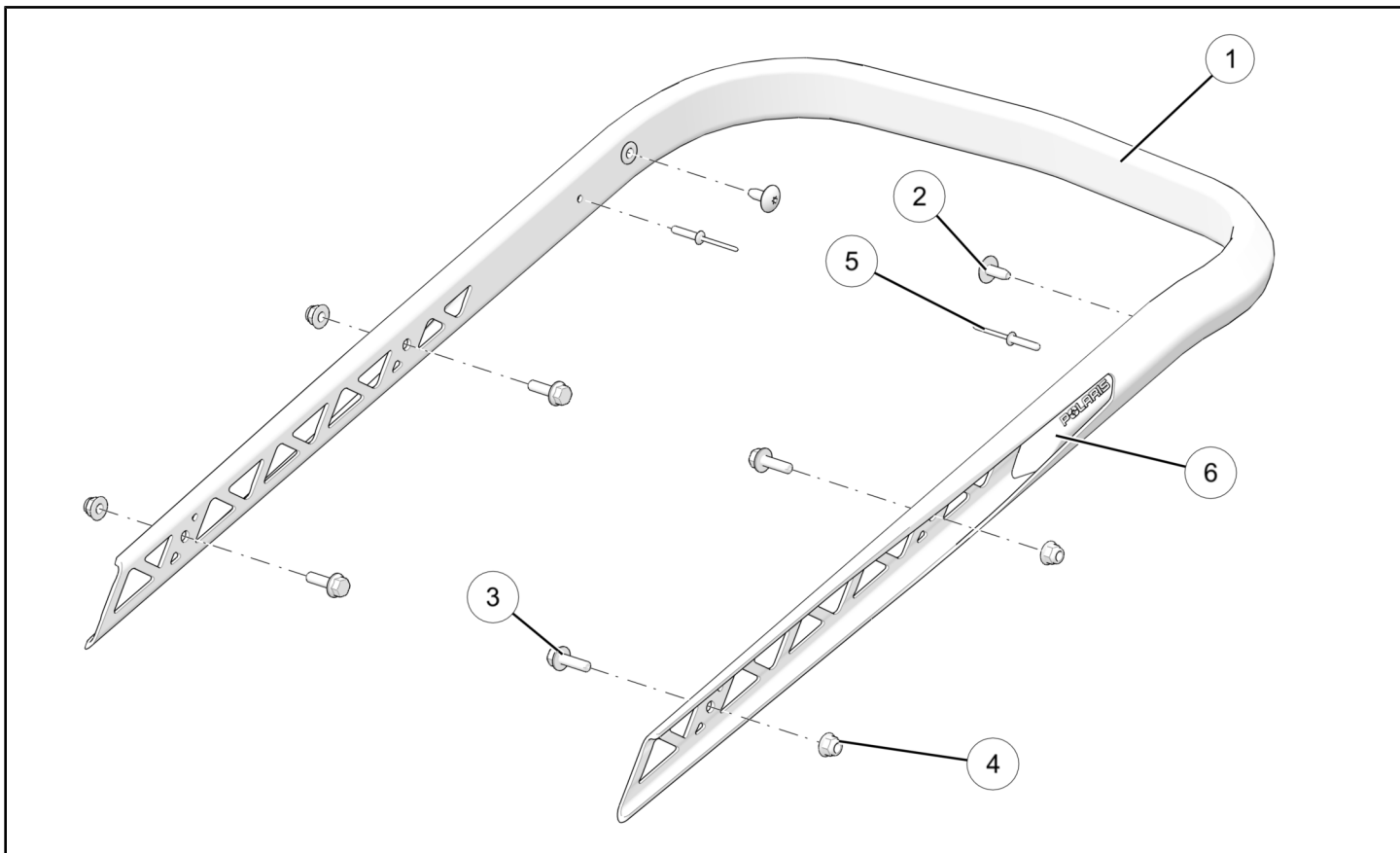

REF	QTY	PART DESCRIPTION	PART NUMBER
1	1	Rear Bumper Assembly	1023919
2	2	Screw, M6 X 1.0 X 15 TXTH	7519092
3	4	Screw, M6 X 1.0 X 20 HXFL	7518613
4	4	Locking Nut, M6 X 1.0 HXFL	7547453
5	2	Rivet - 5/32"	7621334
6	1	Plug-Tube, LH	5454821
7	1	Plug-Tube, RH (not shown)	5454822
	1	Instructions	9929768

IMPORTANT

Your 129/144 Rear Bumper is exclusively designed for your vehicle. Please read the installation instructions thoroughly before beginning. Installation is easier if the vehicle is clean and free of debris. For your safety, and to ensure a satisfactory installation, perform all installation steps correctly in the sequence shown.

TOOLS REQUIRED

- Safety Glasses
- Pop Rivet Puller
- Socket Set, Metric
- Socket Set, Torx® Bit
- Torque Wrench

ASSEMBLY TIME

Approximately 24 minutes

NOTE

Additional time may be required for optional steps, or to accommodate other installed accessories.

INSTALLATION INSTRUCTIONS

CAUTION

BEFORE STARTING INSTALLATION, always ensure vehicle is on a flat stable surface and is properly secured to avoid accidental tipping or other movement to prevent personal injury and/or damage to equipment. If applicable, turn key to "OFF" position and remove from vehicle.

1. REMOVE EXISTING REAR BUMPER.

- First, remove the screw (C) and reinforcement plate (B) securing the rear snow flap to the bumper (A), then remove the inner rear bumper mounting screw (D) from each side. Retain rear snow flap screw and reinforcement plate. Discard inner rear bumper mounting screw.

NOTE

Snow flap has been partially hidden for illustration purposes.

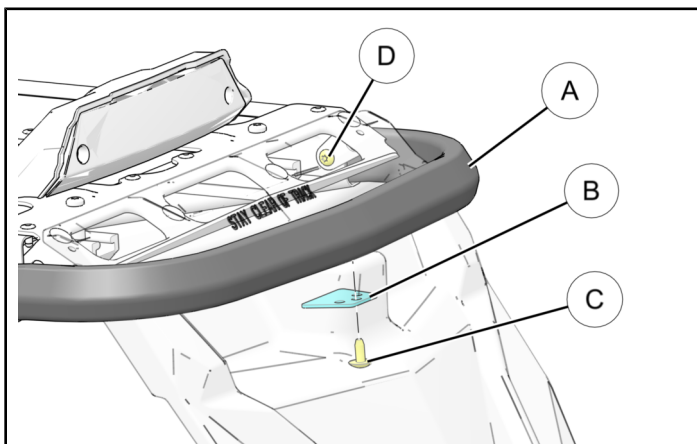

- Next, remove the two forward most bumper mounting screws (E) and locking nuts (F) and remove rear bumper (A).

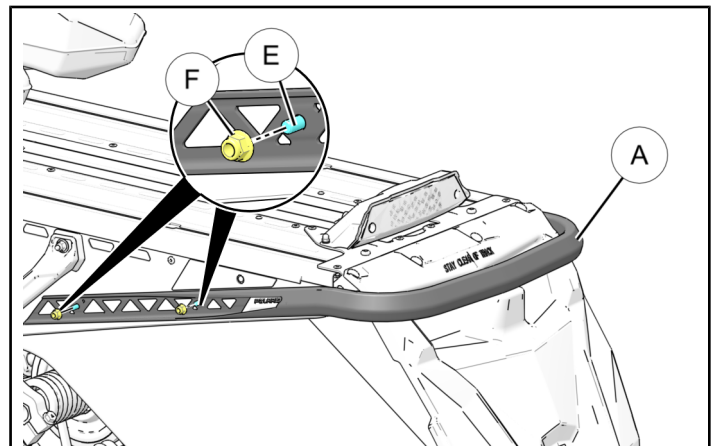

2. INSTALL NEW REAR BUMPER.

- Place new bumper (1) into position as shown being sure the mounting holes line up with existing holes.

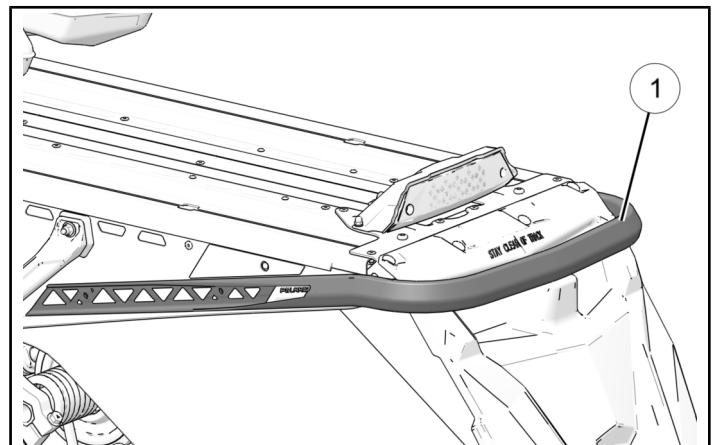

- b. Loosely install the provided screws ③ and locking nuts ④ as shown. DO NOT tighten at this time.

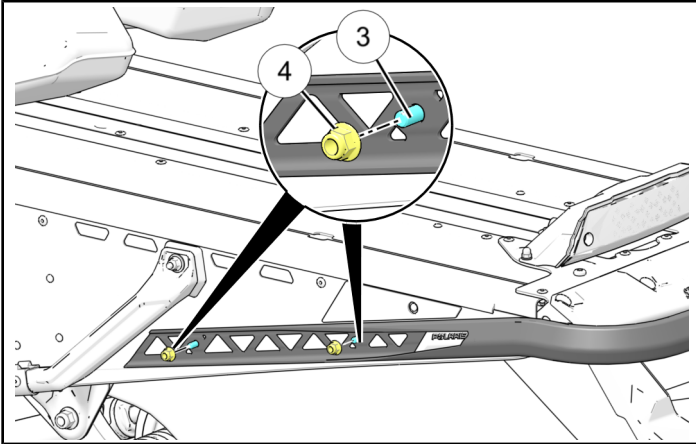

- c. Loosely install supplied inner bumper screws ②. DO NOT tighten at this time.

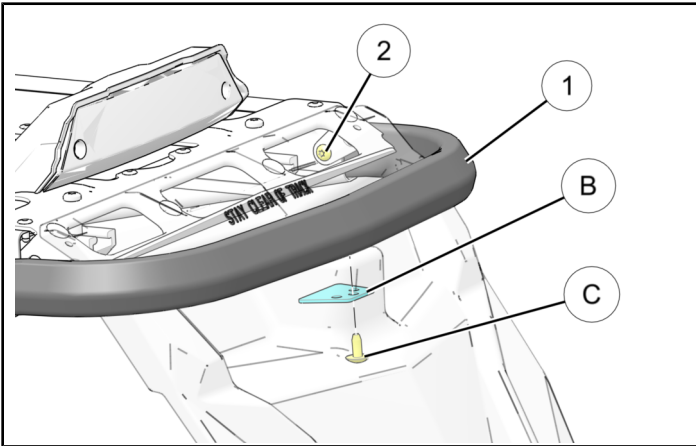

- d. Reinstall reinforcement plate ① and screw ③. Tighten until snug.

3. TORQUE ALL FASTENERS.

- a. Torque all six remaining fasteners to specification provided.

TORQUE

8.5Nm (6 ft. lbs.)

4. VERIFY WORK.

- a. Check to make sure all tools are accounted for and all necessary steps have been completed.

FEEDBACK FORM

A feedback form has been created for the installer to provide any comments, questions or concerns about the installation instructions. The form is viewable on mobile devices by scanning the QR code or by clicking [HERE](#) if viewing on a PC.

FEEDBACK FORM

