

DIESEL SPEED LIMITER KITS



P/N 2884133, 2884134, 2884135

APPLICATION

Verify fitment at www.polaris.com

BEFORE YOU BEGIN

Read these instructions and check to be sure all parts and tools are accounted for. Please retain these installation instructions for future reference and parts ordering information.

KIT CONTENTS

Polaris Diesel 15MPH Kit - PN: 2884133

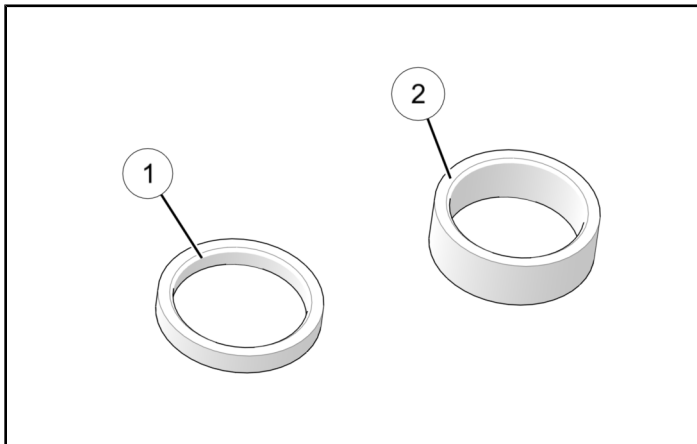

REF	QTY	PART DESCRIPTION	PART NUMBER
1	1	Spacer, Clutch Limiter, .060"	5450265
2	1	Spacer, Clutch Limiter, .520"	5437199

Bobcat Diesel 15MPH Kit - PN: 2884134

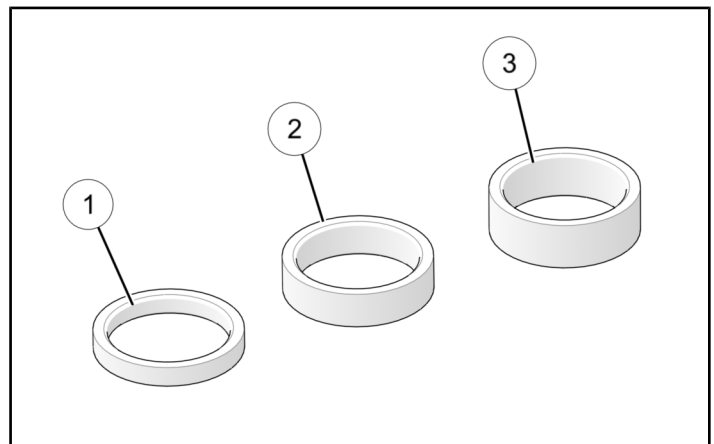

REF	QTY	PART DESCRIPTION	PART NUMBER
1	1	Spacer, Clutch Limiter, .040"	5438963
2	1	Spacer, Clutch Limiter, .200"	5438737
3	1	Spacer, Clutch Limiter, .520"	5437199

Bobcat Diesel 25MPH Kit - PN: 2884135

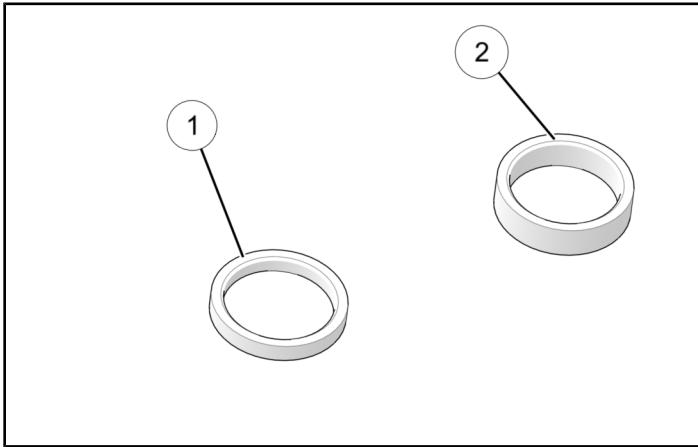

REF	QTY	PART DESCRIPTION	PART NUMBER
1	1	Spacer, Clutch Limiter, .180"	5458964
2	1	Spacer, Clutch Limiter, .200"	5438737

TOOLS REQUIRED

- Safety Glasses
- Socket Set, Metric
- Torque Wrench

CONSUMABLES REQUIRED

- None

IMPORTANT

Your Diesel Speed Limiter Kits is exclusively designed for your vehicle. Please read the installation instructions thoroughly before beginning. Installation is easier if the vehicle is clean and free of debris. For your safety, and to ensure a satisfactory installation, perform all installation steps correctly in the sequence shown.

INSTALLATION INSTRUCTIONS

IMPORTANT

BEFORE STARTING INSTALLATION, always ensure vehicle is on a flat stable surface and is properly secured to avoid accidental tipping or other movement to prevent personal injury and/or damage to equipment.

1. SECURE VEHICLE.

- Shift vehicle transmission into "PARK". Turn key to "OFF" position and remove from vehicle.

CAUTION

Belt and clutches may be hot!
Allow adequate time for belt and clutches to cool
BEFORE performing installation.

2. REMOVE CVT OUTER COVER.

- Remove the nine outer CVT cover bolts (B) and remove outer CVT cover (A).

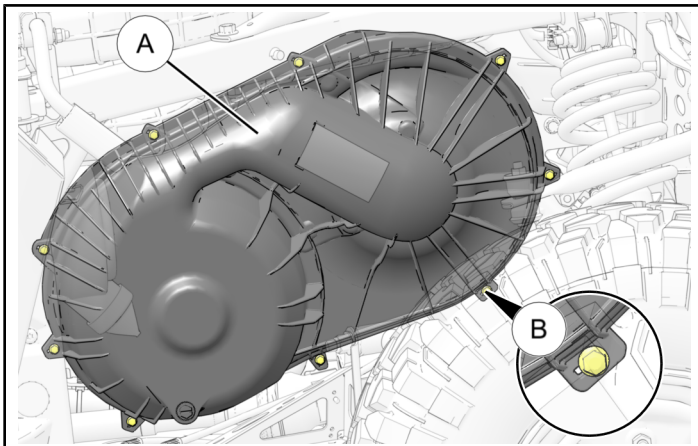

3. REMOVE DRIVE CLUTCH OUTER PLATE.

- Mark the drive clutch cover plate (A) to the moveable sheave (B) using a paint pen or equivalent. This will help ensure proper reassembly.

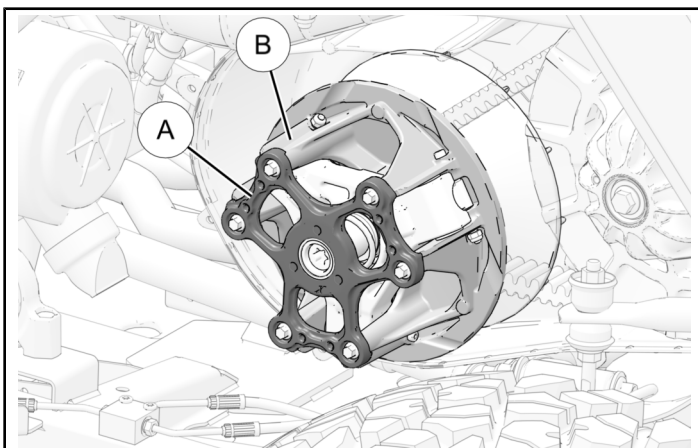

- Remove clutch cover plate (A) by slowly removing all plate bolts (C).

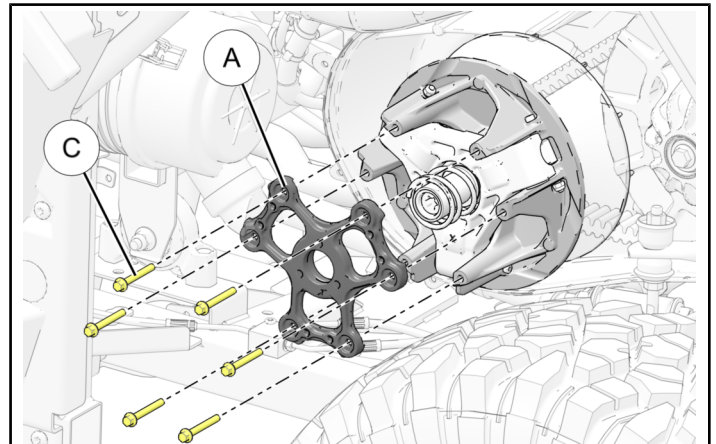

4. REMOVE DRIVE CLUTCH SPRING.

- Remove spring (A) and retain for later use.

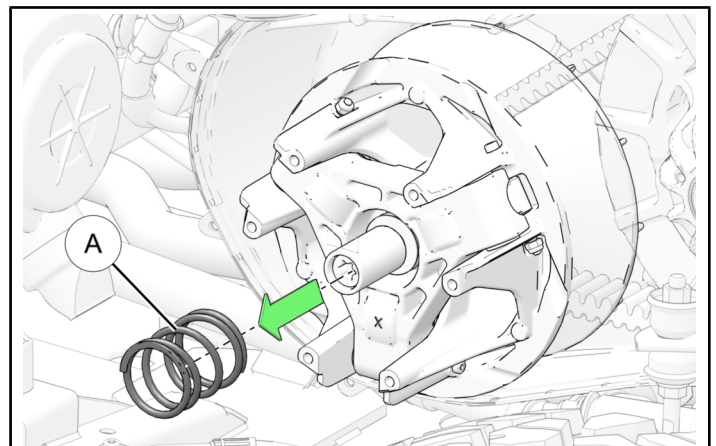

5. REMOVE EXISTING SPACERS.

- Remove any existing spacers (B) that may have been previously installed.

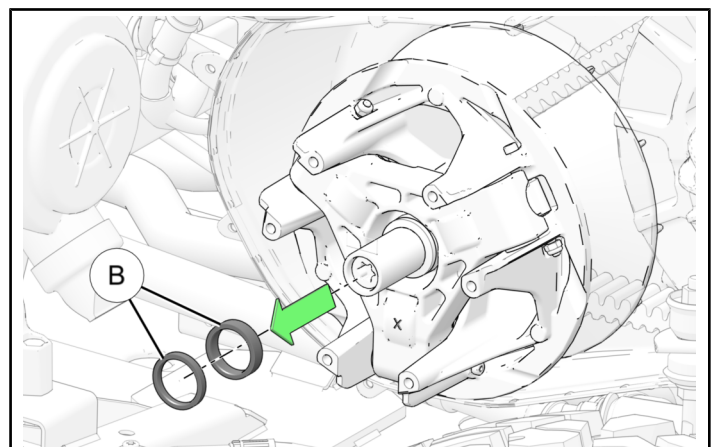

6. INSTALL NEW CLUTCH SPACER/S

KIT PN 2884133

- a. Install both spacers ① and ② onto the shaft as shown.

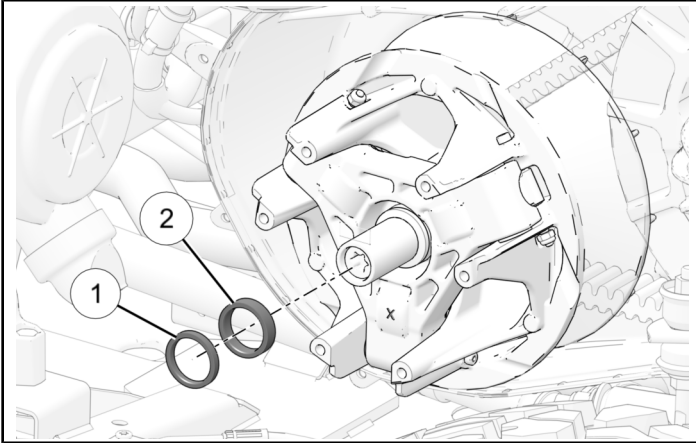

KIT PN 2884134

- a. Install all three spacers ①, ② and ③ onto shaft as shown.

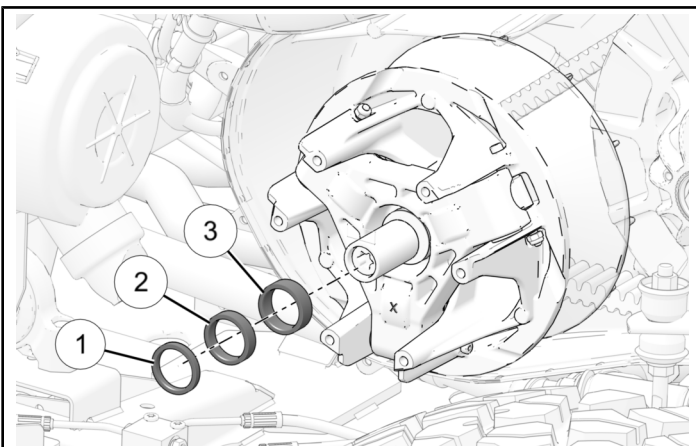

KIT PN 2884135

- a. Install spacer ① and spacer ② onto the shaft as shown.

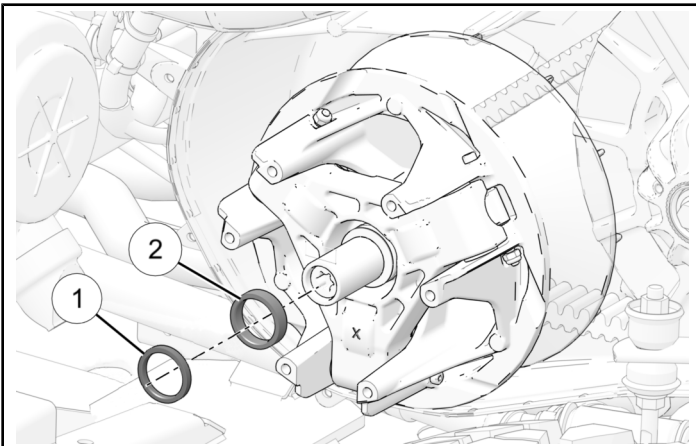

7. REINSTALL DRIVE CLUTCH SPRING[Ⓐ].

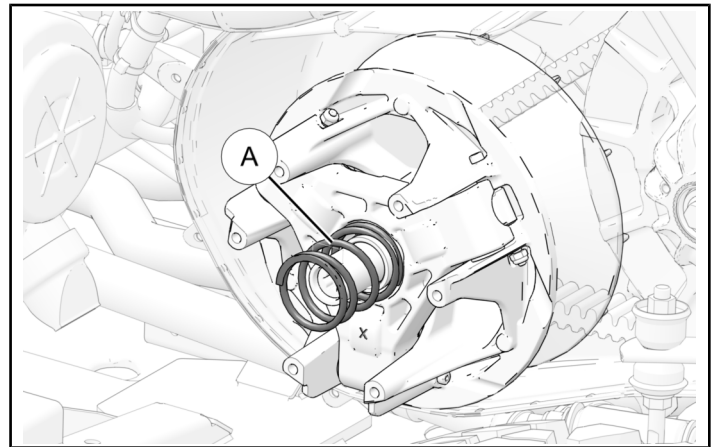

8. REINSTALL DRIVE CLUTCH COVER.

- a. Align the marks previously made on the cover [Ⓐ] with the marks on the moveable sheave.
- b. Install the outer drive clutch cover using previously removed bolts [Ⓑ].

Torque to specification in a crisscross pattern as indicated (T1-T6).

TORQUE

100 ± 10 in. lbs. (11.3 ± 1 Nm)

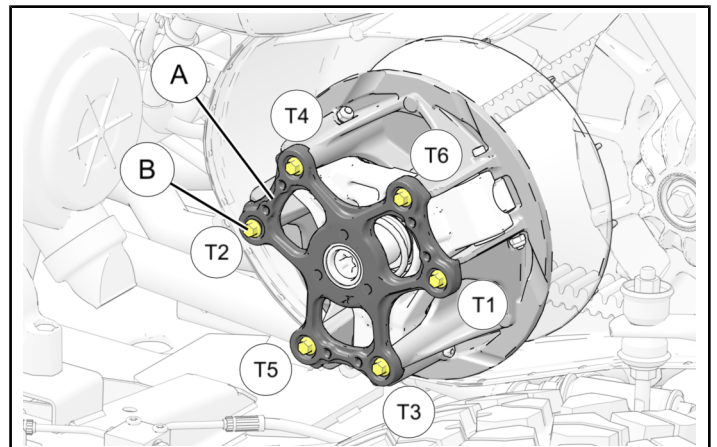

9. REINSTALL CVT OUTER COVER.

- a. Place cover (A) into position and install previously removed cover bolts (B).
- b. Torque cover bolts to specification.

TORQUE

35± 7 in. lbs. (3.95 ± 0.8 Nm)

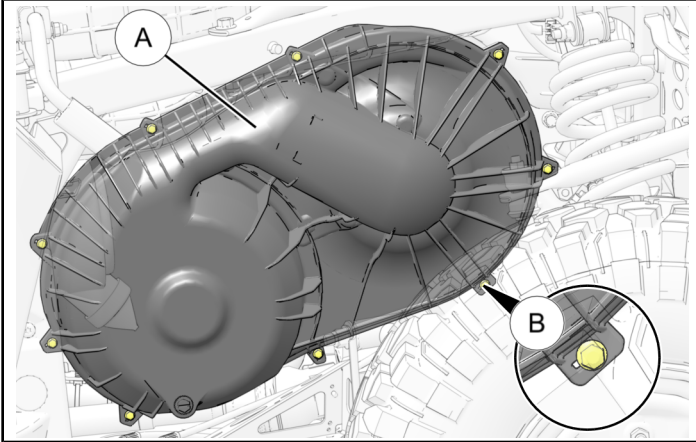

10. VERIFY WORK.

- a. Ensure all tools are accounted for.
- b. Ensure all steps have been completed.

FEEDBACK FORM

A feedback form has been created for the installer to provide any comments, questions or concerns about the installation instructions. The form is viewable on mobile devices by scanning the QR code or by clicking [HERE](#) if viewing on a PC.

