

# REAR BUMPER KIT



**P/N 2882259**

## APPLICATION

Verify accessory fitment at [Polaris.com](http://Polaris.com).

## BEFORE YOU BEGIN

Read these instructions and check to be sure all parts and tools are accounted for. Please retain these installation instructions for future reference and parts ordering information.

## KIT CONTENTS

This Kit includes:

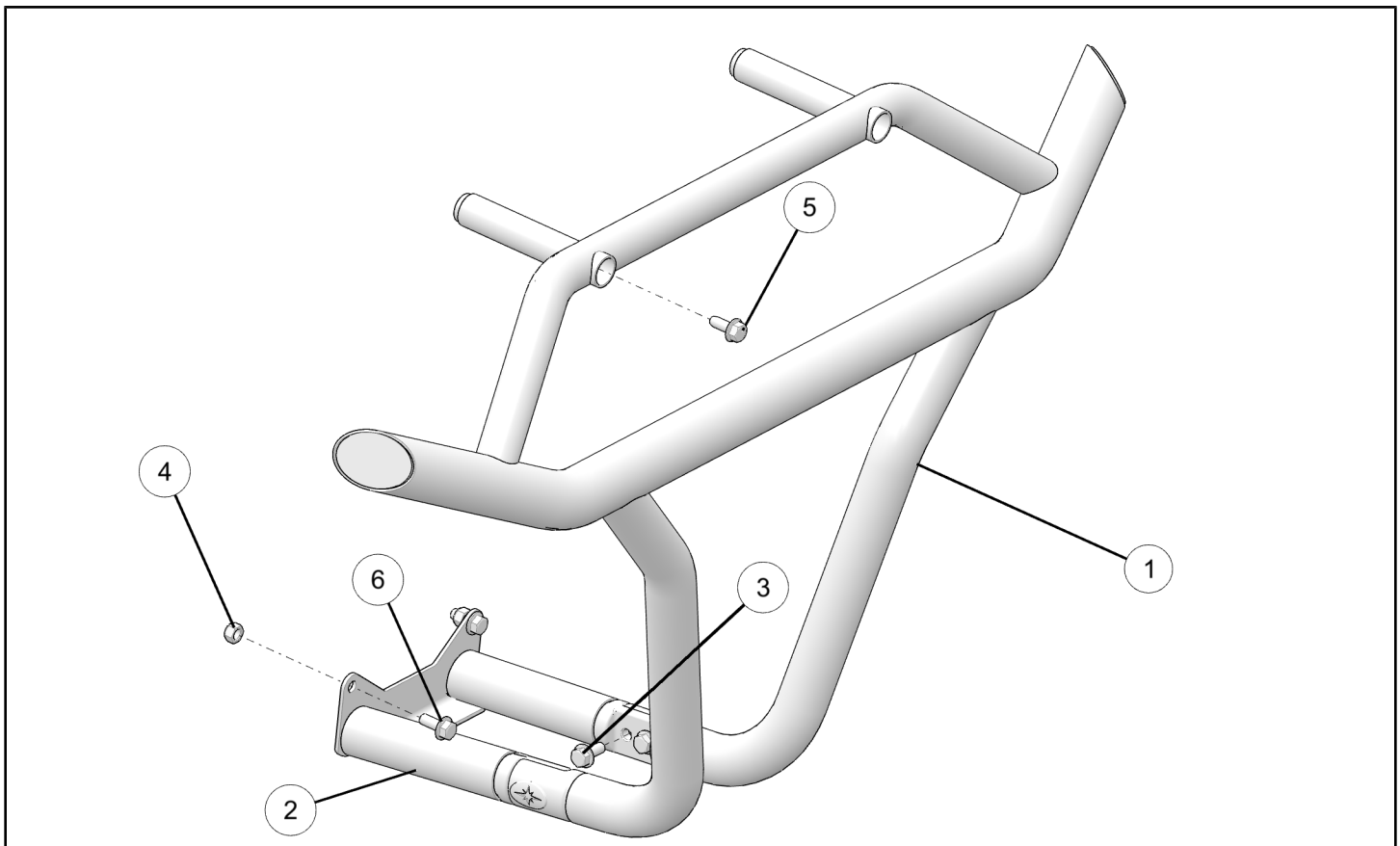

| REF | QTY | PART DESCRIPTION                       | PART NUMBER |
|-----|-----|--|-------------|
| 1   | 1   | Rear Bumper, Upper                     | -           |
| 2   | 1   | Rear Bumper, Lower                     | -           |
| 3*  | 4   | Screw, M8 X 1.25 X 20                  | -           |
| 4*  | 2   | Nut, Hex Flange M8 X 1.25              | -           |
| 5*  | 2   | Hex Flange Selftapping, M8 X 1.25 X 22 | -           |
| 6*  | 2   | Screw. M8 X 1.25 X 25                  | -           |
|     | 1   | Instructions                           | 9927494     |

Items marked (\*) are included in Hardware Kit PN 2206495.

## TOOLS REQUIRED

- Safety Glasses
- 13mm Socket and Ratchet Extension

- 13mm Wrench
- Metric Socket and Ratchet Set

## IMPORTANT

Your REAR BUMPER KIT is exclusively designed for your vehicle. Please read the installation instructions thoroughly before beginning. Installation is easier if the vehicle is clean and free of debris. For your safety, and to ensure a satisfactory installation, perform all installation steps correctly in the sequence shown.

## ASSEMBLY TIME

Approximately 30 minutes

## INSTALLATION INSTRUCTIONS

1. Shift vehicle transmission into "PARK". Turn key to "OFF" position and remove from vehicle.
2. Remove two existing screws (A) and nuts (B) from the exhaust mount (C). Discard the hardware.

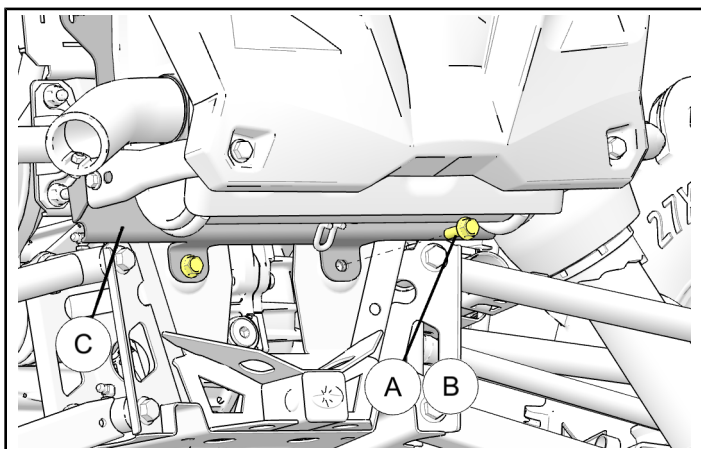

3. Align and install lower rear bumper (2) onto the exhaust mount (C) using two screws (6) and nuts (4) to hold the lower rear bumper (2) in place as shown. Do not tighten hardware at this time.

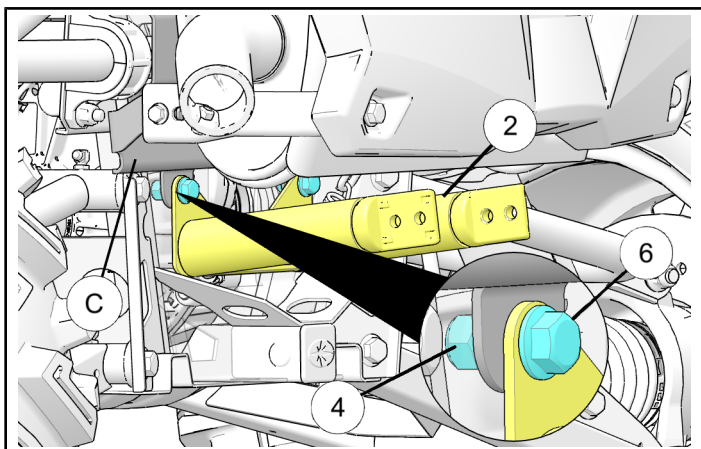

4. Attach upper rear bumper (1) to rear bumper (E) as shown and install two screws (5). Do not tighten screws at this time.

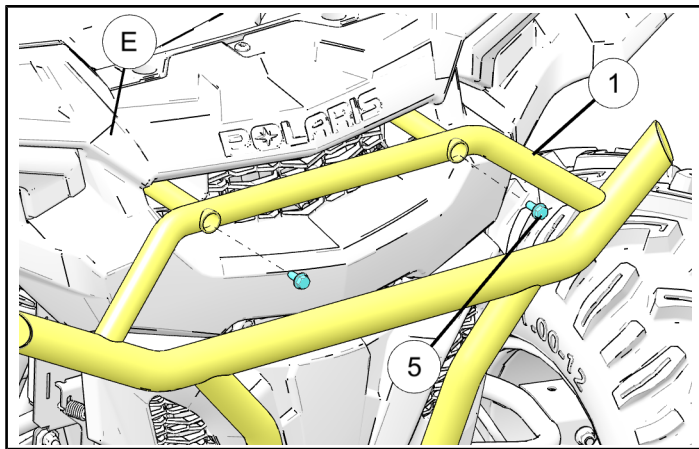

5. Install upper rear bumper (1) onto the lower rear bumper (2) by aligning holes and inserting four screws (3) as shown. Do not tighten screws.

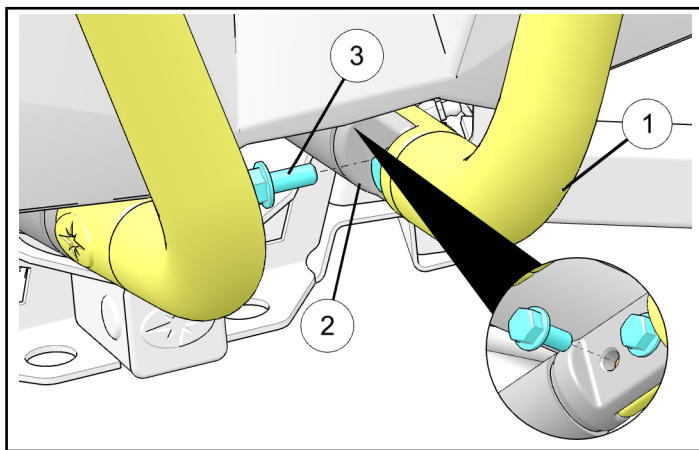

6. Tighten all hardware at this time. Torque upper screws ⑤ initially, followed by lower screws ③ and ⑥ per specification.

#### TORQUE

Screws ⑤ : 4 ft. lbs. (5.4 Nm)

Screws ③ : 14 ft. lbs. (19 Nm)

Screws ⑥ : 14 ft. lbs. (19 Nm)

7. Final rear bumper installation as shown.

