

AVIATOR SEAT KIT



P/N 2883503-XXX

INTERNATIONAL INSTRUCTIONS

DE DEUTSCH

Laden Sie die neuesten PDF-Anweisungen von www.indianmotorcycle.de herunter.

FR FRANÇAIS

Télécharger les dernières instructions en format PDF sur www.indianmotorcycle.fr.

IT ITALIANO

Scarica l'ultima versione delle istruzioni in formato PDF da www.indianmoto.it.

EN ENGLISH

Download the latest PDF instructions from www.indianmotorcycle.com.

ES ESPAÑOL

Descargue las instrucciones más recientes en formato PDF de www.indianmotorcycle.mx / www.indianmotorcycle.es.

ZH 中文

从www.indianmotorcycle.cn 下载最新的PDF说明。

1



2



3



4



APPLICATION

Verify accessory fitment at www.indianmotorcycle.com.

BEFORE YOU BEGIN

Read these instructions and check to be sure all parts and tools are accounted for. Please retain these installation instructions for future reference and parts ordering information.

KIT CONTENTS

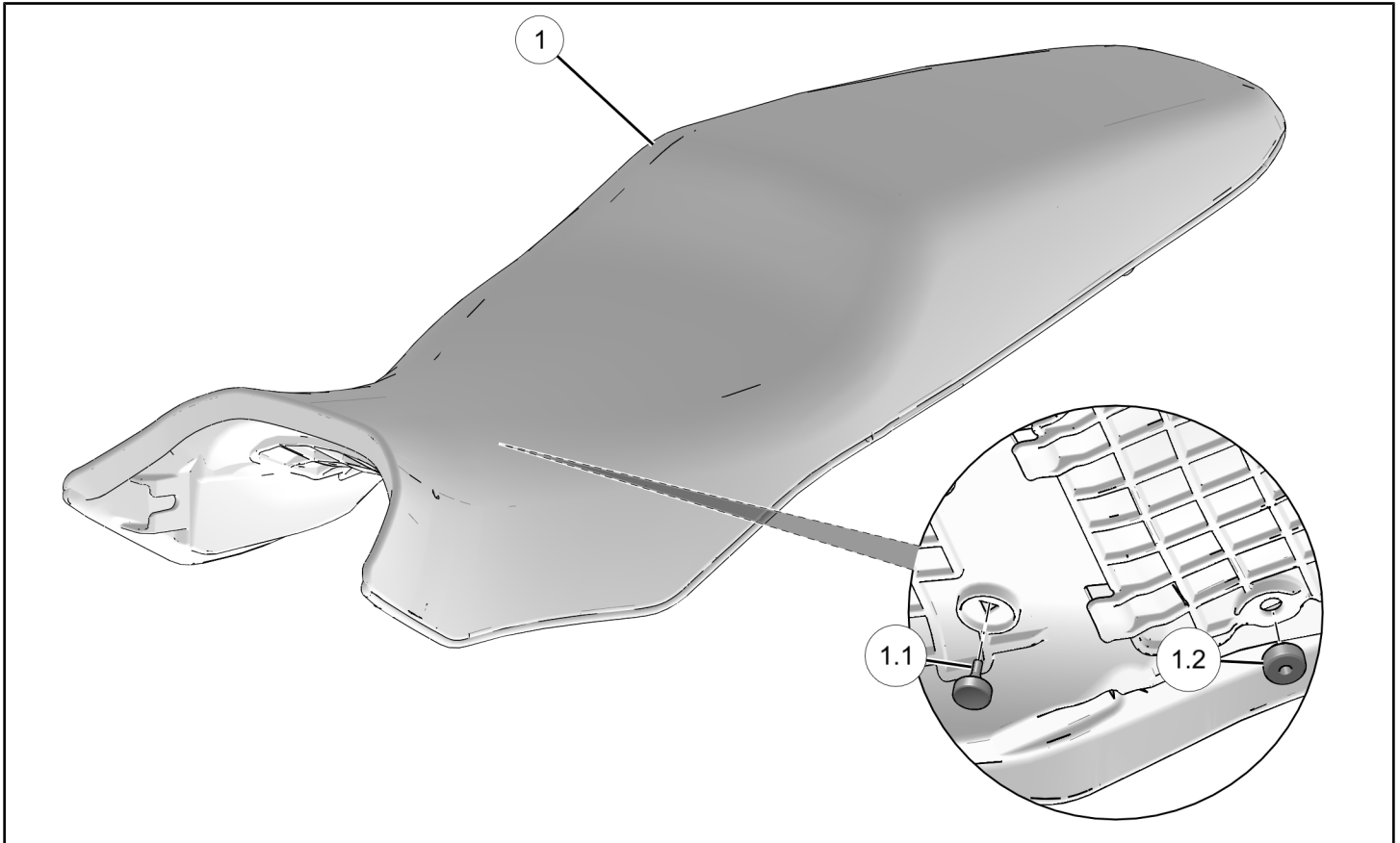

NOTE

XXX = Indian® color code (For example: VNA = Brown)

REF	QTY	PART DESCRIPTION	P/N AVAILABLE SEPARATELY
1	1	Assembly–Seat, Aviator	N/A
1.1	2	- Bumper–6mm	5416652
1.2	4	- Bumper–8mm	5416653
	1	Instructions	9929568

TOOLS REQUIRED

- Safety Glasses
- Socket Set, Torx® Bit
- Socket Set, Hex Bit, Metric
- Torque Wrench

IMPORTANT

Your accessory kit is exclusively designed for your vehicle. Please read the installation instructions thoroughly before beginning. Installation is easier if the vehicle is clean and free of debris. For your safety, and to ensure a satisfactory installation, perform all installation steps correctly in the sequence shown.

INSTALLATION INSTRUCTIONS

VEHICLE PREPARATION

GENERAL

1. Turn key or ignition switch to OFF position and remove key.
2. Ensure motorcycle is parked on a flat surface, kickstand is fully extended, and vehicle is stable prior to installation.

SEAT REMOVAL

1. Remove and retain two handle fasteners (A) to remove passenger handle from each side of motorcycle frame.

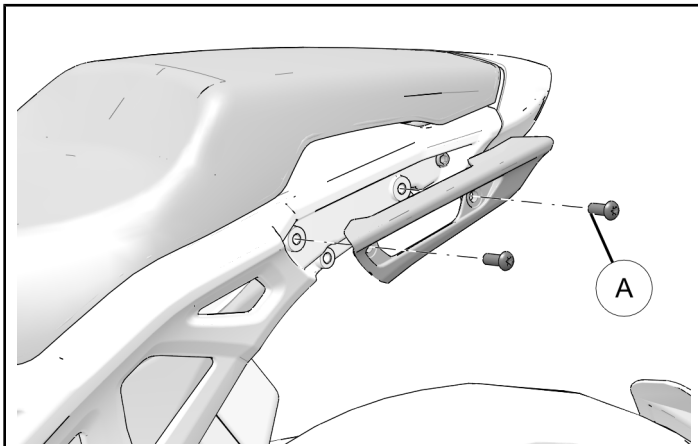

2. Remove and retain one seat fastener (B) from each side of motorcycle frame.

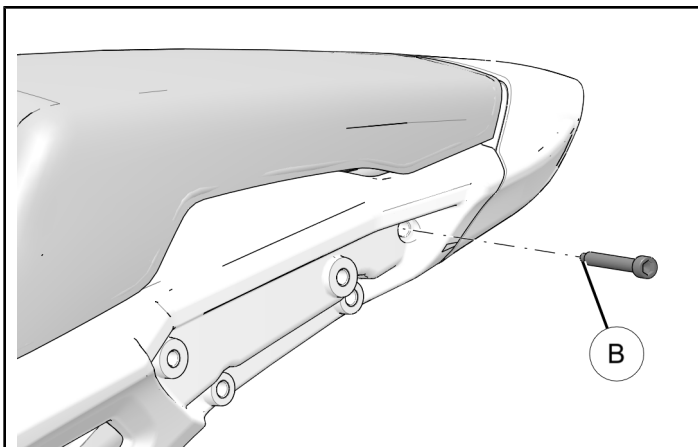

3. Slide seat back-and-up, to ensure seat slides out of mounts, to remove from motorcycle.

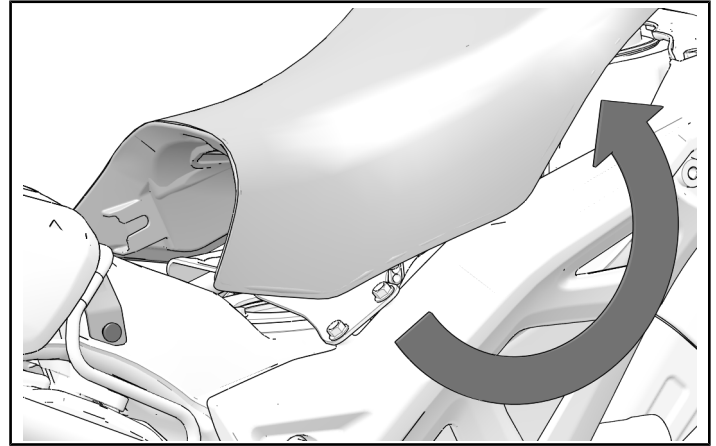

ACCESSORY INSTALLATION

1. Identify two tabs located on underside of aviator seat (1).

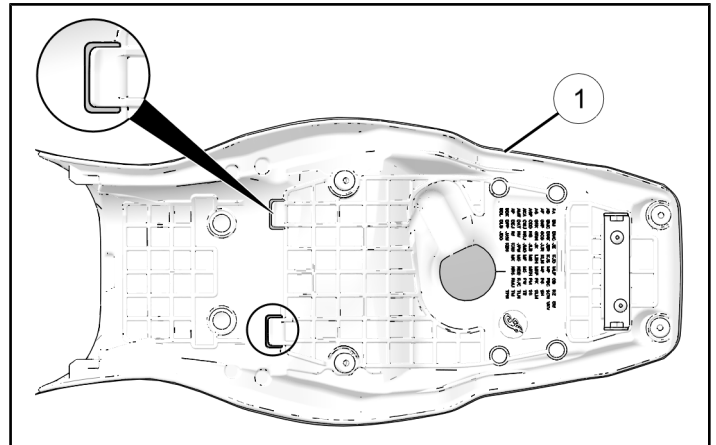

2. Tabs, identified in step 1 of this section, will slide beneath seat support bracket.

TIP

Lift rear of seat to confirm center tabs are engaged.

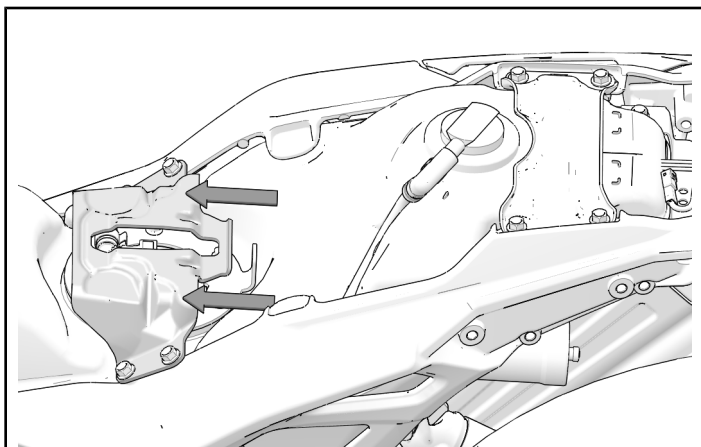

- Slide aviator seat into seat support bracket and into front mounting bracket.

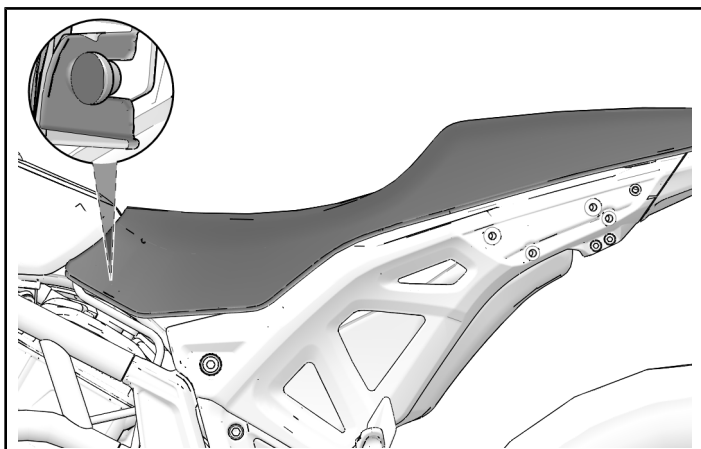

4. Secure rear of aviator seat with two retained screws (B).

TORQUE

Two screws Ⓑ: **84 in. lbs. (9.5 Nm)**

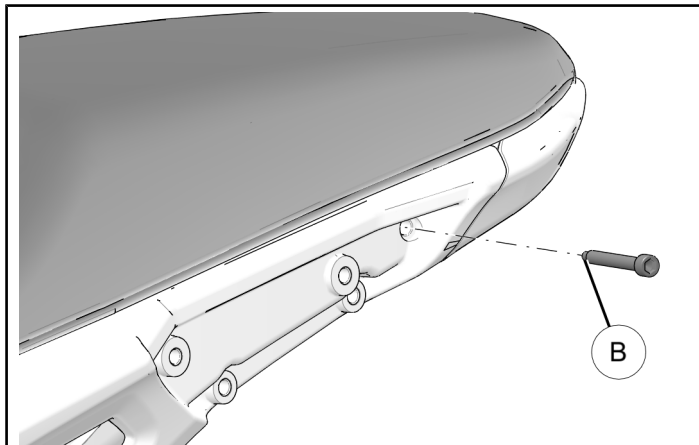

5. Reinstall two passenger handles with two screws
Ⓐ per handle.

TORQUE

Four screws Ⓐ: **19 ft. lbs. (26 Nm)**

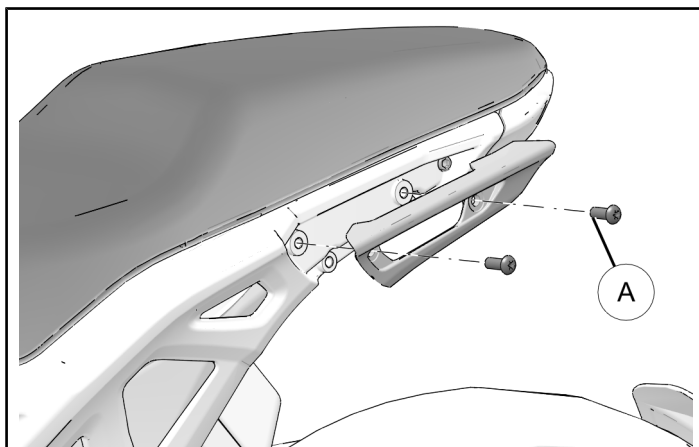

FEEDBACK FORM

A feedback form has been created for the installer to provide any comments, questions or concerns about the installation instructions. The form is viewable on mobile devices by scanning the QR code or by clicking [HERE](#) if viewing on a PC.

