

BACK REST PAD KIT



P/N 2880827

APPLICATION

ALL MY15 INDIAN SCOUT MOTORCYCLES.

⚠ WARNING

This accessory is only approved for use with the models listed. **NEVER** use this accessory on non-approved models. Use of this accessory on models other than those listed in these instructions may negatively affect the stability of the vehicle, lead to loss of control, and result in serious injury or death.

BEFORE YOU BEGIN

Read these instructions and check to be sure all parts and tools are accounted for in package. Please retain these installation instructions for future reference and parts ordering information.

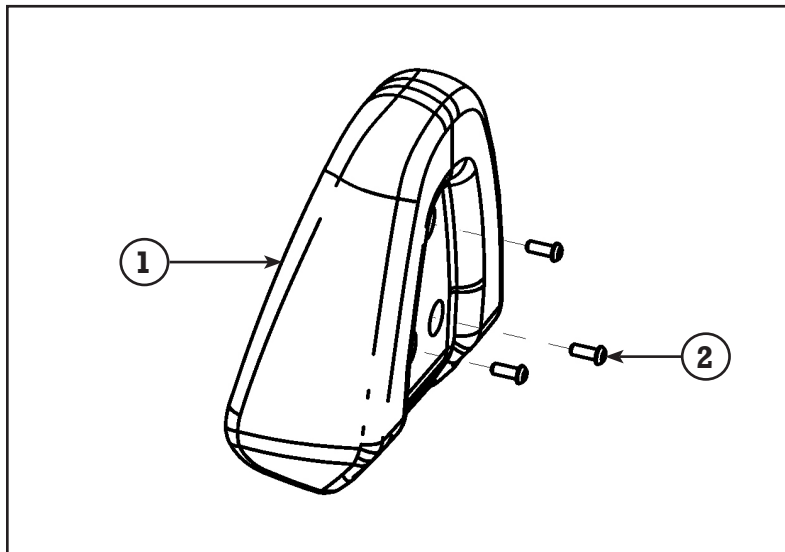

KIT CONTENTS

Ref	Qty	Part Description	Part Number
1	1	Backrest Pad Assembly	2686159
2	3	Screw - M6X16	7519025
	1	Instructions	9925782

TOOLS NEEDED

5 mm Hex Key Socket

Socket Wrench

Torque Wrench

APPROXIMATE ASSEMBLY TIME

6 min

IMPORTANT

Your Indian BACK REST PAD KIT is exclusively designed for your vehicle. Please read the installation instructions thoroughly before beginning. Installation is easier if the vehicle is clean and free of debris. For your safety, and to ensure a satisfactory installation, perform all installation steps correctly in the sequence shown.

INSTALLATION INSTRUCTIONS

1. Install pad (1) on driver backrest (A) or passenger backrest (B) bracket using three M6 screws (2) as shown in Figure 1 and Figure 2.
2. Torque M6 screws to 75 ± 5 in-lbs. (8.47 ± 0.56 Nm).

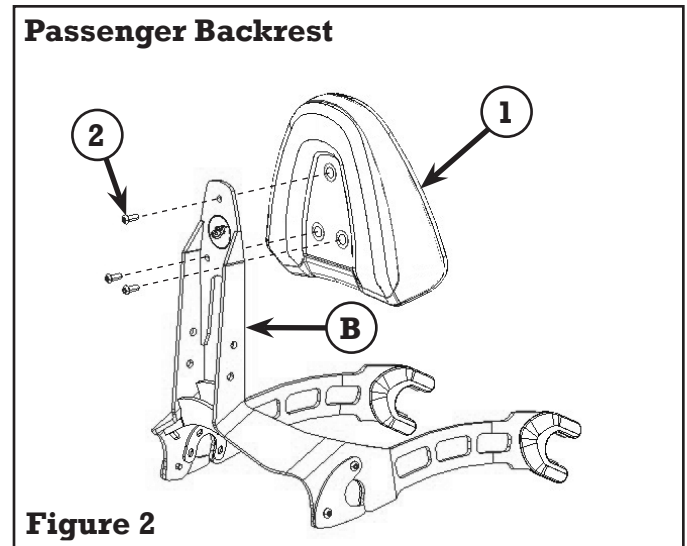
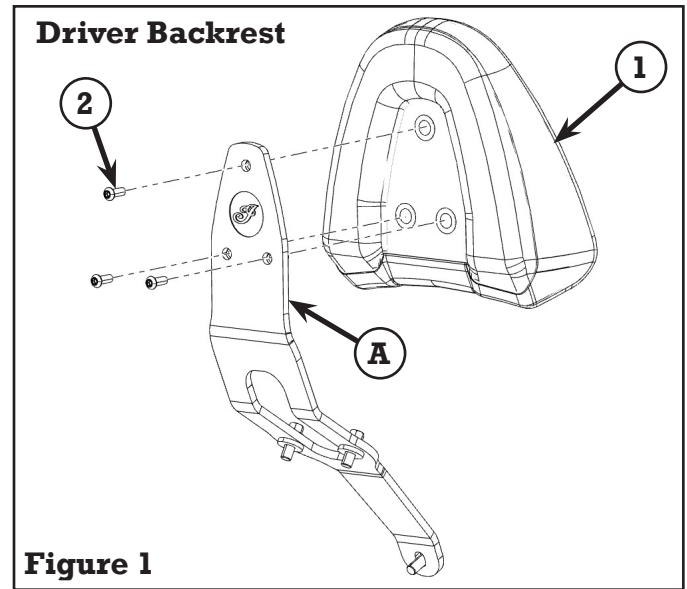

Clean the pad with warm water, mild soap and soft cloth. Let air dry.

NOTE (if equipped): Leather will lose oils and condition with time and exposure to weather. Leather Dressing will add back many of the oils that are lost from exposure to the weather. Apply dressing with a clean dry cloth. Use generously and allow to soak in. Allow to dry overnight. Wipe off excess. Under normal conditions, annual application is sufficient.