

# TIP-OUT GLASS WINDSHIELD

**POLARIS**

ENGINEERED PARTS  
ACCESSORIES & APPAREL

**P/N 2882874**

## APPLICATION

Verify accessory fitment at [Polaris.com](https://polaris.com).

## BEFORE YOU BEGIN

Read these instructions and check to be sure all parts and tools are accounted for. Please retain these installation instructions for future reference and parts ordering information.

## KIT CONTENTS

This Kit includes:

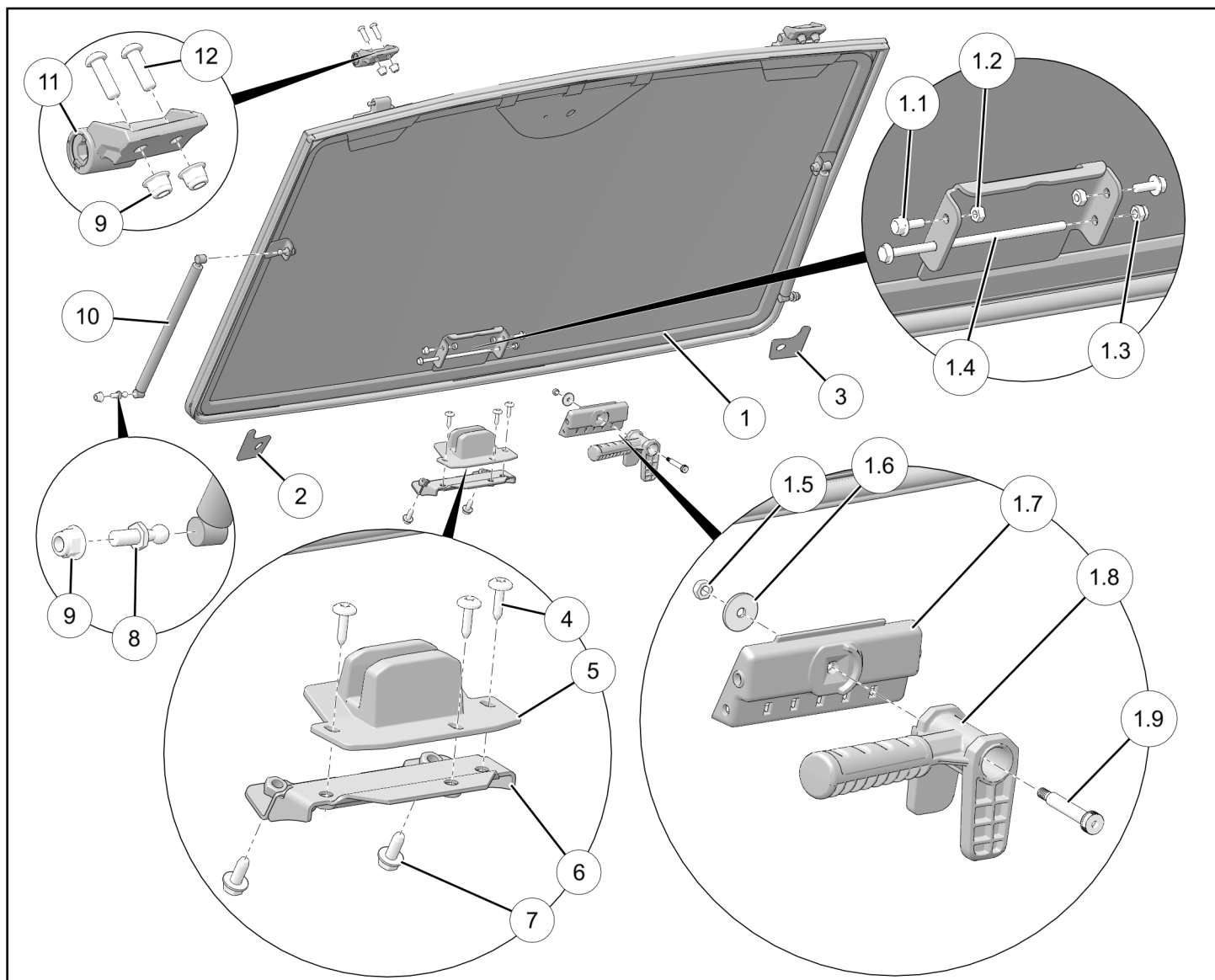

REF	QTY	PART DESCRIPTION	PART NUMBER	INCLUDED IN HARDWARE KIT
1	1	Windshield, Tip-Out Glass (includes items 1.1–1.9)	2636972	-
1.1	2	- Screw, Hex Flange, with Locking Patch - M6 X 1.0 X 16	7519236	-
1.2	2	- Nut, Hex - M6 X 1.0	7546701	-
1.3	1	- Nut, Hex, Locking - M6 X 1.0	7546704	-
1.4	1	- Screw, Hex Flange - M6 X 1.0 X 145	7516816	-
1.5	1	- Nut, Hex - M6 X 1.0	7547120	2207450
1.6	1	- Washer - 6 X 23 X 2.0	-	2207450
1.7	1	- Receiver, Handle	5454736	2207450
1.8	1	- Handle	5454735	2207450
1.9	1	- Screw, Pivot - M6	-	2207450
2	1	Seal, Adhesive, LH	5814712	-
3	1	Seal, Adhesive, RH	5814713	-
4	3	Screw, Torx® Truss Head - M6 X 1.0 X 25	7519650	-
5	1	Base, Handle	5454734	-
6	1	Bracket, Backer, Handle Base	5265266	-
7	2	Screw, Hex Flange - M8 X 1.25 X 20	7518555	-
8	4	Fitting, Ball End	7081839	2207158
9	8	Nut, Hex Flange, Locking - M8 X 1.25	7547454	2207158 (Qty 4) 2207159 (Qty 4)
10	2	Shock, Gas	7043889	2207158
11	1 1	Hinge, Vehicle Side, LH Hinge, Vehicle Side, RH	5633878 5633879	2207159 2207159
12	4	Screw, Torx® Button Head - M8 X 1.25 X 25	7519747	2207159
	1	Instructions	9928341	-

## TOOLS REQUIRED

- Safety Glasses
- Drill
- Drill Bit: 9/32 inch (7 mm)
- Hex Key Set, Metric
- Pliers, Push Pin Rivet
- Screwdriver Set, Torx®
- Socket Set, Metric
- Wrench Set, Metric

## IMPORTANT

Your Tip-Out Glass Windshield is exclusively designed for your vehicle. Please read the installation instructions thoroughly before beginning. Installation is easier if the vehicle is clean and free of debris. For your safety, and to ensure a satisfactory installation, perform all installation steps correctly in the sequence shown.

## INSTALLATION INSTRUCTIONS

### NOTE

Polaris recommends two people install this kit.

1. Shift vehicle transmission into "PARK". Turn ignition switch to "OFF" position and remove key.
2. Install ball fitting ⑧ to lower end of LH ROPS A-pillar using nut ⑨. Ensure proper orientation; ball should be inboard. Tighten nut. Repeat for RH side (ball inboard).

### TIP

Temporarily block gap between ROPS fitting and upper dash with clean cloth or tape to prevent nut from accidentally falling behind dash.

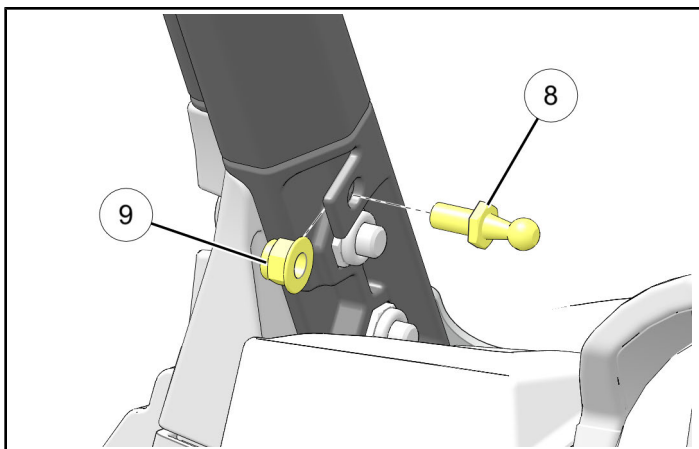

3. Install LH vehicle-side hinge ⑪ to ROPS visor using two each screws ⑫ and nuts ⑨. Do not tighten nuts at this time.

### NOTE

If roof is installed, slightly lift (and block, if desired) front LH/RH corners of roof away from ROPS visor to permit adequate clearance to install hinge screws. Polaris suggests leaving roof installed. If removed, reinstallation over hinges will be difficult and may result in damage to equipment or personal injury.

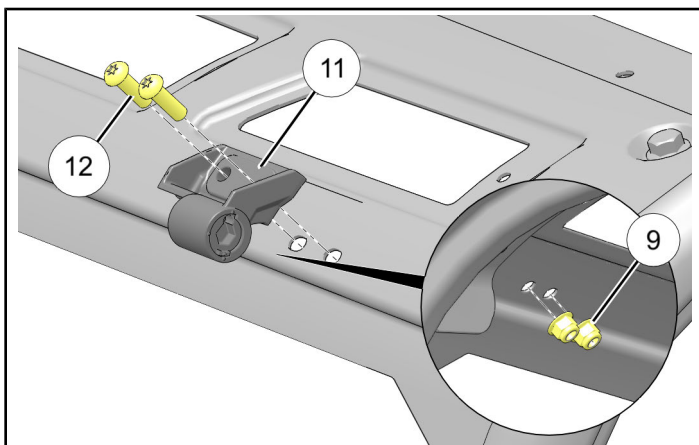

4. Using two people, lift windshield ① into position, sliding pin on LH windshield-side hinge ⑩ into bushing on vehicle-side hinge ⑪.

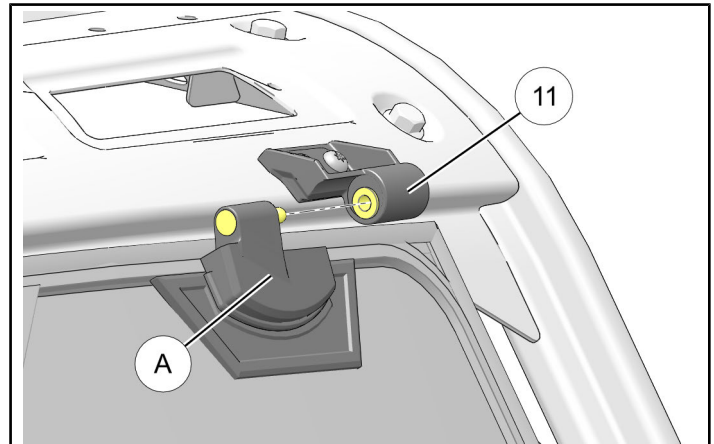

5. Assemble RH vehicle-side hinge ⑪ to windshield-side hinge ⑩ by sliding pin into bushing.

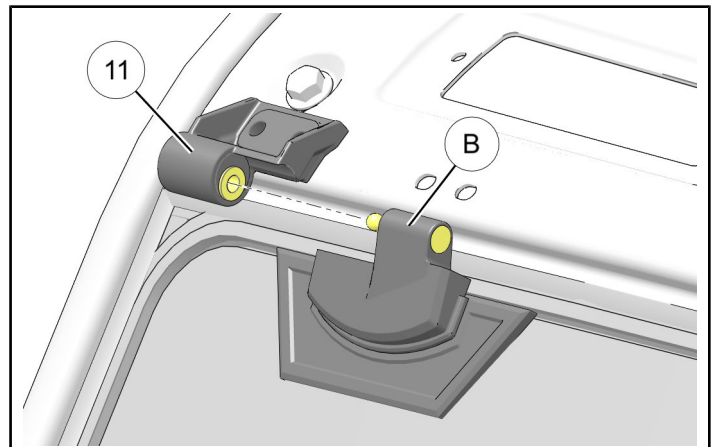

6. Install RH vehicle-side hinge ⑪ to ROPS visor using two each screws ⑫ and nuts ⑨. Tighten all four (LH and RH) hinge nuts.

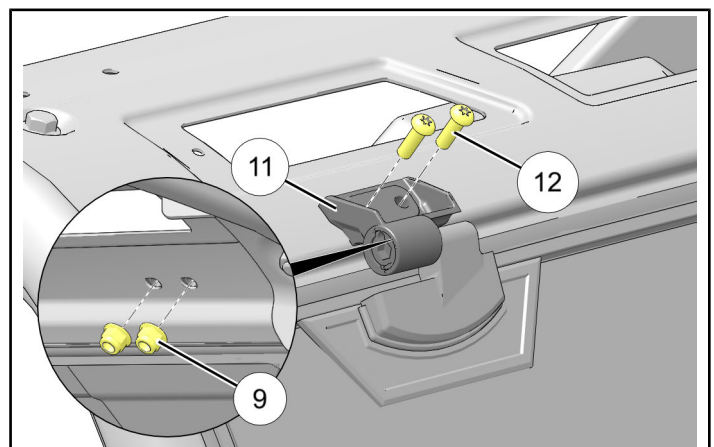

7. Center windshield in ROPS as follows:

- a. Loosen set screw ③ in both LH and RH hinges.

**NOTE**

LH side shown; RH side opposite.

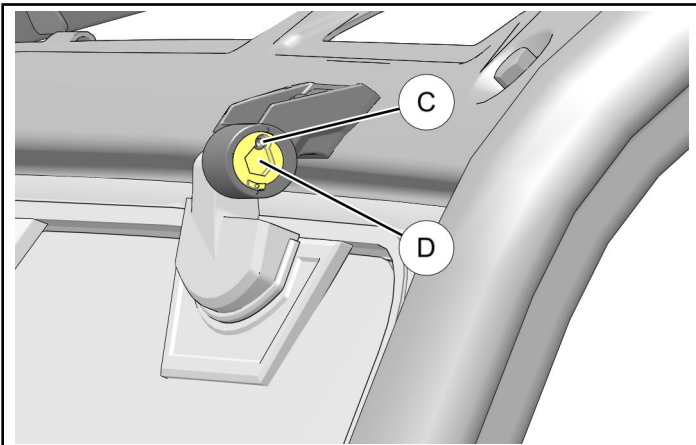

- b. Rotate hinge pin eccentric cam ④ either direction as required. Repeat for opposite side hinge.

**NOTE**

Full cam adjustment range is achieved in 360 degrees of rotation.

- c. Tighten set screw ③ in both LH and RH hinges. Do NOT overtighten.
8. Hold shock ⑩ with cylinder (larger diameter) up and rod (smaller diameter) down, then install lower end of shock to ball fitting ⑧ by firmly pushing shock into fitting. Retention clip will snap into place when shock is fully seated. Repeat for RH side.

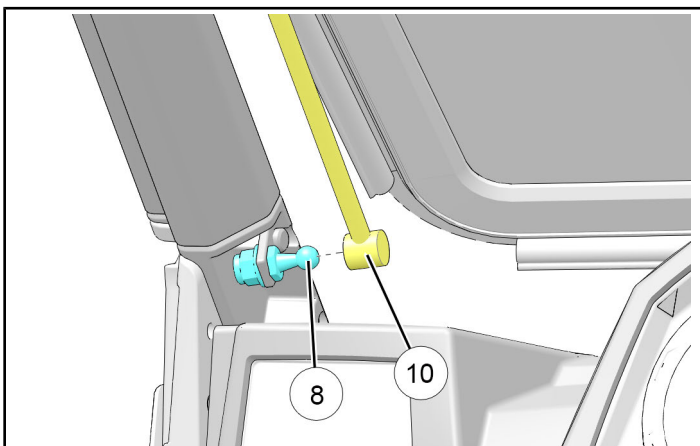

**⚠ WARNING**

In next step ensure safety glasses are worn to prevent eye injury!

9. OPTIONAL: If necessary to remove shock from ball fitting, insert flat bladed screwdriver into slot beneath retention clip ⑤. Twist slightly to disengage clip ends from ball fitting while gently pulling shock away.

**IMPORTANT**

Do NOT remove clip. Lift clip only enough to disengage clip ends from ball fitting.

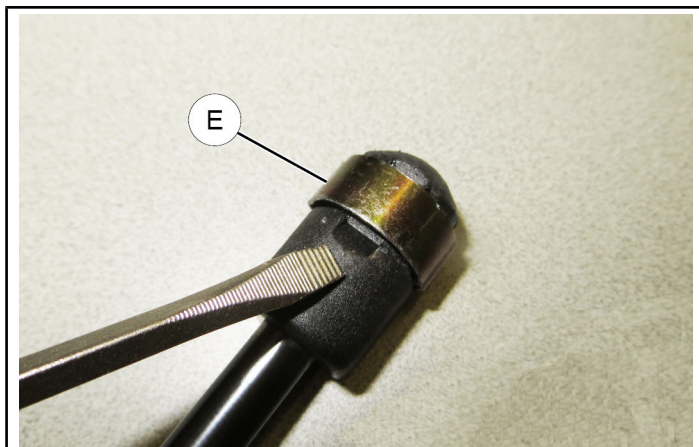

10. Open windshield and install upper end of shock ⑩ to ball fitting ⑧ by firmly pushing shock into fitting. Retention clip will snap into place when shock is fully seated. Repeat for RH side.

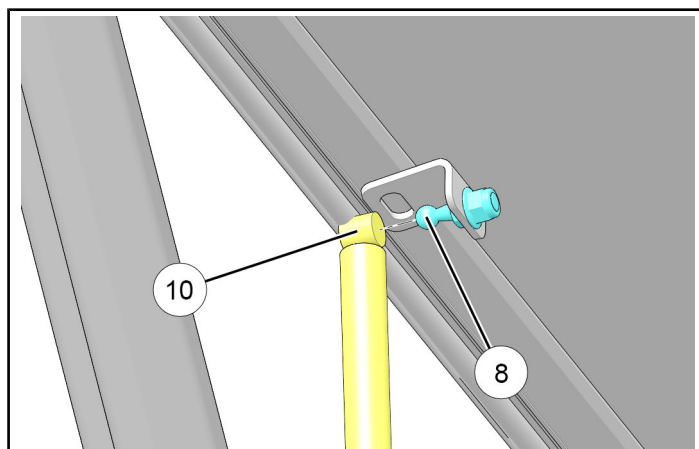



11. Remove upper dash cupholder by removing two push pin rivets (F), then sliding cupholder rearward. Retain rivets.

**NOTE**

If RIDE COMMAND™ is installed, then label (as needed) and disconnect any associated harnesses.

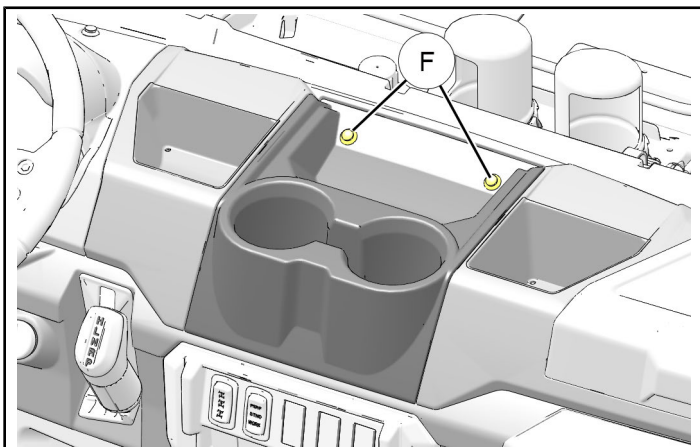

12. Install backer bracket (6) to lower leg of front dash support channel (6) using two screws (7). Center bracket in screw slots, then tighten screws.

**NOTE**

Upper dash hidden for clarity in first image.

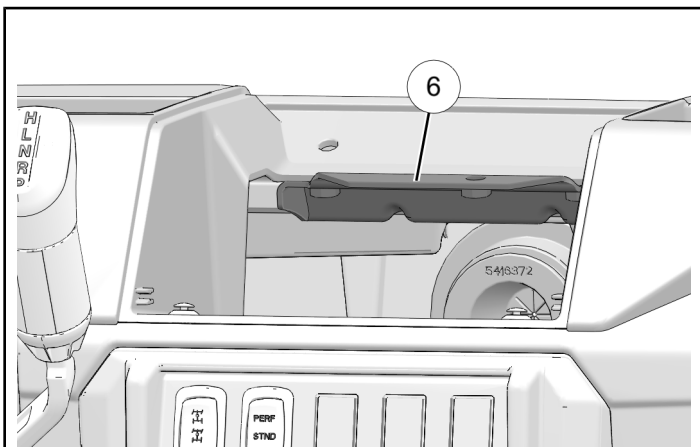
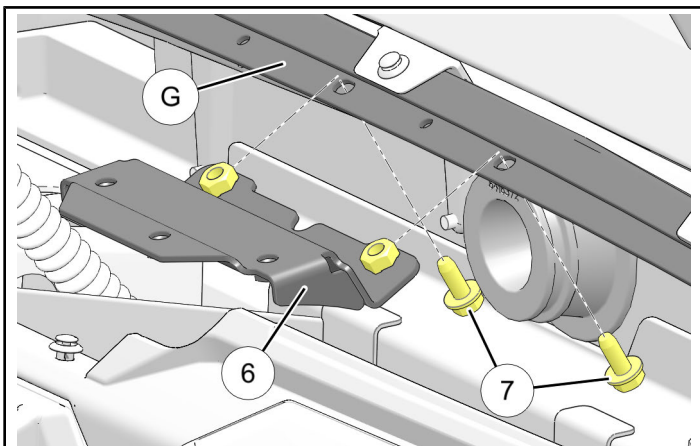

13. Position handle base (5) in upper dash cupholder so base nests into cupholder where angled surfaces meet at (H). Center handle base left to right in cupholder, then mark three holes (J) in centers of slots.

**NOTE**

Cupholder shown; RIDE COMMAND™ similar.

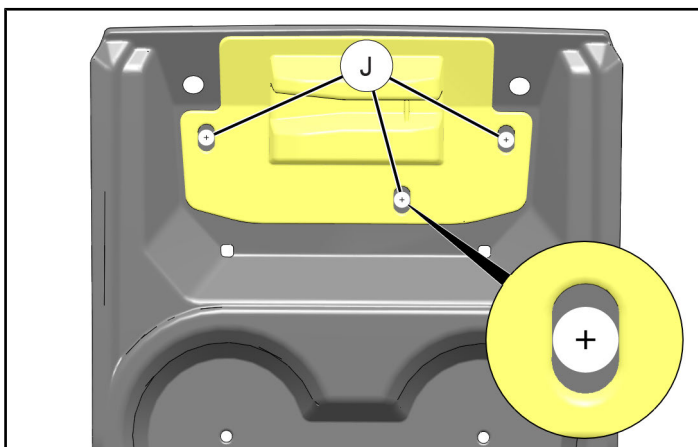
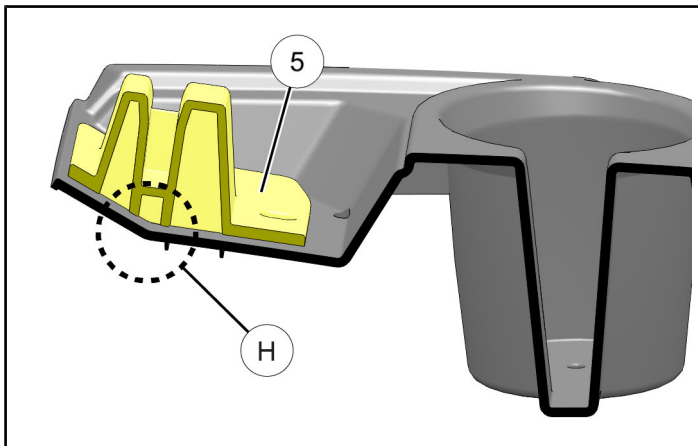

14. Drill 9/32 inch (7 mm) holes through cupholder at marked locations (J).

15. Reinstall cupholder using two retained push pin rivets (F), then install handle base (5) using three screws (4) through cupholder into backer bracket (6).

**NOTE**

If RIDE COMMAND™ is reinstalled, then also reconnect any harnesses previously disconnected in Step 11.

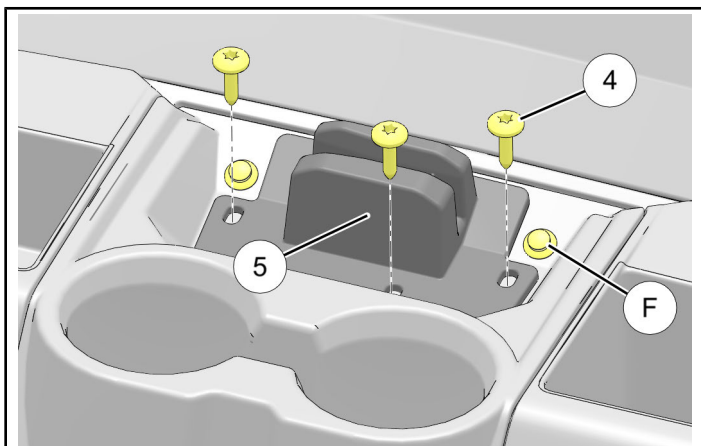

16. Clean installation surface for LH seal (2) as required. Peel off adhesive backing, center seal over existing push pin rivet, then press firmly into place.

Repeat for RH side using seal (3).

**NOTE**

LH side shown; RH side opposite.

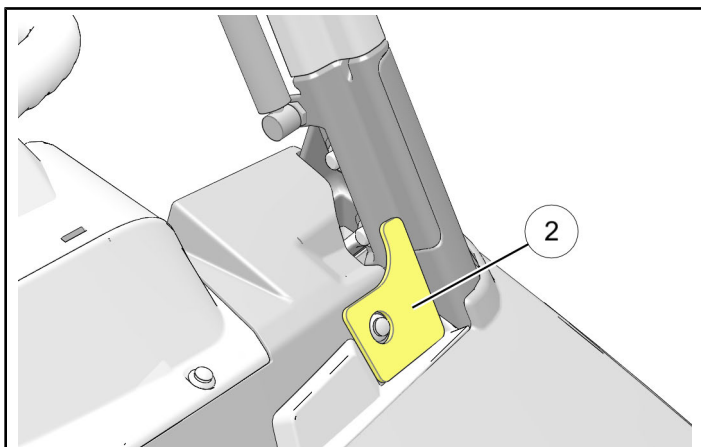

17. Close windshield and lock handle into base (5). Ensure windshield seal is adequately compressed and windshield opens/closes properly. Adjust as required.

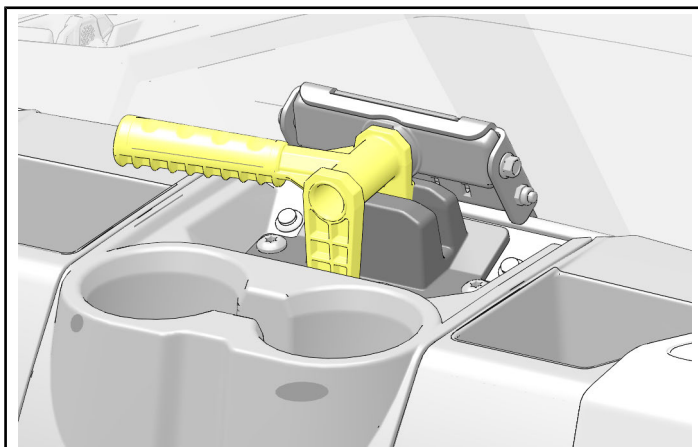

**⚠ WARNING**

If transporting vehicle in non-enclosed trailer then vehicle must FACE FORWARD, and windshield must be FULLY CLOSED and LOCKED. Otherwise, windshield must be removed.

Failure to comply may allow airflow, vibration, or other factors to separate windshield from vehicle and cause an accident, resulting in serious personal injury or death.

## FEEDBACK FORM

A feedback form has been created for the installer to provide any comments, questions or concerns about the installation instructions. The form is viewable on mobile devices by scanning the QR code or by clicking [HERE](#) if viewing on a PC.

### FEEDBACK FORM

