

Contents

Select Language ▼

Powered by Google Translate

Rear Glass Liftgate Kit

P/N 2884413

Before You Begin

Before beginning assembly, inspect the kit and its component(s) to be sure all parts and tools are accounted for and not damaged. If missing parts or parts are damaged, please contact your Selling Dealer for assistance.

If your accessory was purchased online, please contact POLARIS customer service at **1-800-POLARIS** (US & Canada only).

Application

Verify accessory fitment at www.polaris.com.

Kit Contents

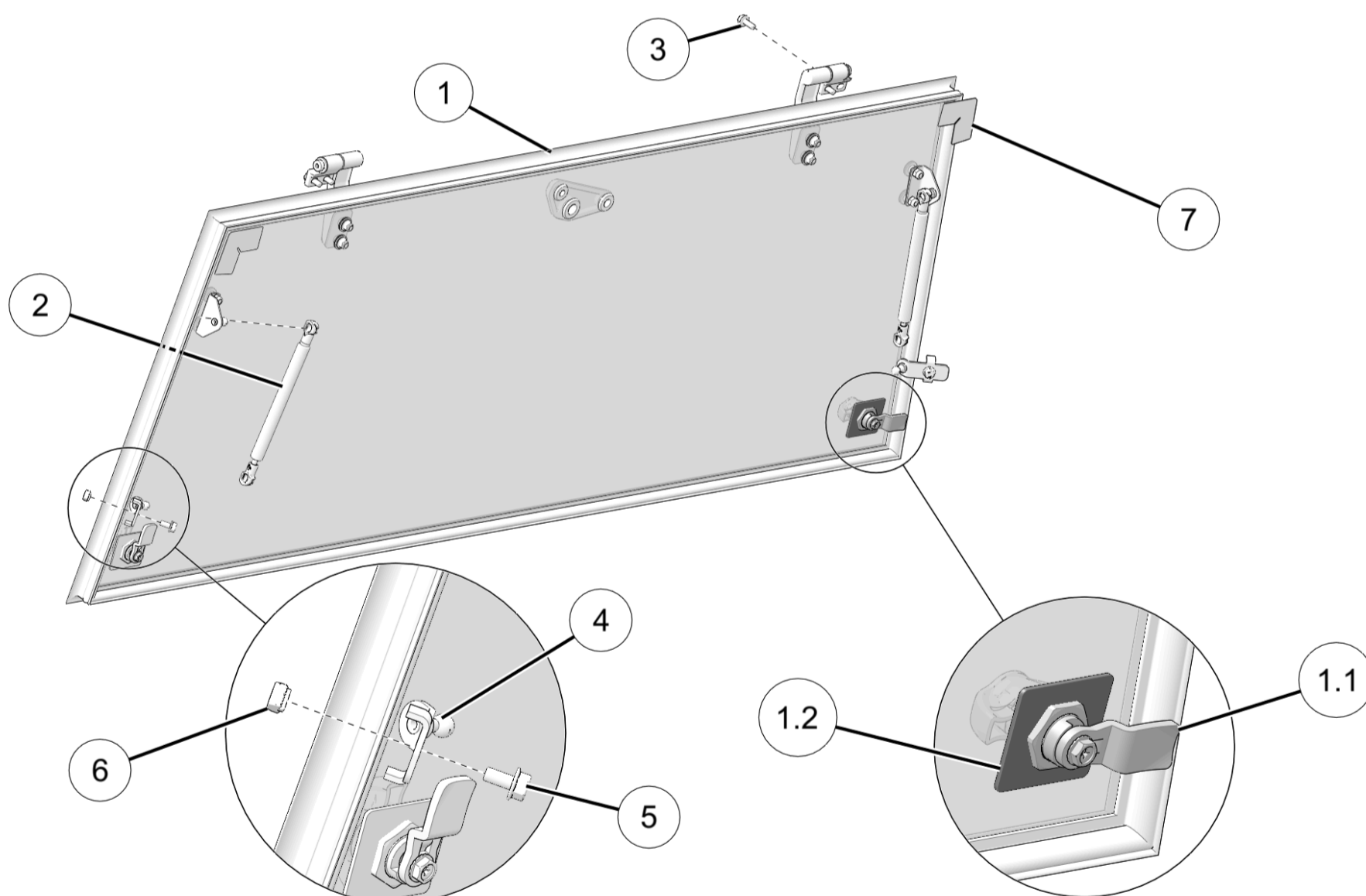

Ref	Qty	Part Description	P/N Available Separately	Available Service Kit
1	1	Liftgate Assembly	2637900	n/a
1.1	2	- T-Handle, Cam, Latch	7082621	2209683
1.2	2	- Bracket, Liftgate Backing	n/a	2209683
2	2	Gas Shock	7045464	2209682
3	4	Screw, Hex Flange Head (M6 x 1.0 x 16 mm)	7521331-16	2209681
4	2	Ball Stud, Liftgate	n/a	n/a
5	2	Screw, Hex Flange Head (M6 x 1.0 x 12 mm)	7521331-12	2209681

Ref	Qty	Part Description	P/N Available Separately	Available Service Kit
6	2	T-Nut	n/a	2209681
7	2	Seal	5526562	n/a

Tools Required

- Safety Glasses
- Socket Set, Metric
- Socket Set, Torx® Bit
- Tape Measure
- Torque Wrench
- Wrench Set, Metric

Consumables Required

- Isopropyl Alcohol (IPA)

Important

Your Rear Glass Liftgate Kit is exclusively designed for your vehicle. Please read the installation instructions thoroughly before beginning. Installation is easier if the vehicle is clean and free of debris. For your safety, and to ensure a satisfactory installation, perform all installation steps correctly in the sequence shown.

Installation Instructions

Vehicle Preparation

General

1. Park vehicle on a flat surface.
2. Shift vehicle into PARK.
3. Turn key to OFF position and remove key.

Accessory Installation

Seal Installation

NOTICE

Right side shown; left side similar.

1. Clean upper corners of rear liftgate area with isopropyl alcohol. Clean 2.5 in (64 mm) on each side of corner. Allow area to dry completely.

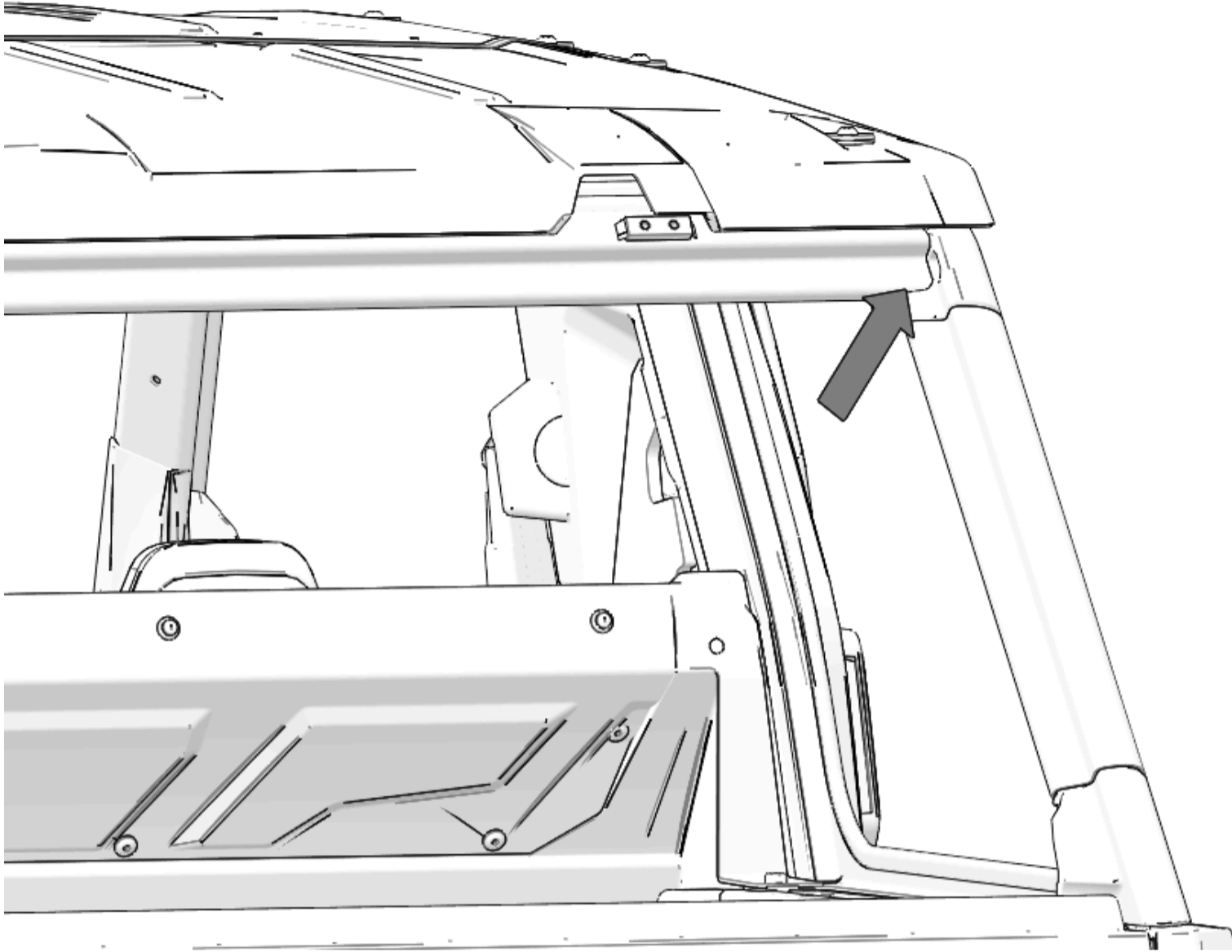

2. Remove backing from seal ⑦. Apply seal to corner area.

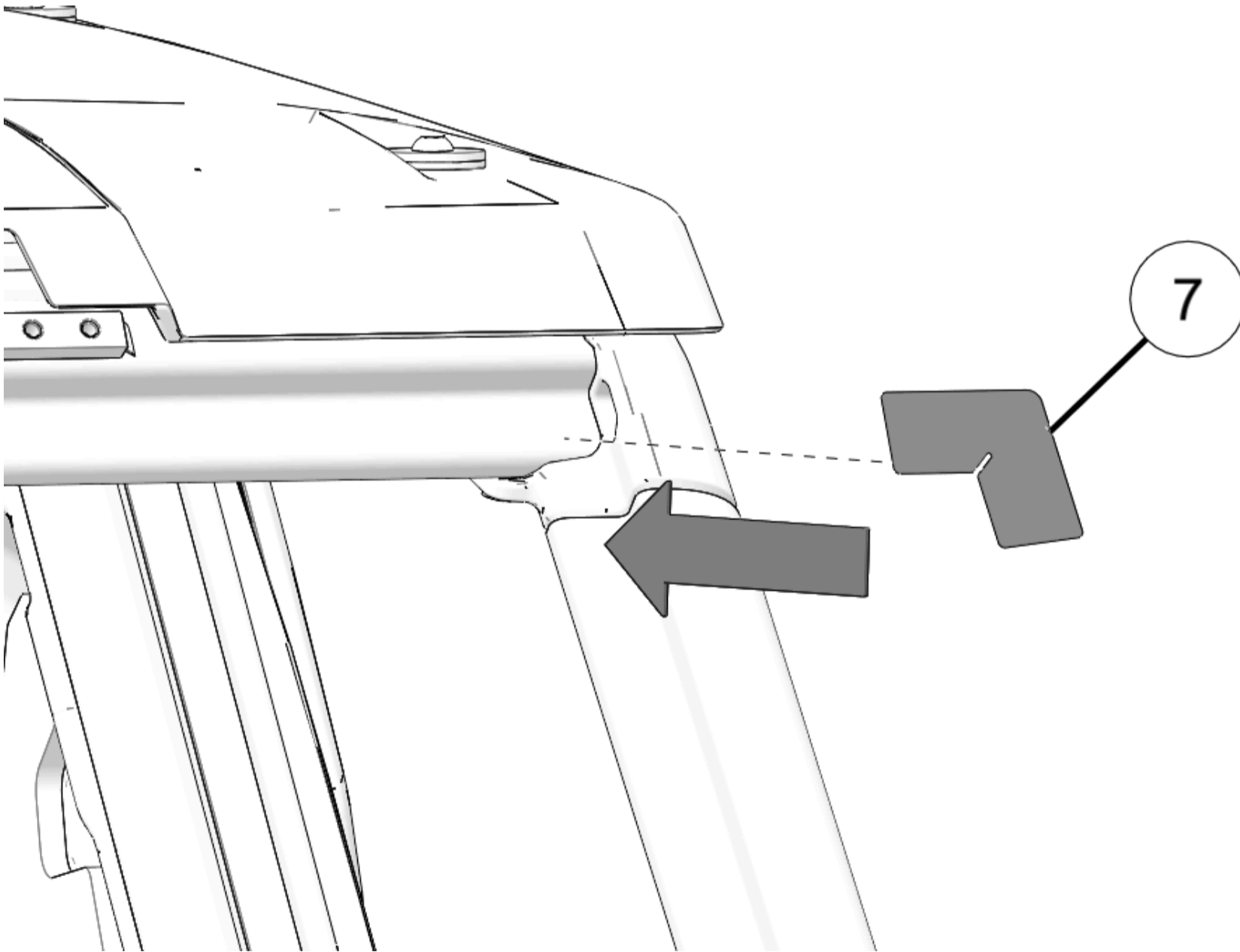

3. Make sure seal overlaps adjacent surfaces. Refer to illustration.

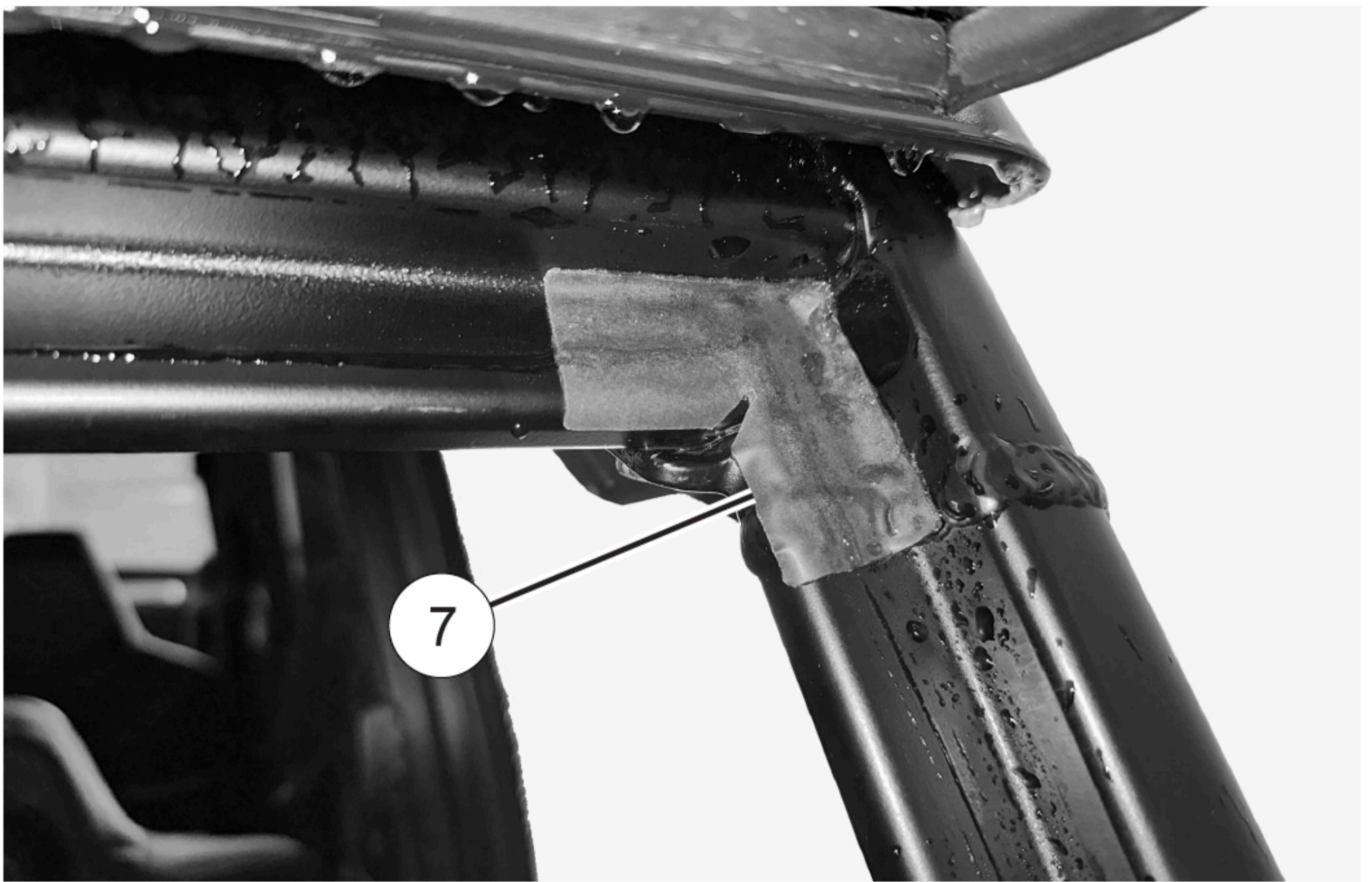

Rear Liftgate Installation

1. Loosely install ball stud (4), screw (5), and T-nut (6) into channel at rear of vehicle. Note orientation of T-nut (6).

NOTICE

Right side shown; left side similar.

DO NOT torque fasteners at this time.

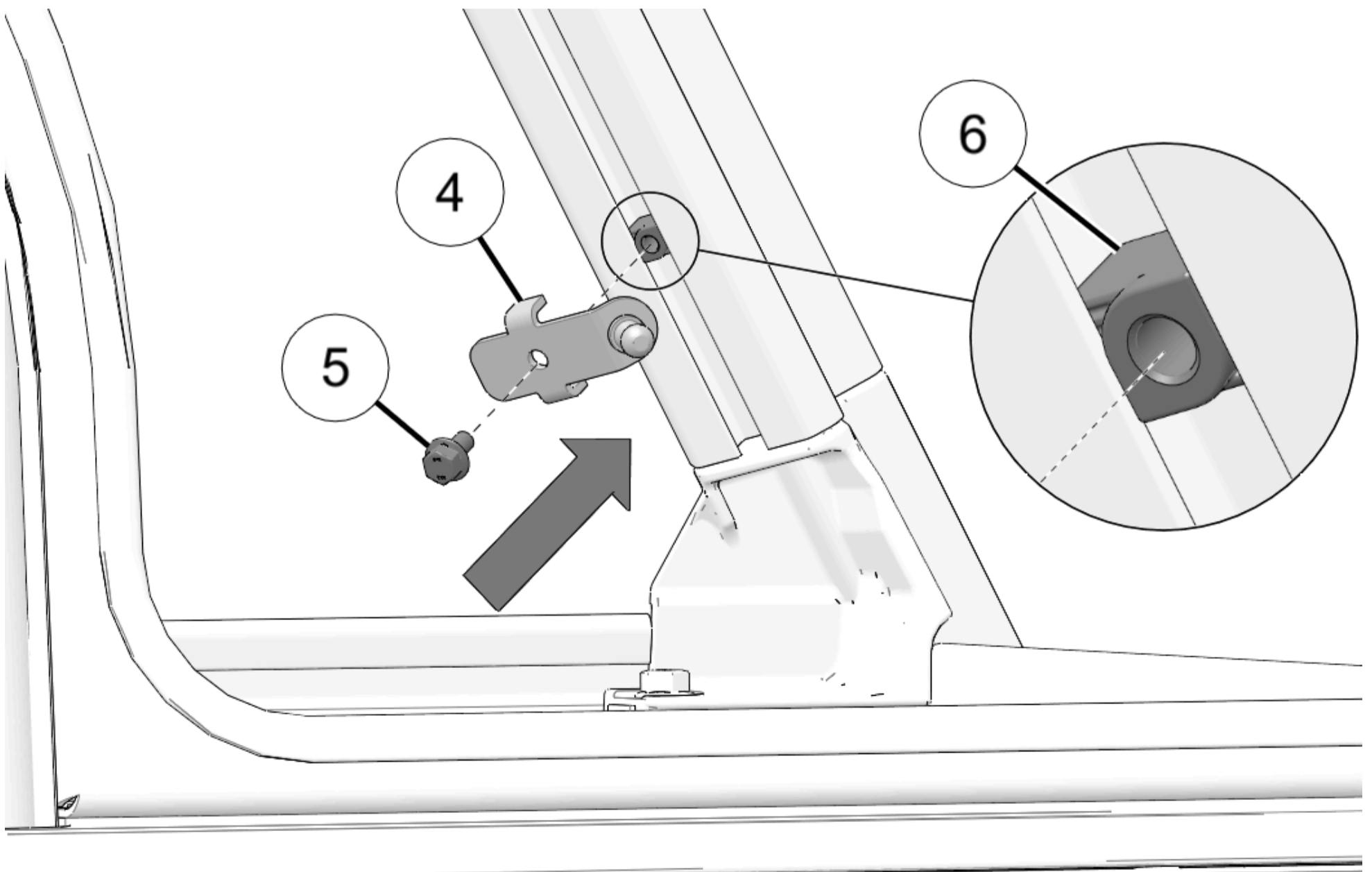

2. Adjust ball stud so that it is 2 in (50 mm) above bottom of channel. Torque screw to specification.

TORQUE

Screw ⑤:

15 ft-lbs (20 N·m)

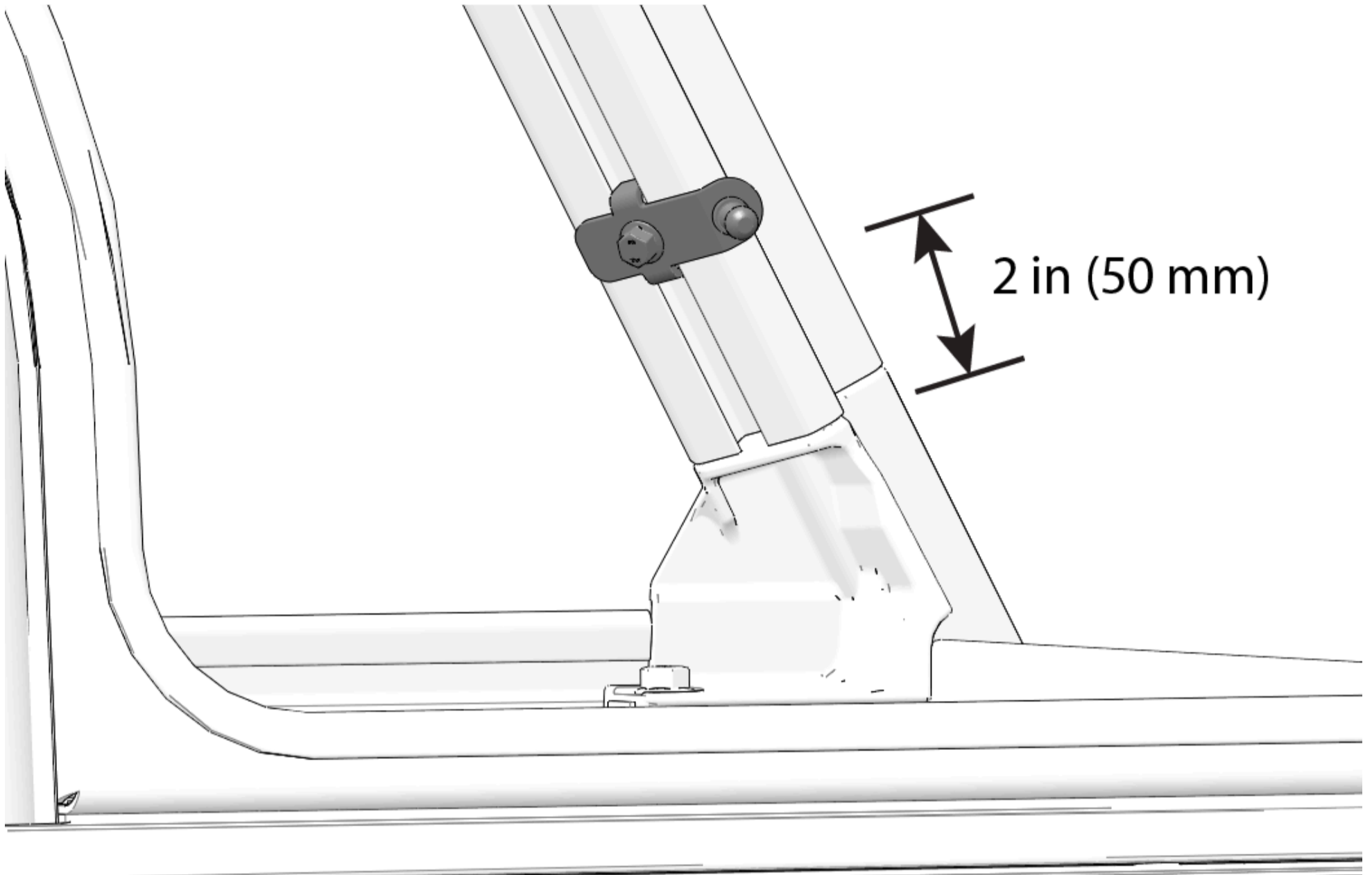

3. Remove and keep two M8 screws at top rear of roof.

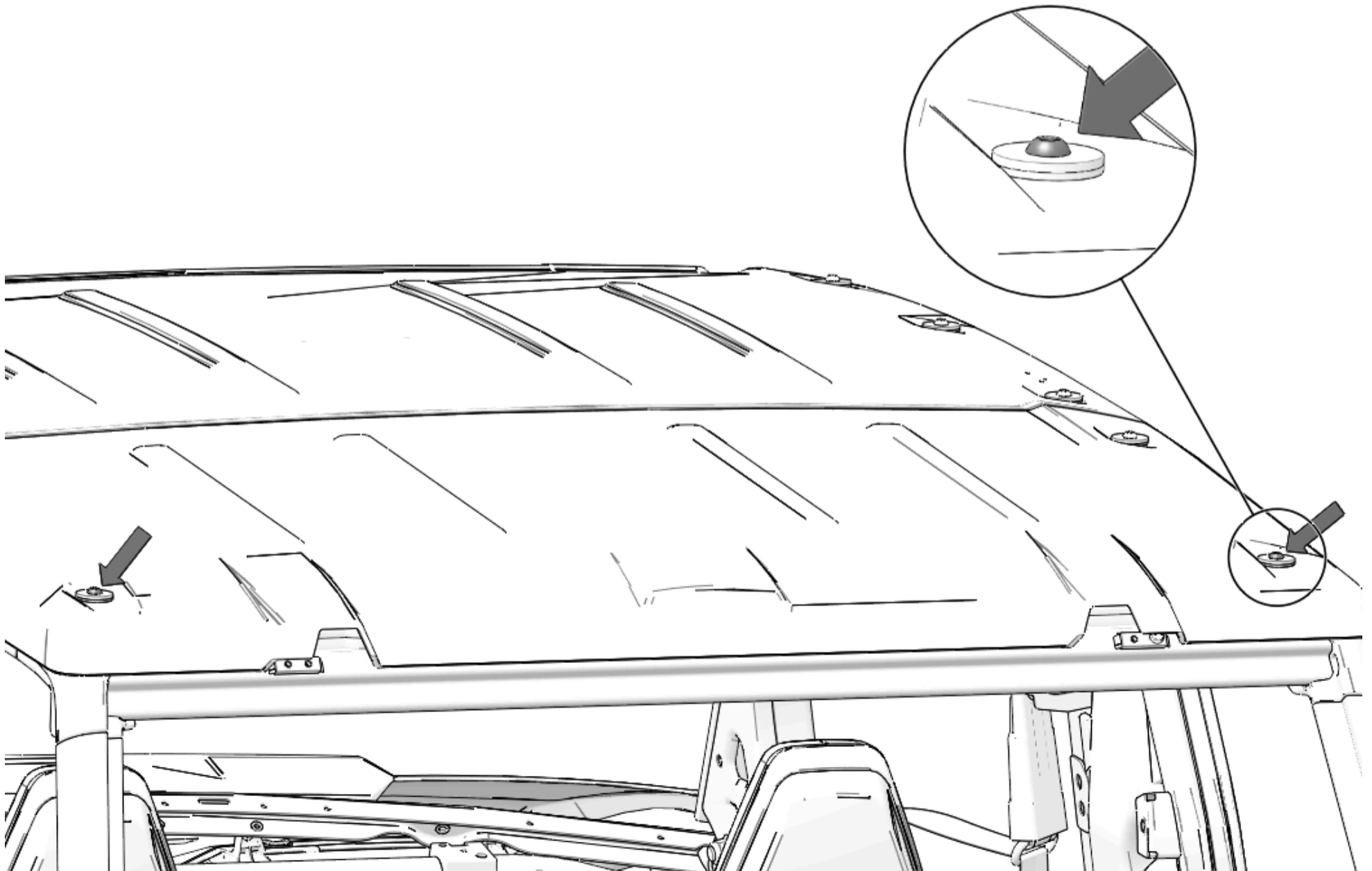

4. Remove and keep two M6 screws and two weld nuts at rear underside of roof. This will allow roof to be lifted slightly so that hinges can be installed.

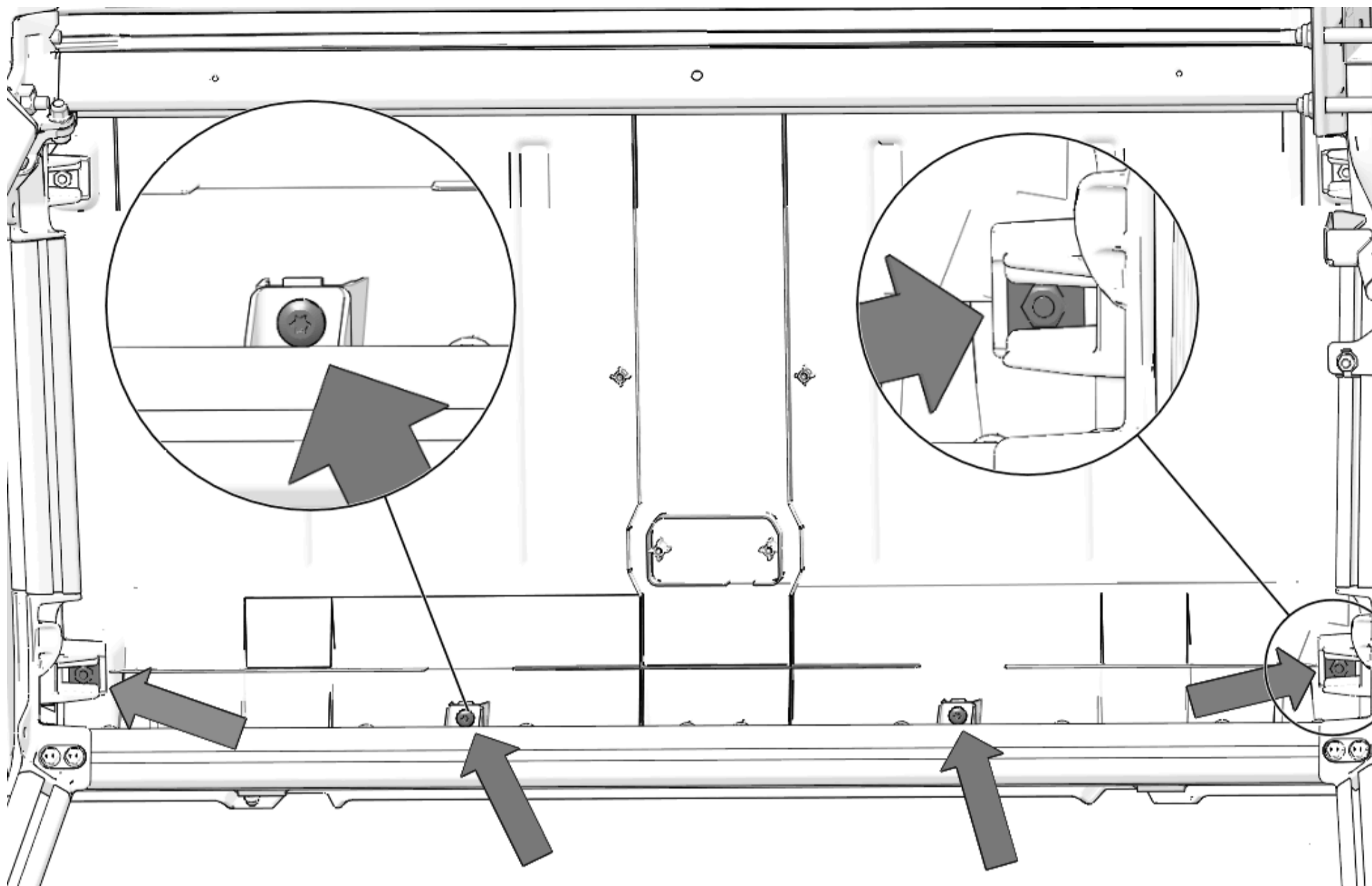

5. Lift roof slightly. With an assistant, set liftgate at rear of vehicle. Install four screws (3). Torque screws to specification.

TORQUE
Screws (3):
15 ft-lbs (20 N·m)

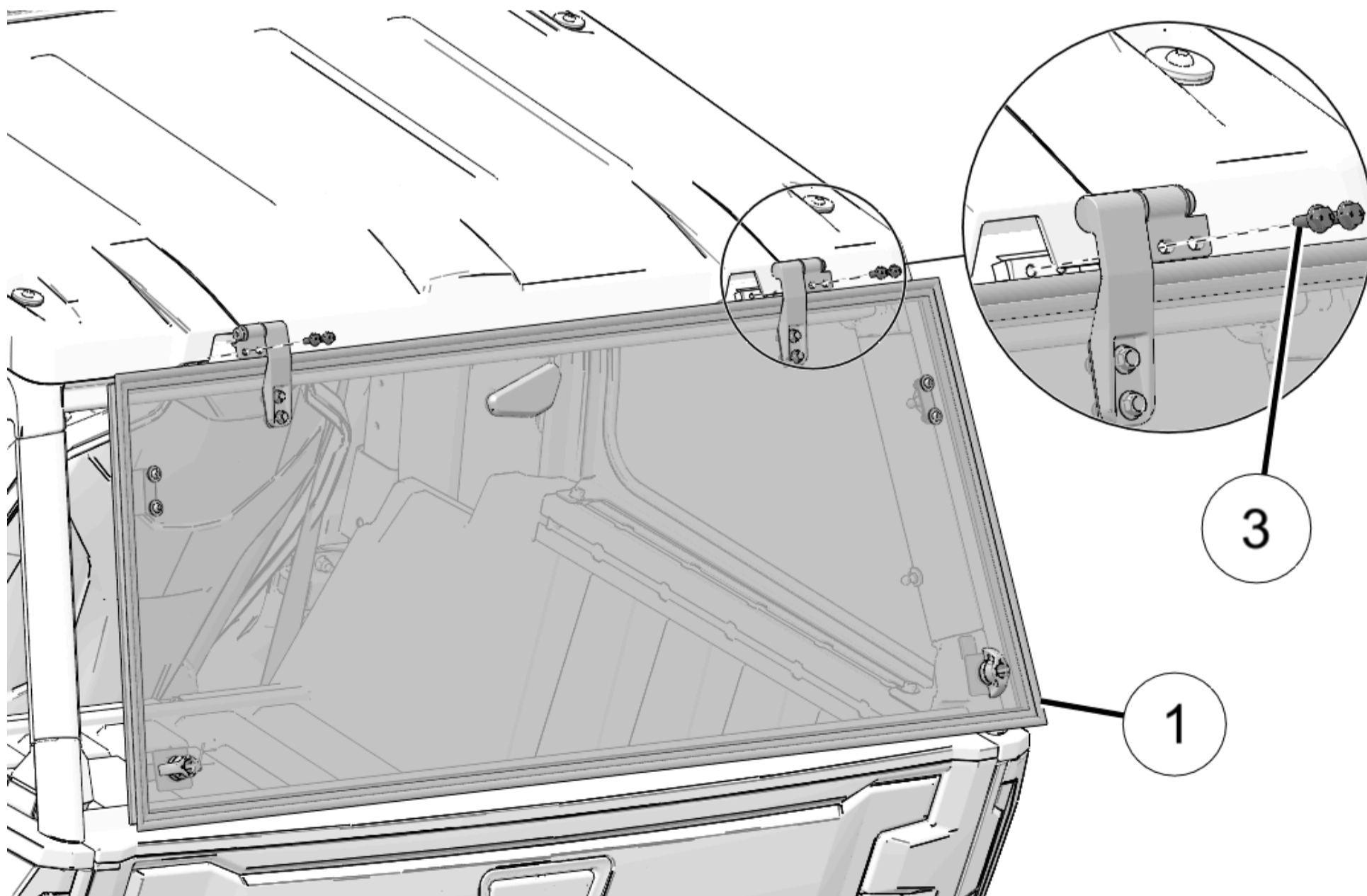

6. Install gas shock (2). Ends of gas shock snap onto ball studs on liftgate and vehicle. Note orientation of gas shock.

NOTICE

Right side shown; left side similar.

NOTICE

Make sure main body of gas shock is connected to liftgate. Rod end of gas shock connects to vehicle enclosure.

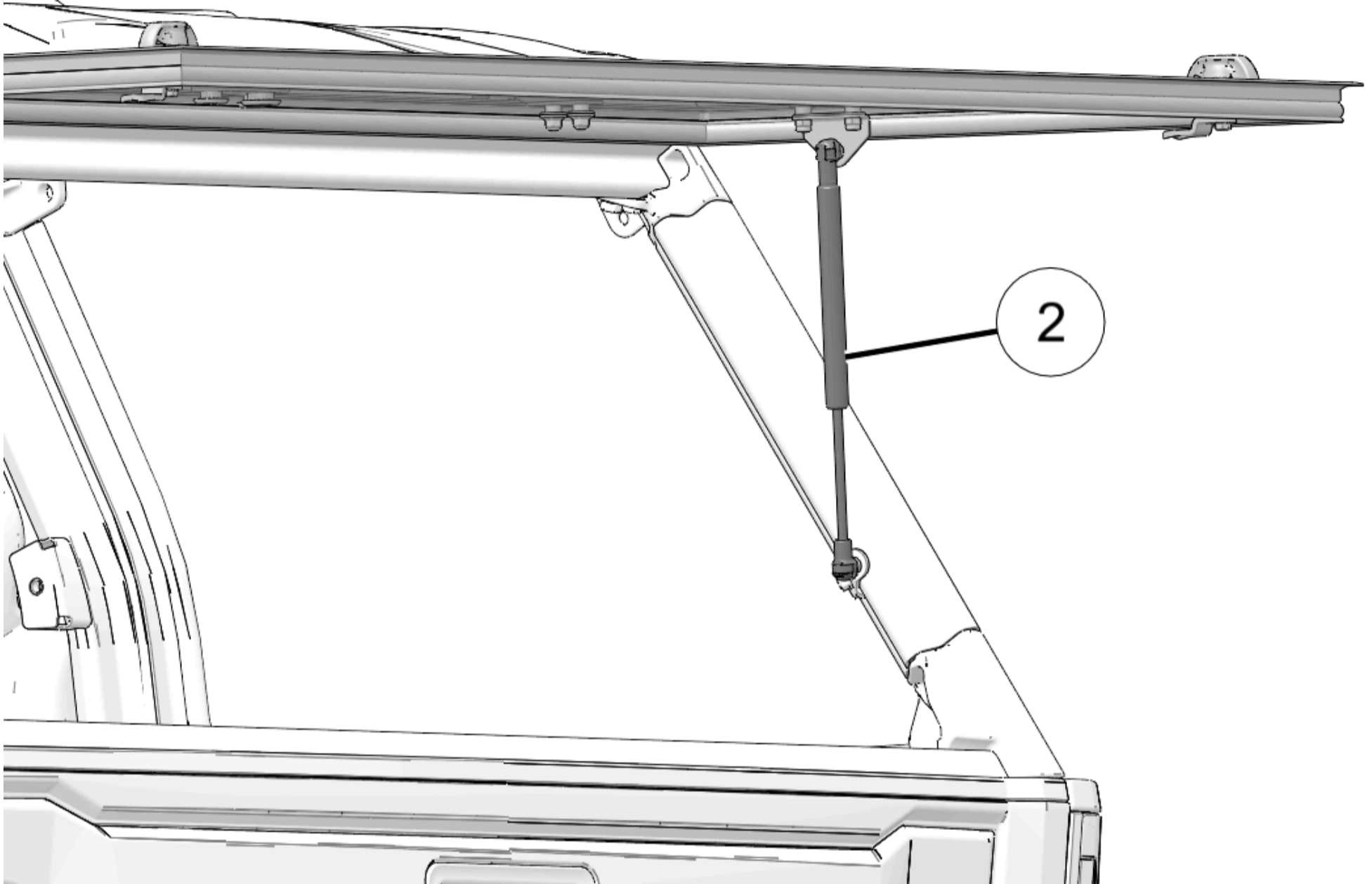

7. If needed, loosen screw (5) and adjust ball stud (4) on vehicle. Make sure that position of ball stud allows liftgate to fully close, and to open to desired height. When adjustment is complete, torque screw to specification.

NOTICE

Right side shown; left side similar.

TORQUE

Screw (5):

15 ft-lbs (20 N·m)

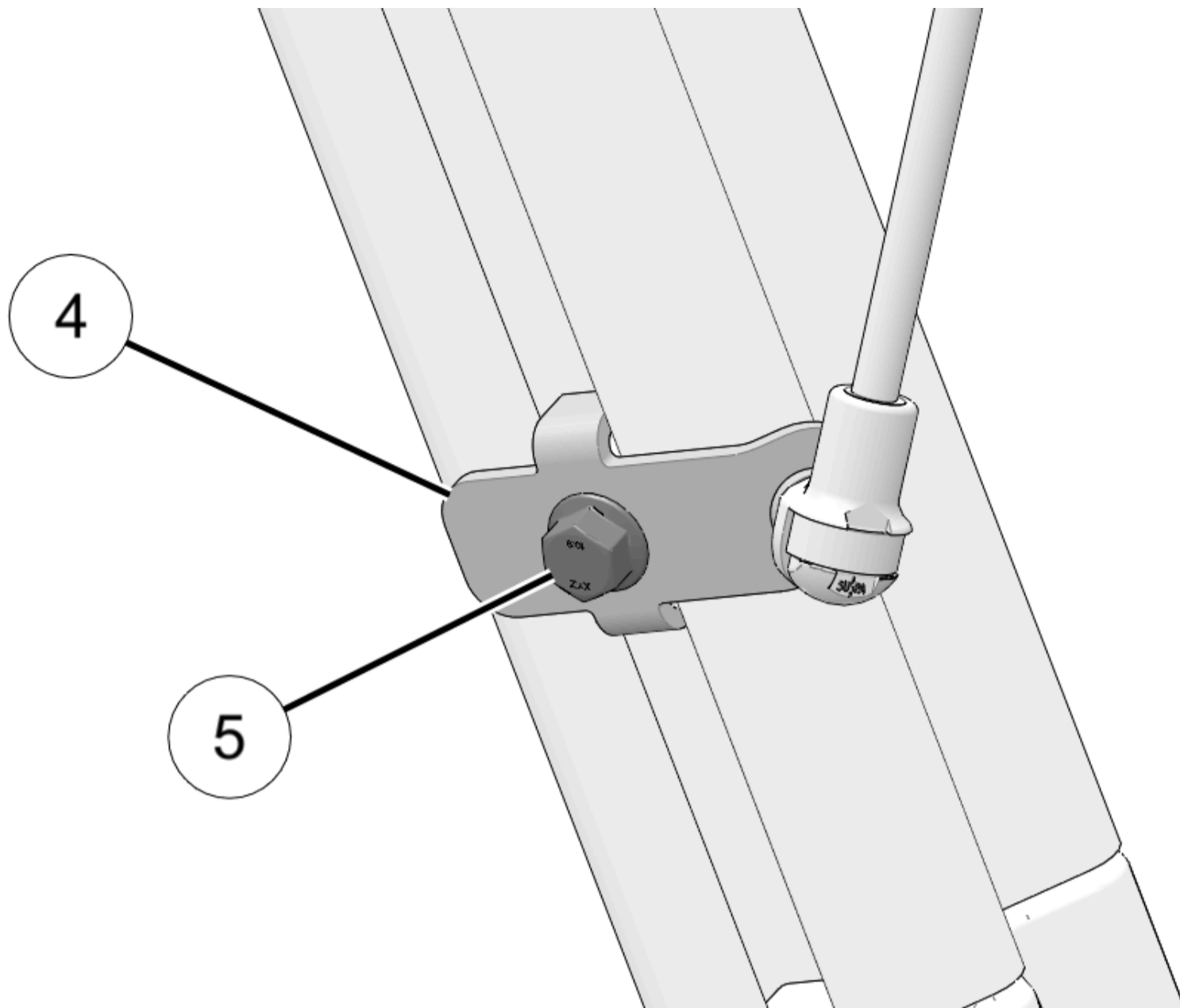

8. Install two kept M8 screws at top rear of the roof and weld nuts on underside of roof. Torque screws to specification.

TORQUE
M8 Screws: 18 ft-lbs (25 N·m)

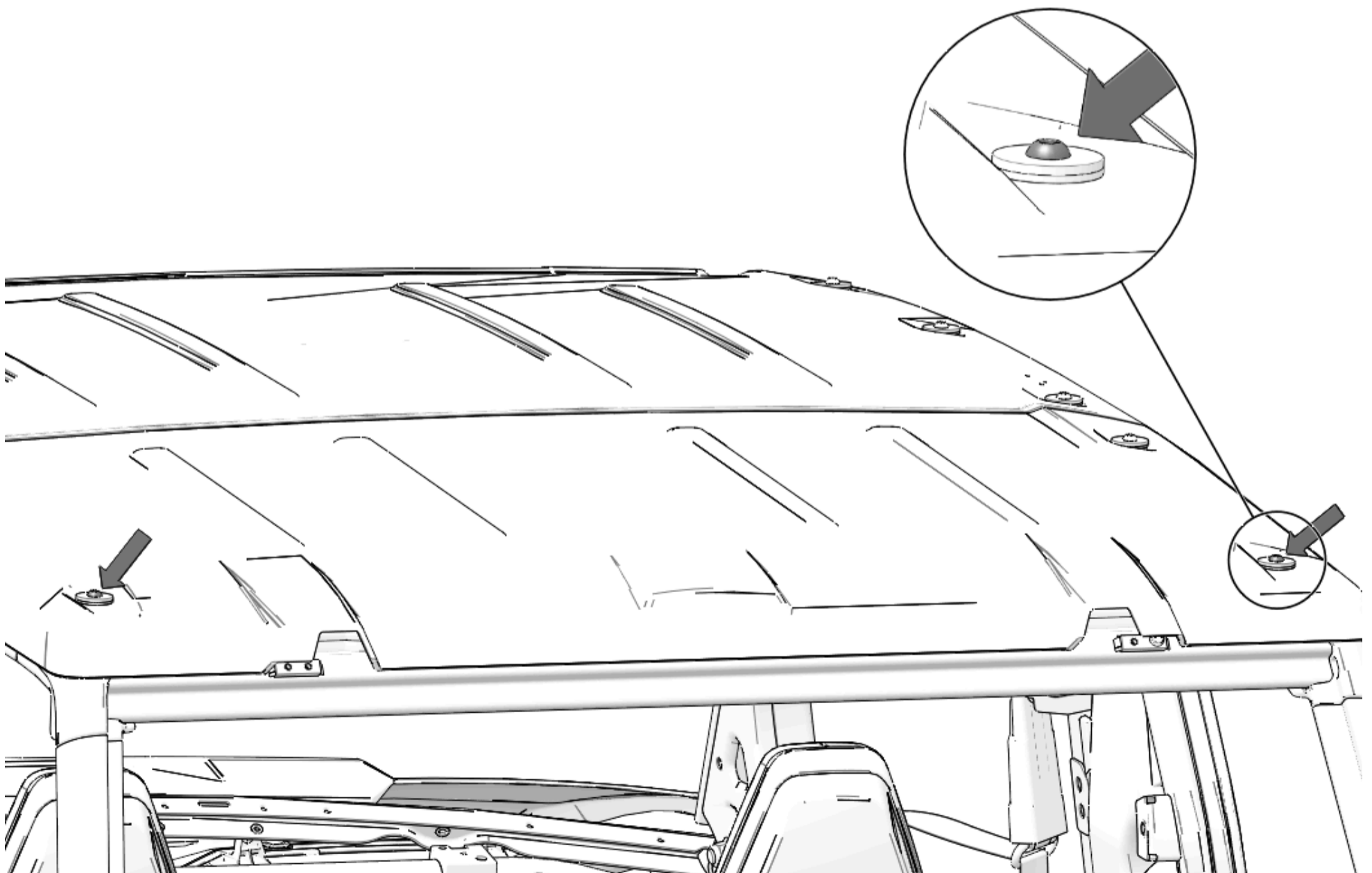

9. Install two kept M6 screws at rear underside of roof. Torque screws to specification

TORQUE

M6 Screws:

44 in-lbs (5 N·m)

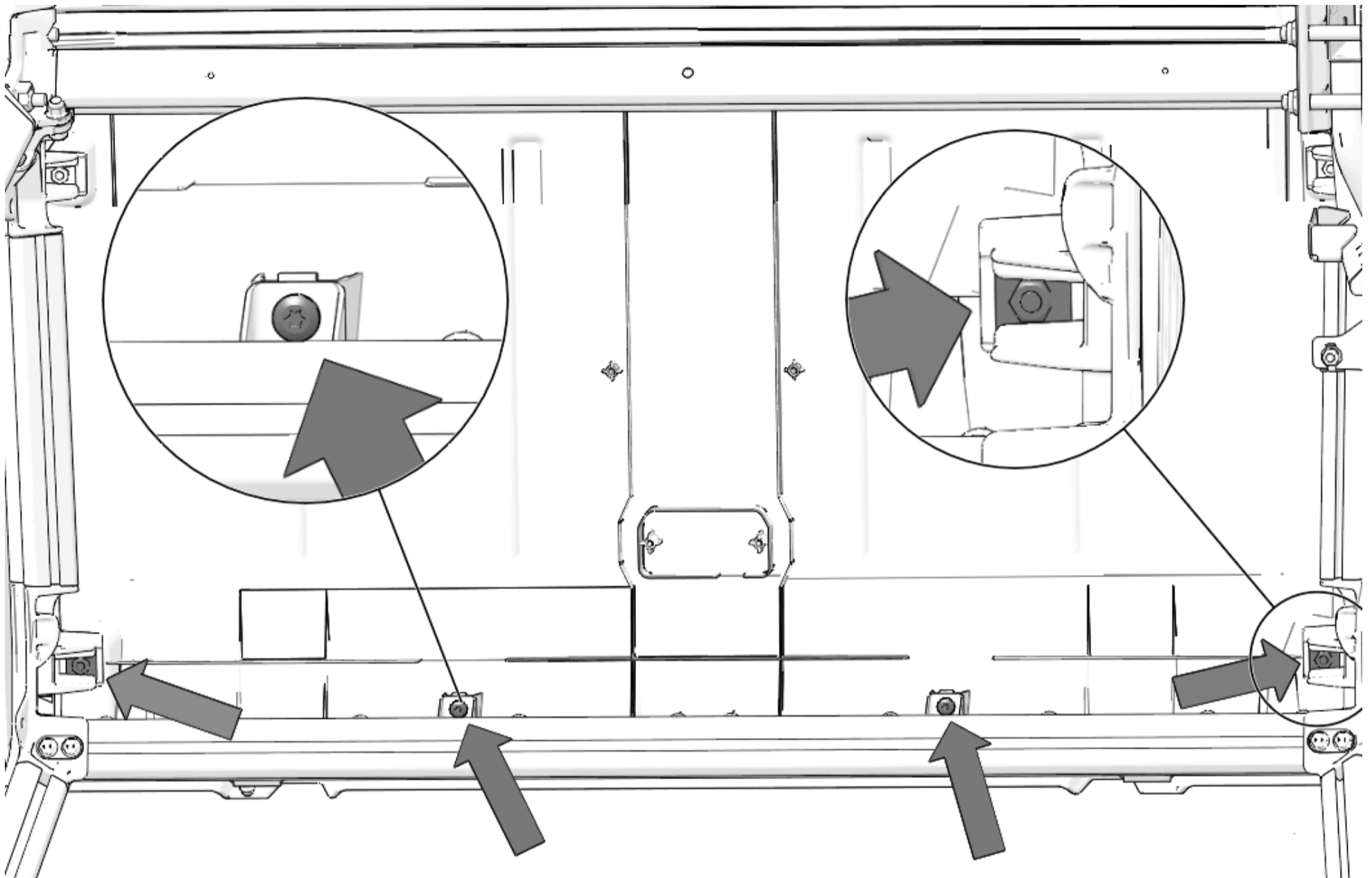

Operation

⚠ WARNING

If transporting vehicle in non-enclosed trailer, vehicle must FACE FORWARD and liftgate must be FULLY CLOSED and LOCKED. Otherwise, liftgate must be removed. Failure to comply may allow airflow, vibration, or other factors to separate liftgate from vehicle and cause an accident, resulting in serious personal injury or death.

⚠ WARNING

Do not drive vehicle with the liftgate open. Driving with liftgate open may cause airflow to lift gate and cause a loss of vehicle control resulting in accident or death.

Turn T-handles one-quarter turn to open the liftgate.

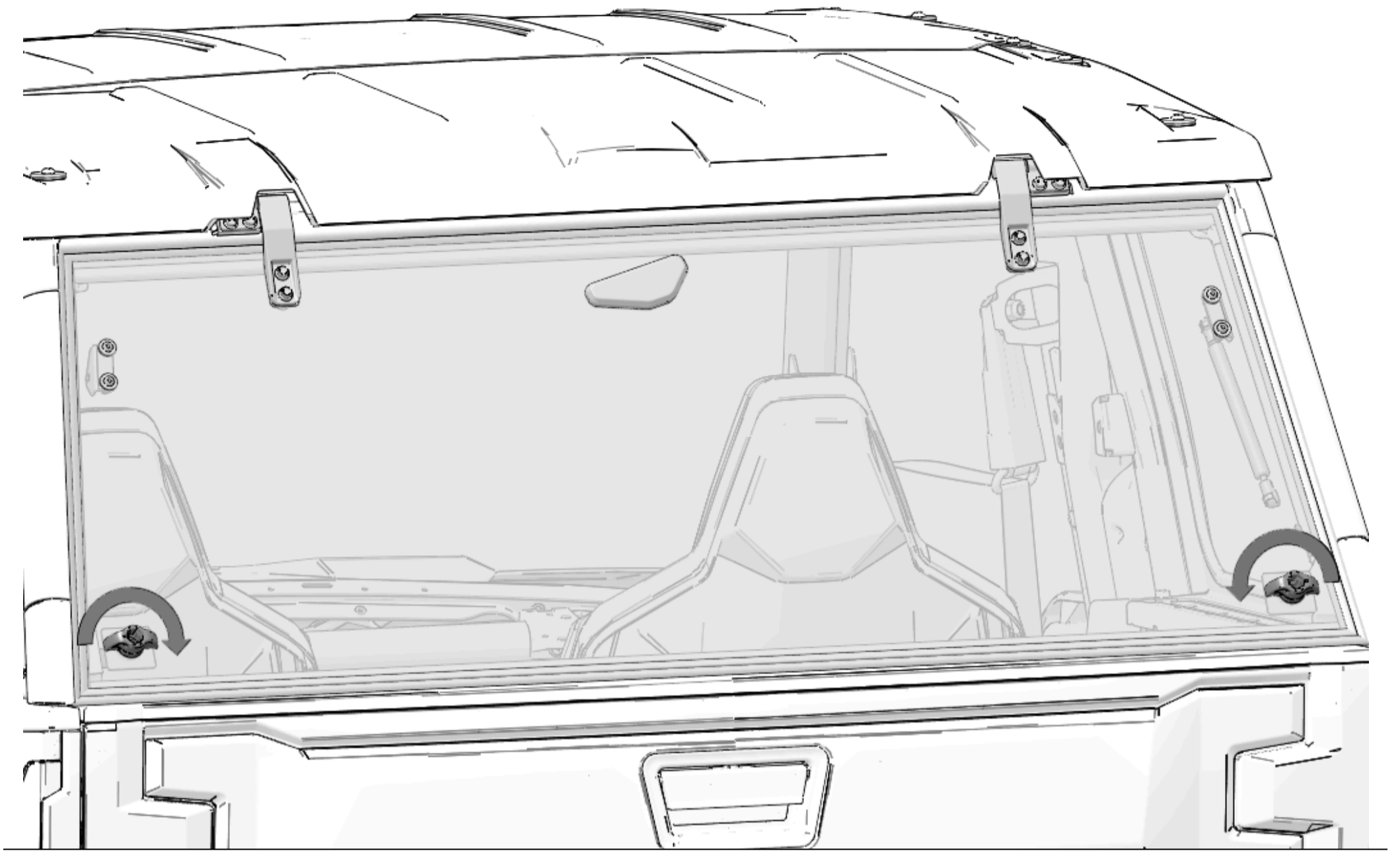

[Site Map](#)

[Privacy Policy](#)

[Accessibility](#)

© 2026 Polaris Inc.