

## Contents

Select Language 

Powered by  **Translate**

## Rear Panel Kit

P/N 2884412; 2889344

### Before You Begin

Before beginning assembly, inspect the kit and its component(s) to be sure all parts and tools are accounted for and not damaged. If missing parts or parts are damaged, please contact your Selling Dealer for assistance.

If your accessory was purchased online, please contact POLARIS customer service at **1-800-POLARIS** (US & Canada only).

### Application

Verify accessory fitment at [www.polaris.com](http://www.polaris.com).

P/N 2884412 & 2889344 Rear Panel Kits only fit Xpedition® XP models.

### Kit Contents

Rear Panel Kit P/N 2889344; 2884412

#### NOTICE

P/N 2889344 shown; P/N 2884412 similar.

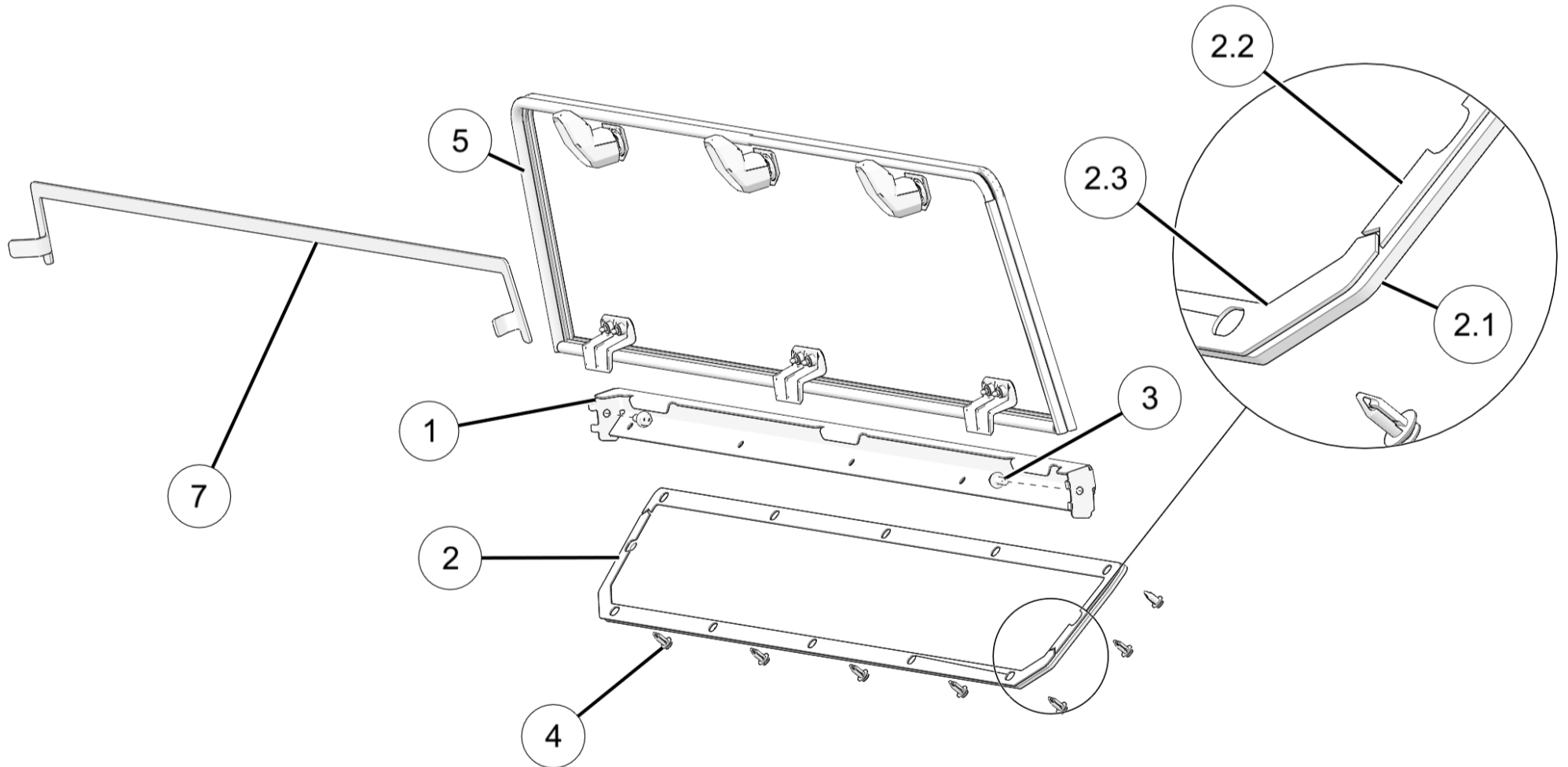

Ref	Qty	Part Description	P/N Available Separately	Available Service Kit
1	1	Rear Cross Brace	n/a	n/a
2	1	Rear Poly Window	2637904	n/a
2.1	1	- Window, Rear Poly	5459397	n/a

Ref	Qty	Part Description	P/N Available Separately	Available Service Kit
2.2	1	- Rear Panel Foam, Upper	5526480	n/a
2.3	1	- Rear Panel Foam, Lower	5526481	n/a
3	2	Hex Flange Head Screw (M8 x 1.25 x 20 mm)	7521332-20	2209651
4	12	Rivet, Push-Pin	7661855	2209651
5	1	Window Assembly, Rear Poly (P/N 2889344 only)	n/a	n/a
6	1	Window Assembly, Rear Glass (not shown) (P/N 2884412 only)	n/a	n/a
7	1	Seal	5815808	n/a

Hardware Service Kit P/N 2209451

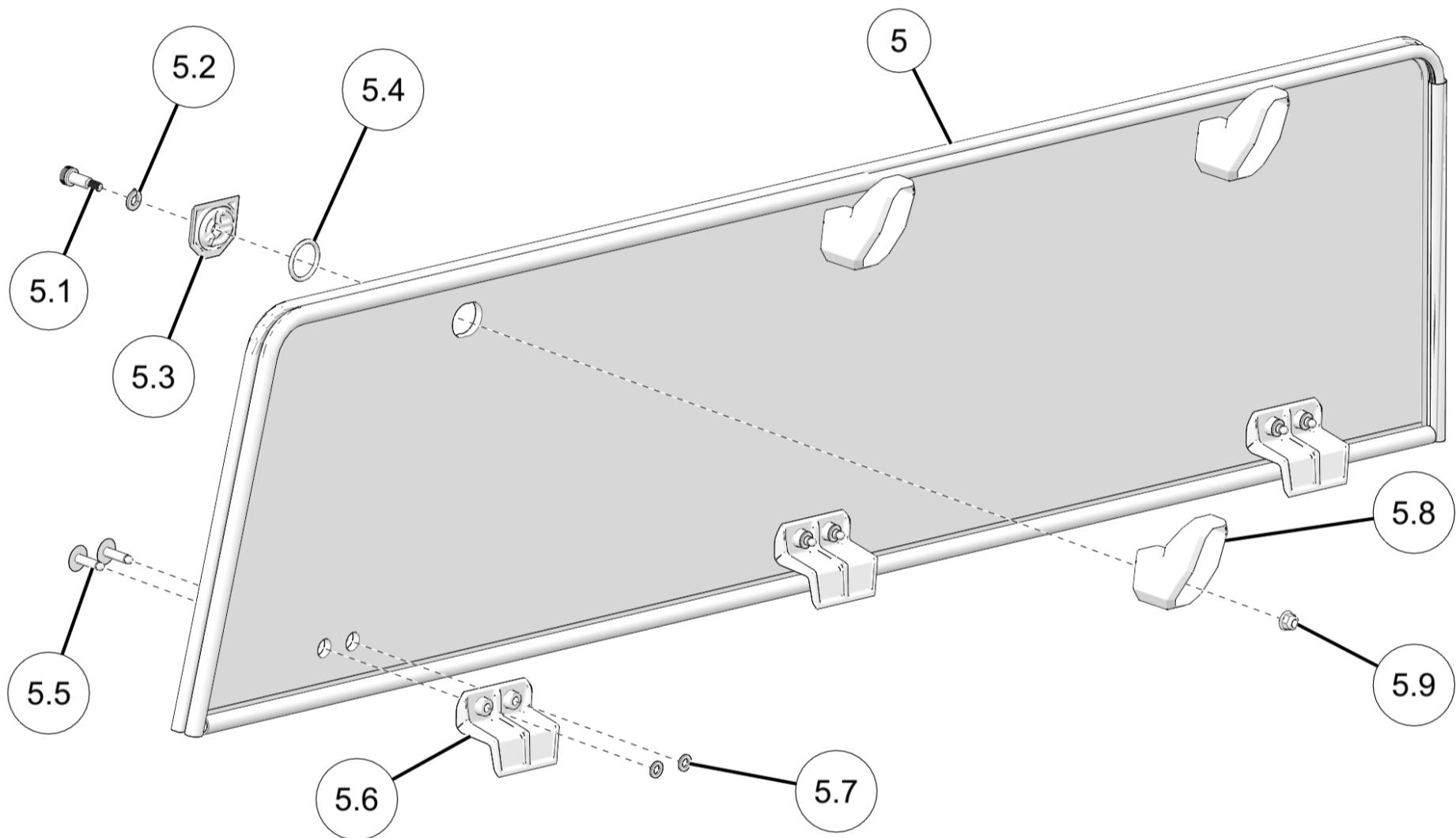

Ref	Qty	Part Description	P/N Available Separately	Available Service Kit
5	-	Window Assembly, Rear Poly	n/a	n/a
5.1	1	- Screw, Shoulder (M6 x 1.0 mm)	n/a	2209451
5.2	1	- Lockwasher 5/16 in	n/a	2209451
5.3	1	- Base	n/a	2209451
5.4	1	- O-Ring (31 mm) OD	n/a	2209451
5.5	2	- Rivet, Steel	n/a	2209451
5.6	1	- Bracket, Mount	5439918	2209451
5.7	2	- Flat Washer (6 mm)	n/a	2209451
5.8	1	- Lock & Ride® Handle	5452531	2209451
5.9	1	- Nut, Hex Flange Head, Nyloc (6 mm)	n/a	2209451

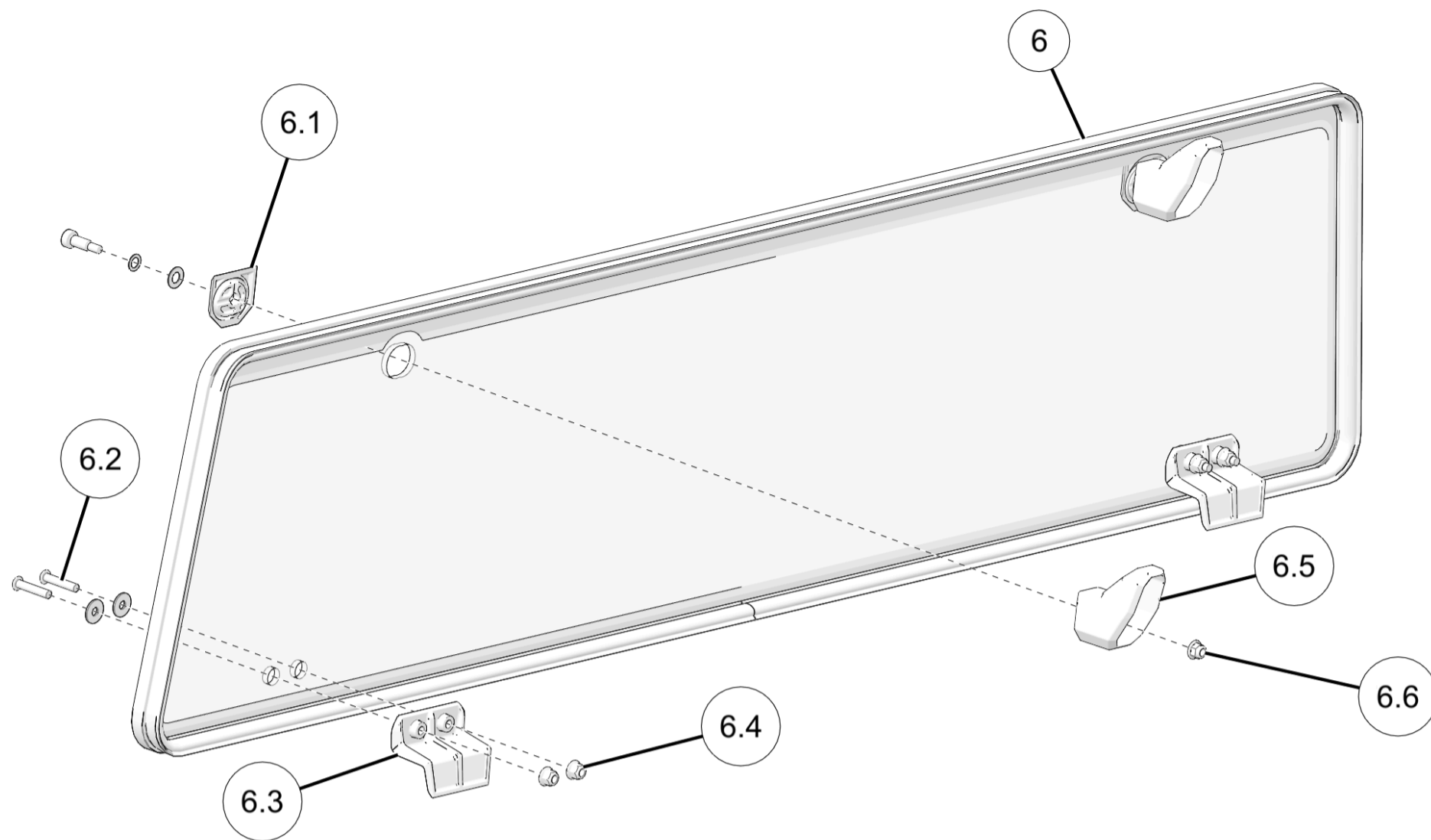

Ref	Qty	Part Description	P/N Available Separately	Available Service Kit
6	-	Window Assembly, Rear Glass	n/a	n/a
6.1	1	- Base	5451908	2209675
6.2	2	- Screw, Torx® Button Head (M6 x 1.0 x 30 mm)	7519745	2209675
6.3	1	- Bracket, Mount	5439918	2209675
6.4	2	- Nut, Hex Flange Head, Nyloc (6 mm)	7547475	2209675
6.5	1	- Lock & Ride® Handle	5452442	2209675
6.6	1	- Nut, Hex Flange Head, Nyloc (M6 x 1.0 mm)	7547453	2209675

### Tools Required

- Safety Glasses
- Pliers, Push Pin Rivet
- Socket Set, Metric
- Torque Wrench
- Utility Knife/Cutting Tool

### Consumables Required

- Isopropyl Alcohol (IPA)

### Important

Your Rear Panel Kit is exclusively designed for your vehicle. Please read the installation instructions thoroughly before beginning. Installation is easier if the vehicle is clean and free of debris. For your safety, and to ensure a satisfactory installation, perform all installation steps correctly in the sequence shown.

### Installation Instructions

#### Vehicle Preparation

##### General

1. Park vehicle on a flat surface.
2. Shift vehicle into PARK.

3. Turn key to OFF position and remove key.

### Rear Panel Preparation

#### Remove Stiffener Bracket

1. Remove five push-pin rivets from stiffener bracket.

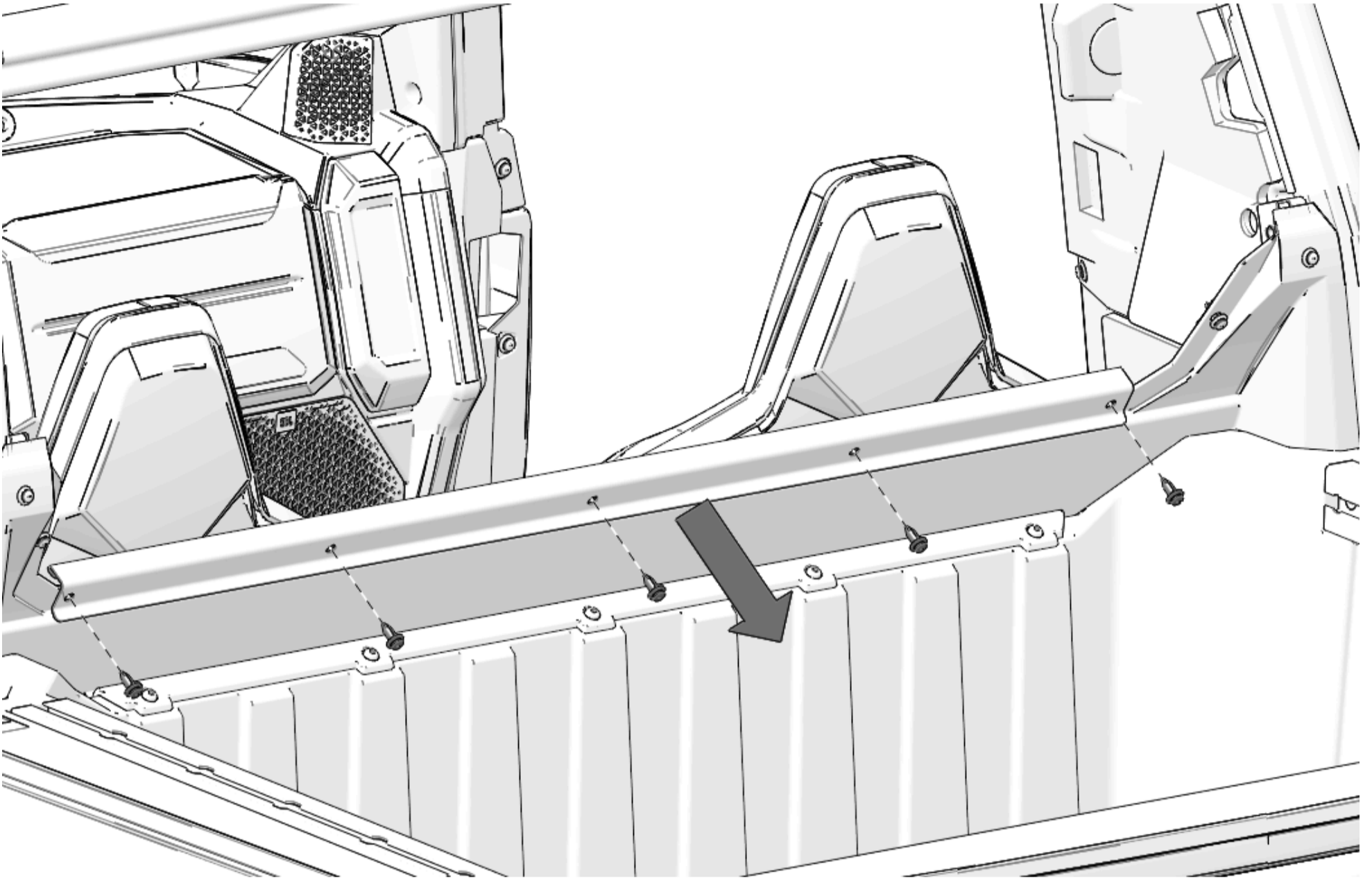

2. Remove stiffener bracket from vehicle.

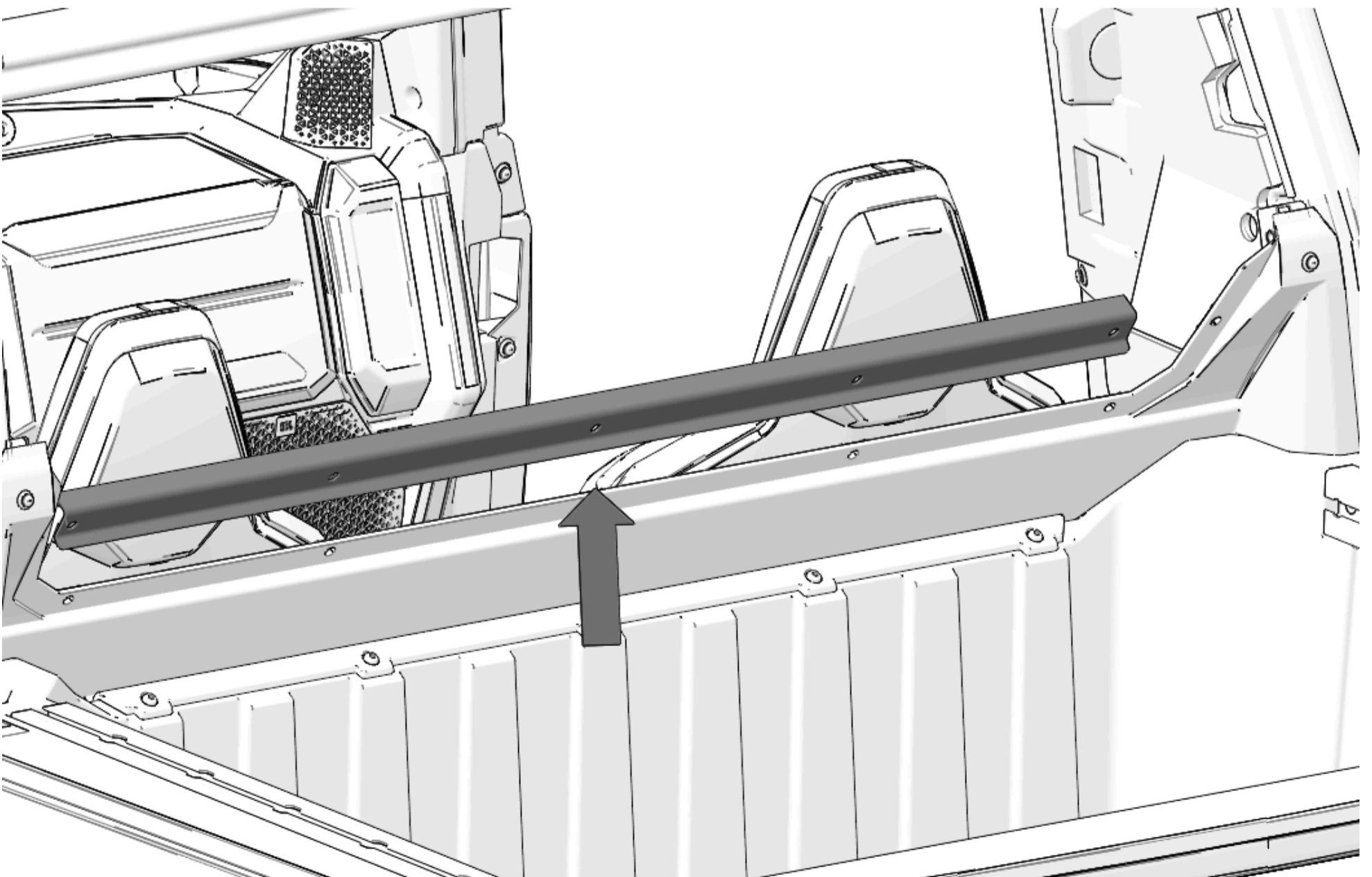

1. Find area to be trimmed near upper right corner of rear panel.

**NOTICE**

Right side shown; left side similar.

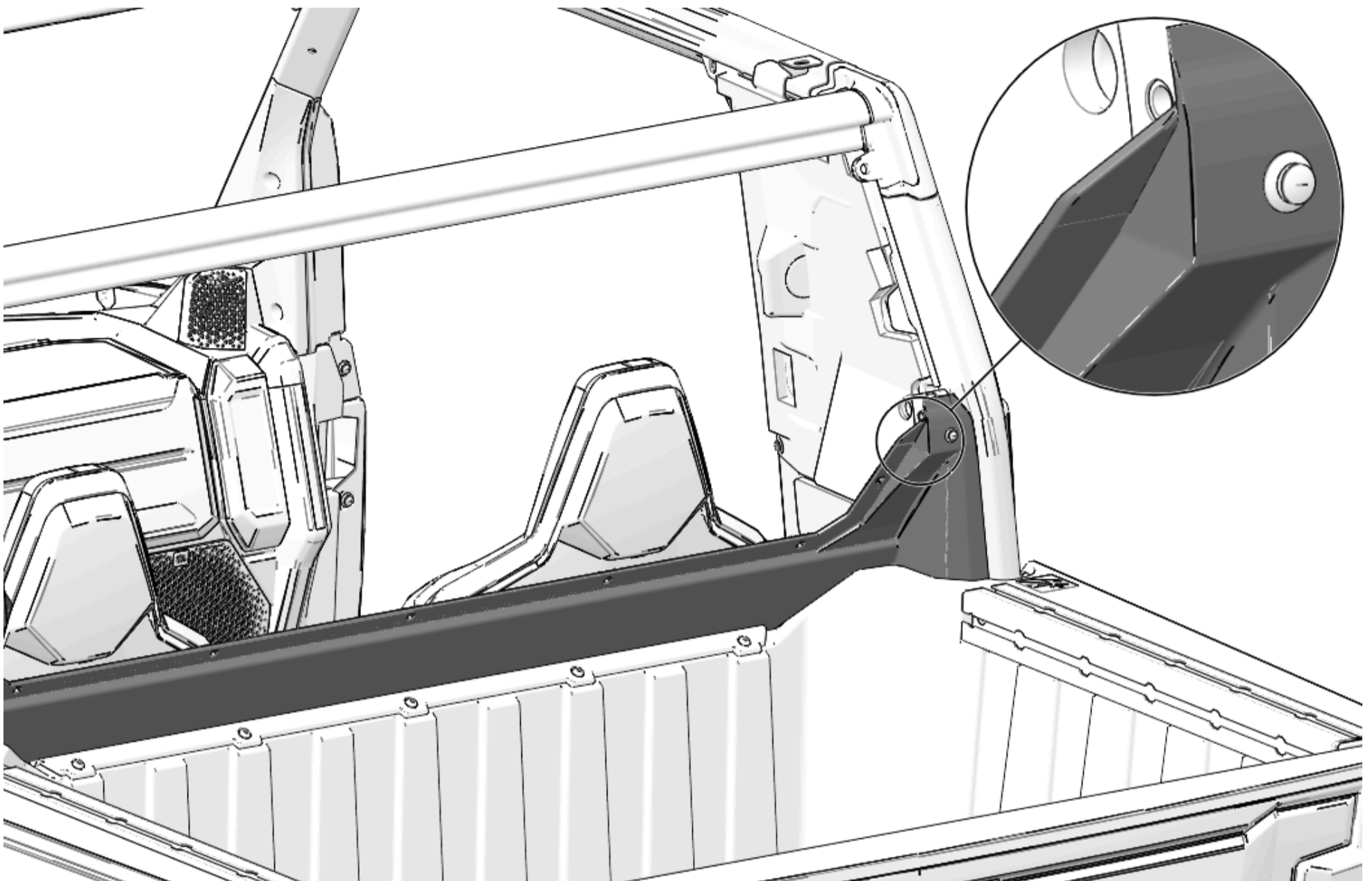

2. Cut out section shown in illustration.

**NOTICE**

Right side shown; left side similar.

**MEASUREMENT**

Dimension A: **1 1/8 in (29 mm)**

**MEASUREMENT**

Dimension B: **15/16 in (23 mm)**

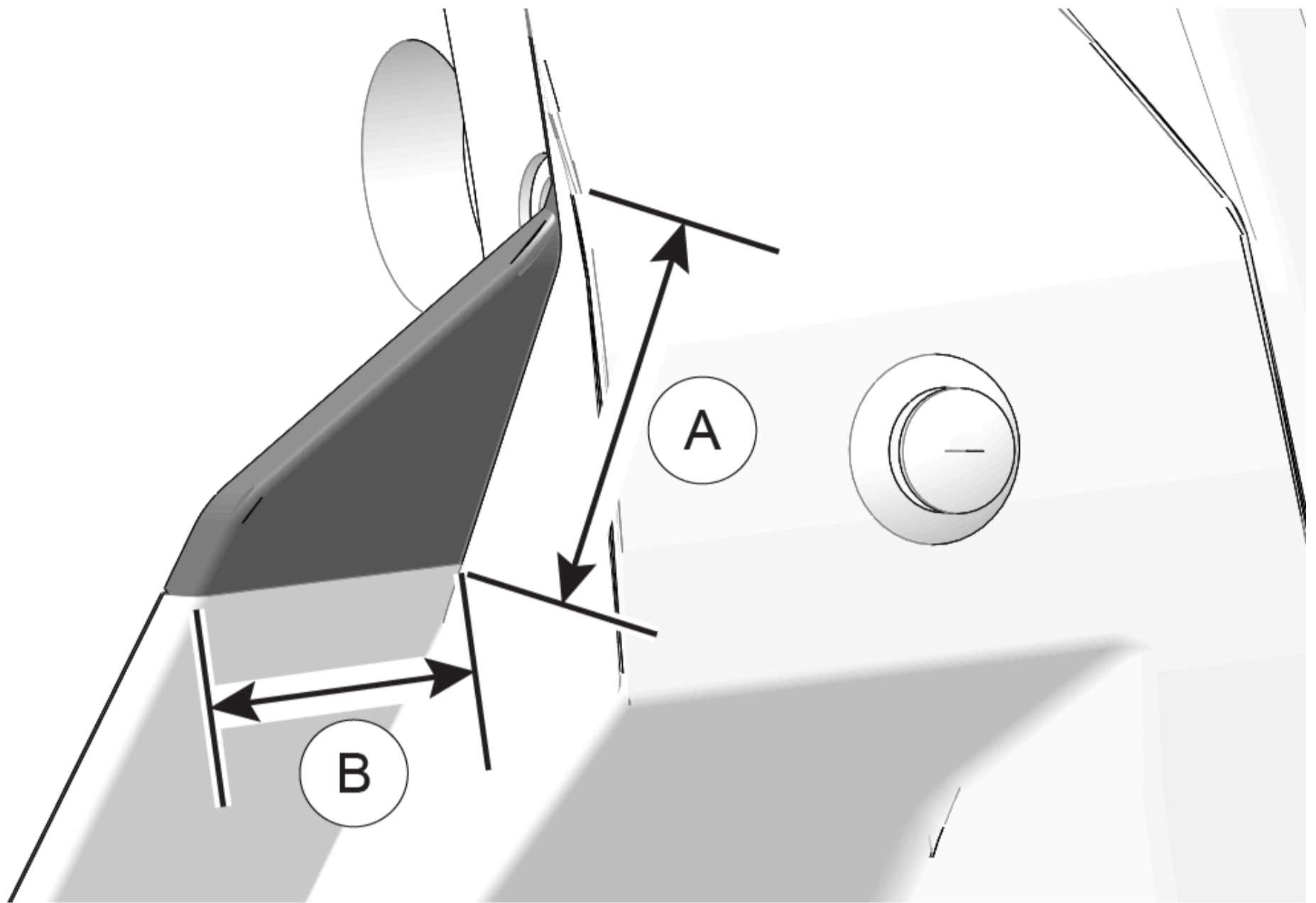

## Accessory Installation

### Seal Installation

1. Clean top of rear frame opening with isopropyl alcohol. Clean sides of frame down to 2 in (51 mm) below tab (A). In area below tab (A), clean both rear and front sides of frame. Allow area to dry completely.

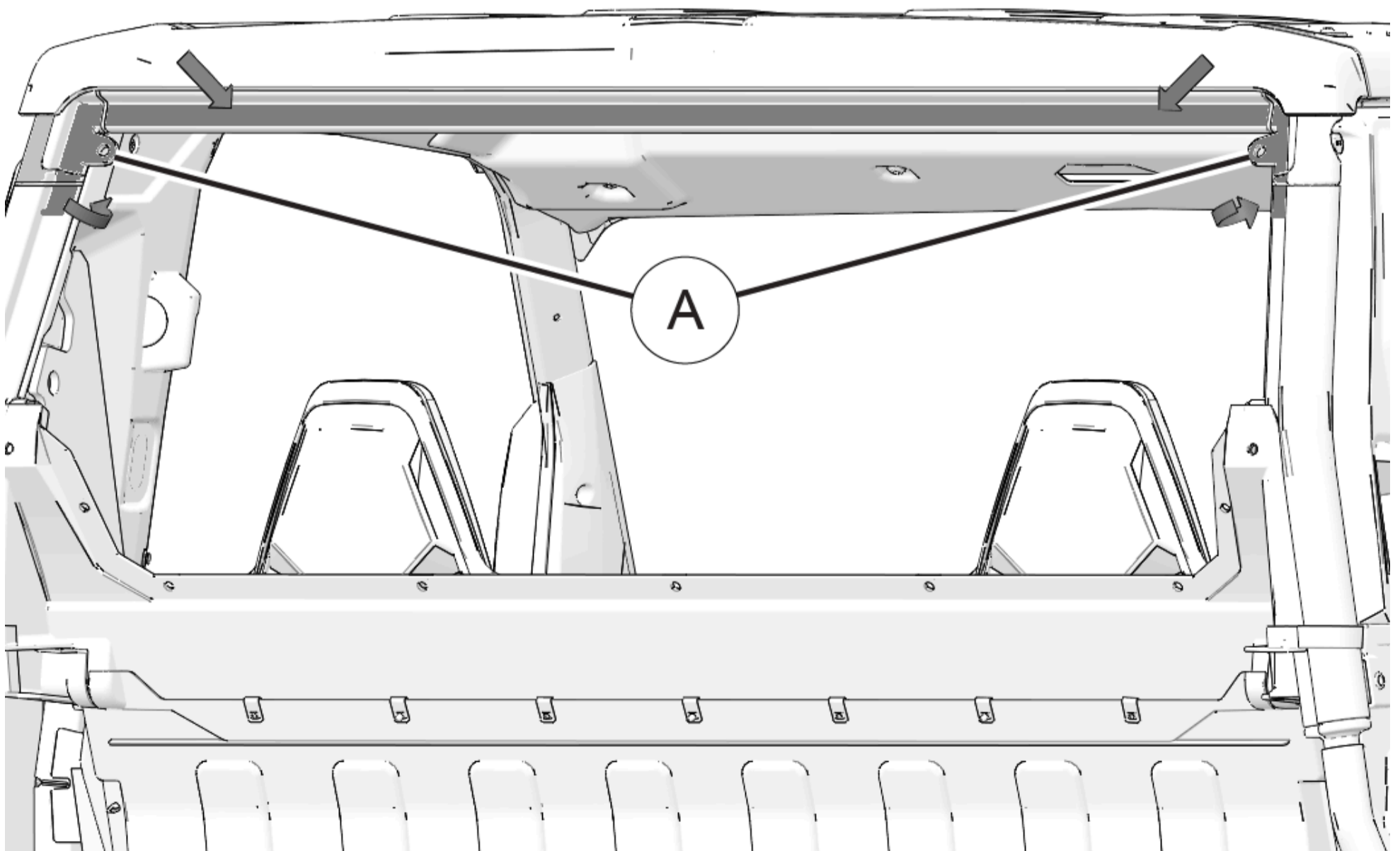

2. Remove backing from seal (7). Apply seal to frame. Wrap tabs on seal around frame.

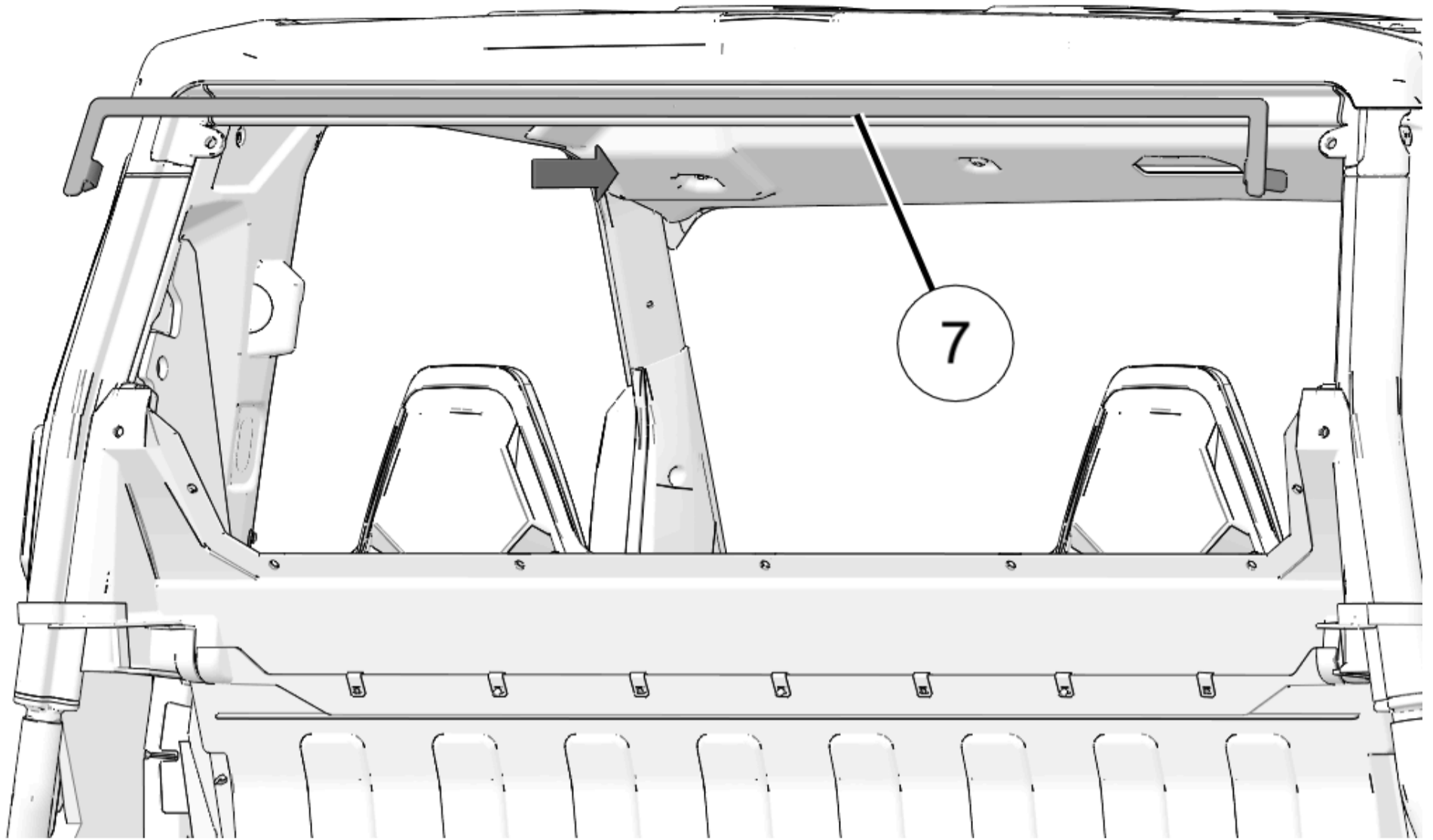

3. Refer to illustration for proper installation of seal ⑦.

**NOTICE**

Right side shown; left side similar.

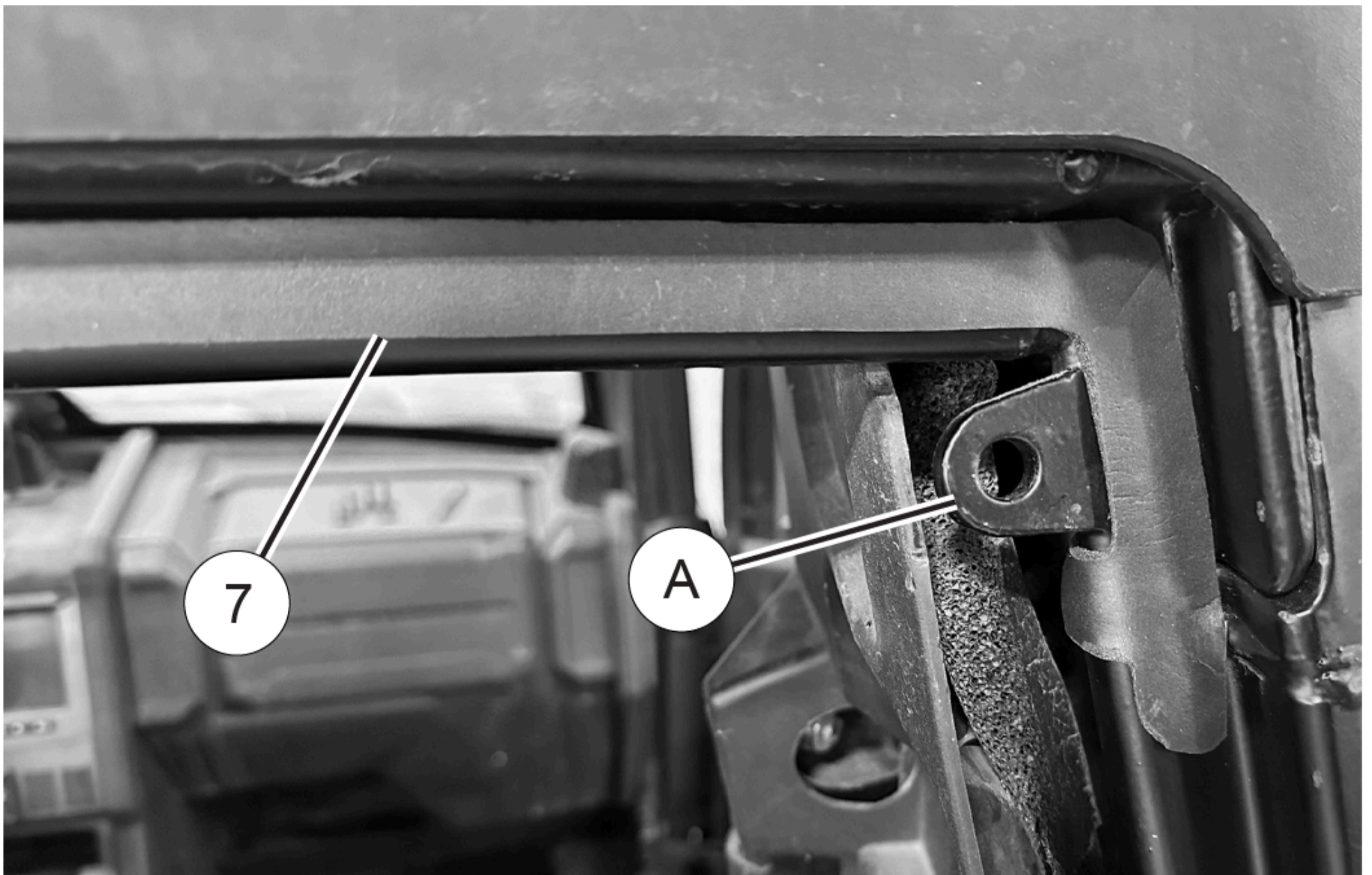

**Rear Close-Off Installation**

1. Install cross brace ① at rear of cab. Note orientation of cross brace. Install two screws ③. Torque screws to specification.

## TORQUE

Screws ③:

**15 ft-lbs (20 N·m)**

## NOTICE

Left side shown; right side similar.

## IMPORTANT

Check fit of cross brace in trimmed area of rear panel. If interference is found, trim rear panel as needed.

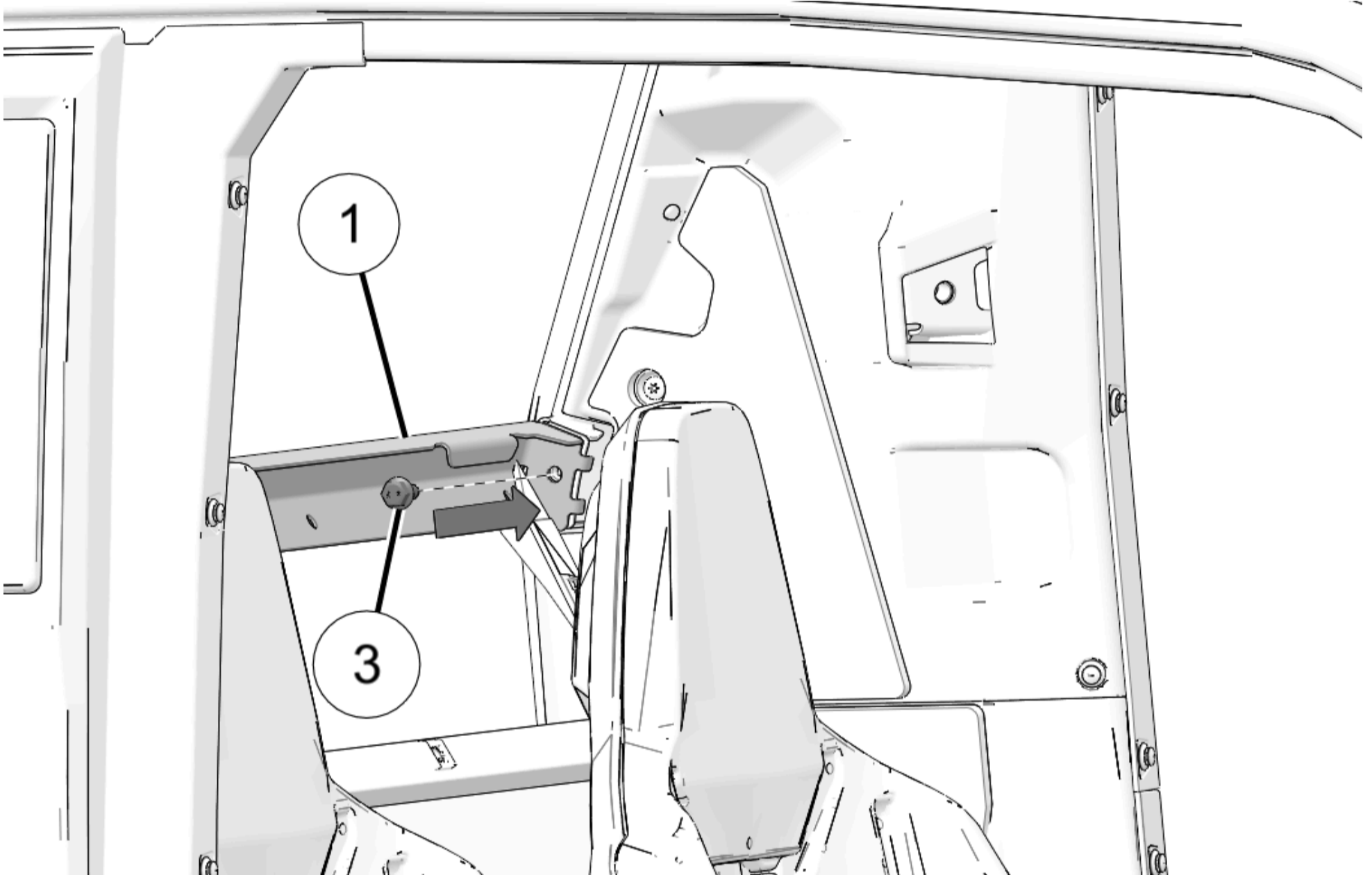

2. Install poly window ② to cross brace with five push-pin rivets ④.

## NOTICE

Examine alignment of all panel mounting holes before installing push-pin rivets. Foam on panel should face toward inside.

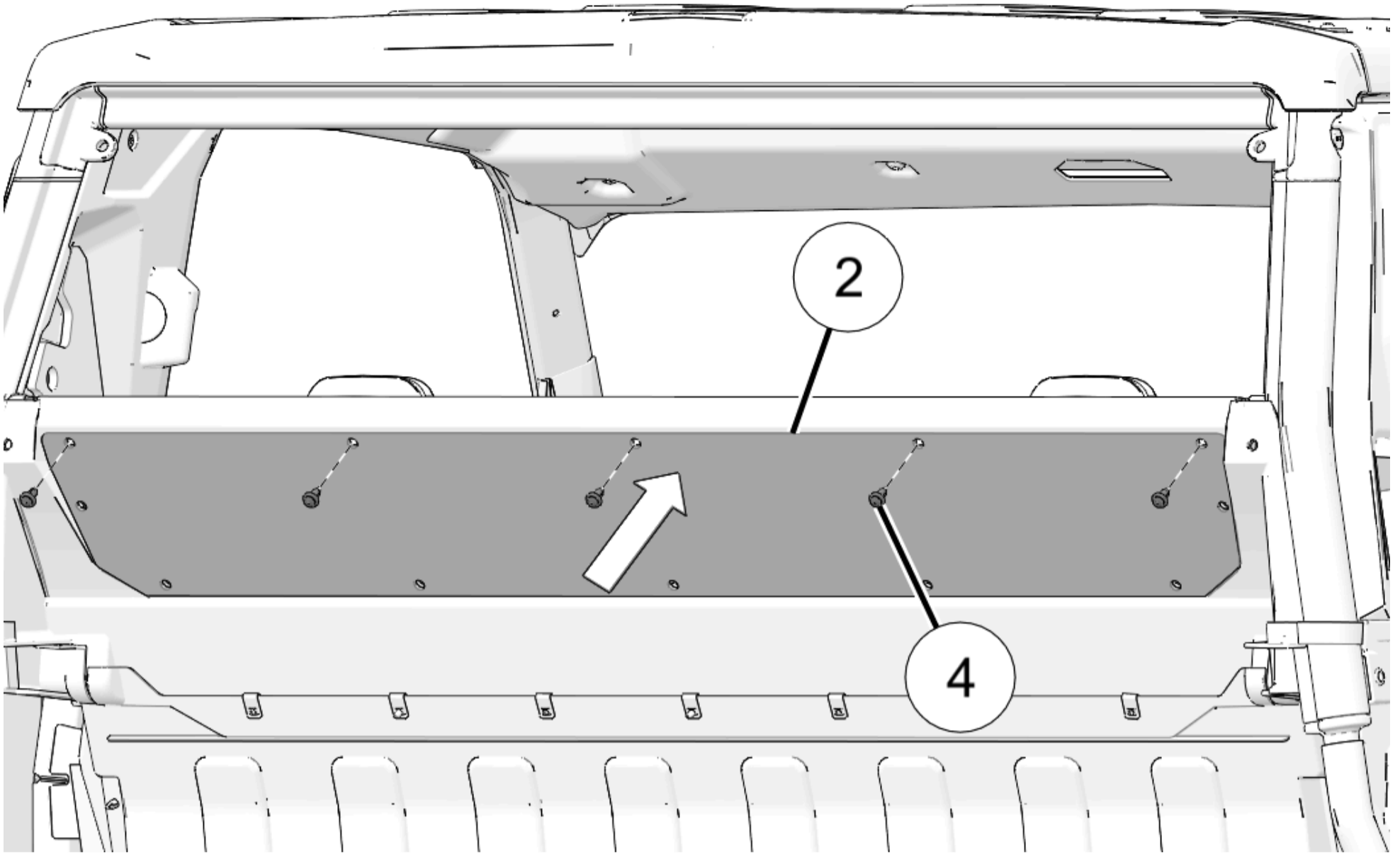

3. Install seven push-pin rivets (4) at sides and bottom of poly window.

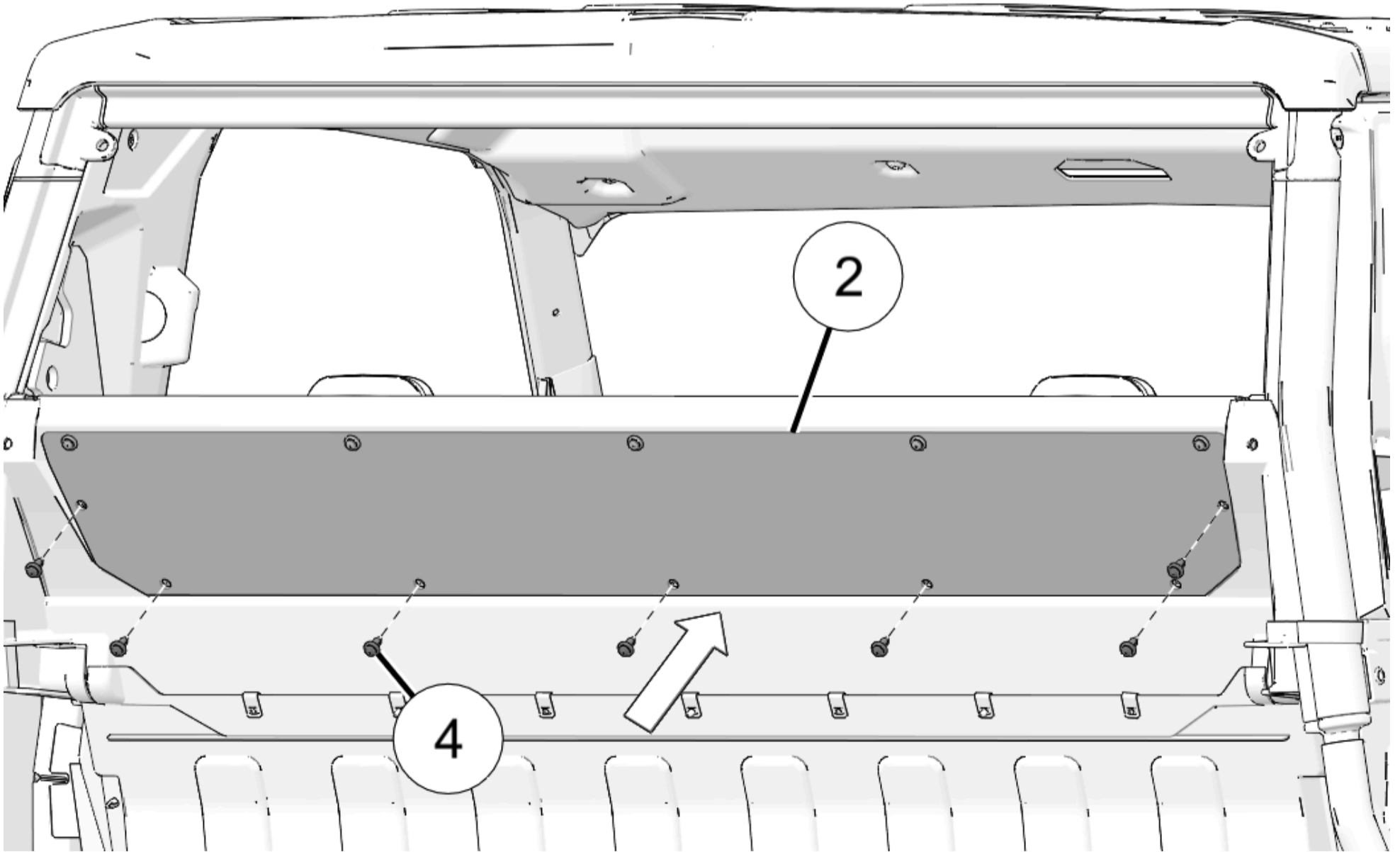

### Rear Window Installation

#### **NOTICE**

Poly window shown; glass window similar.

1. Lower window into position. Make sure lower mounting brackets are fully seated on crossbar.

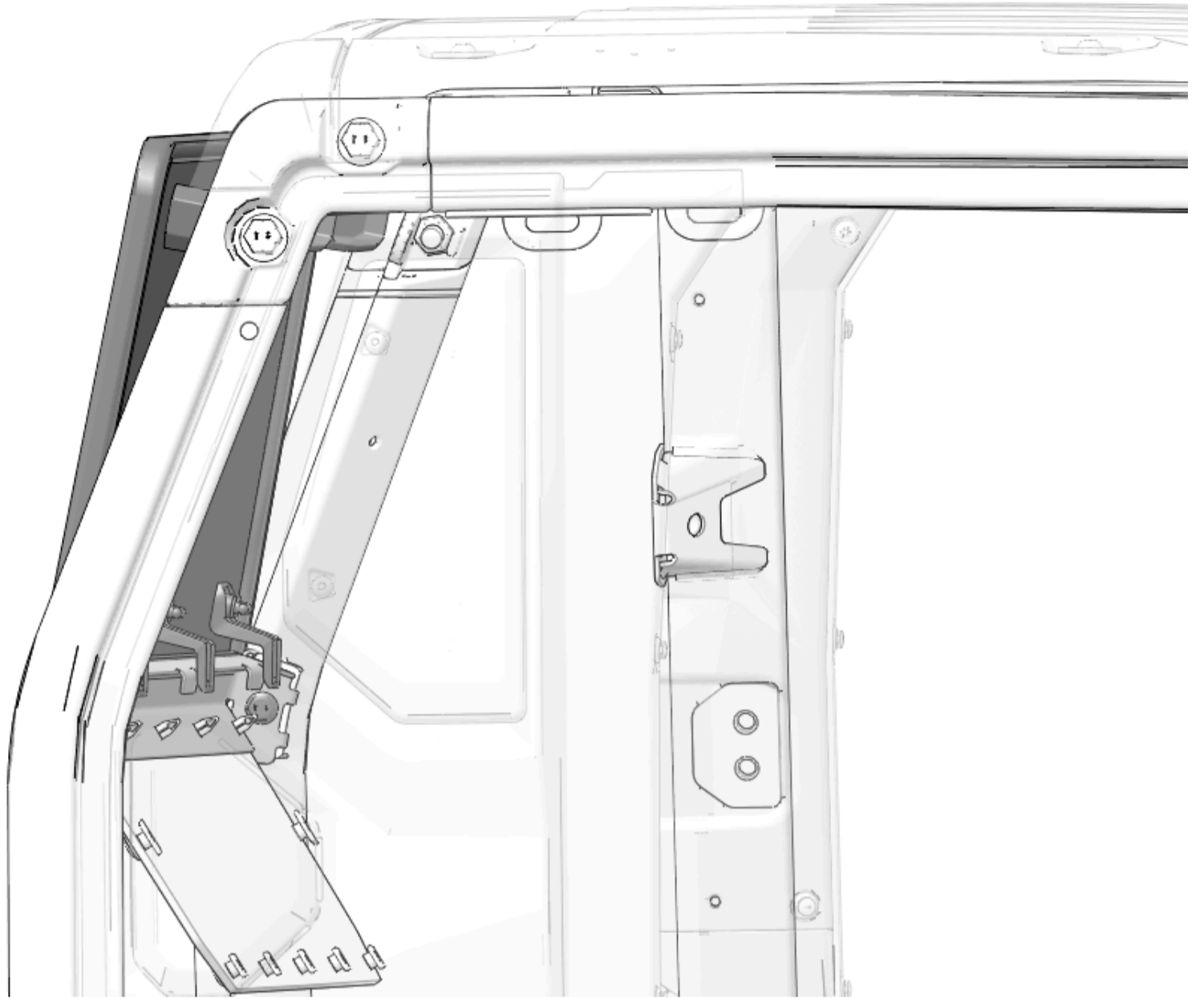
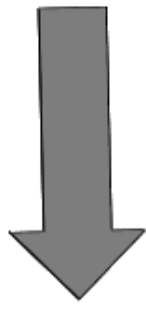

2. Tilt top of window into window frame.

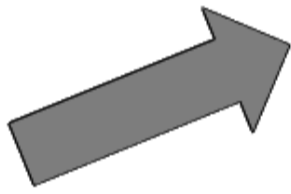

3. Turn handles upward to lock window into place.

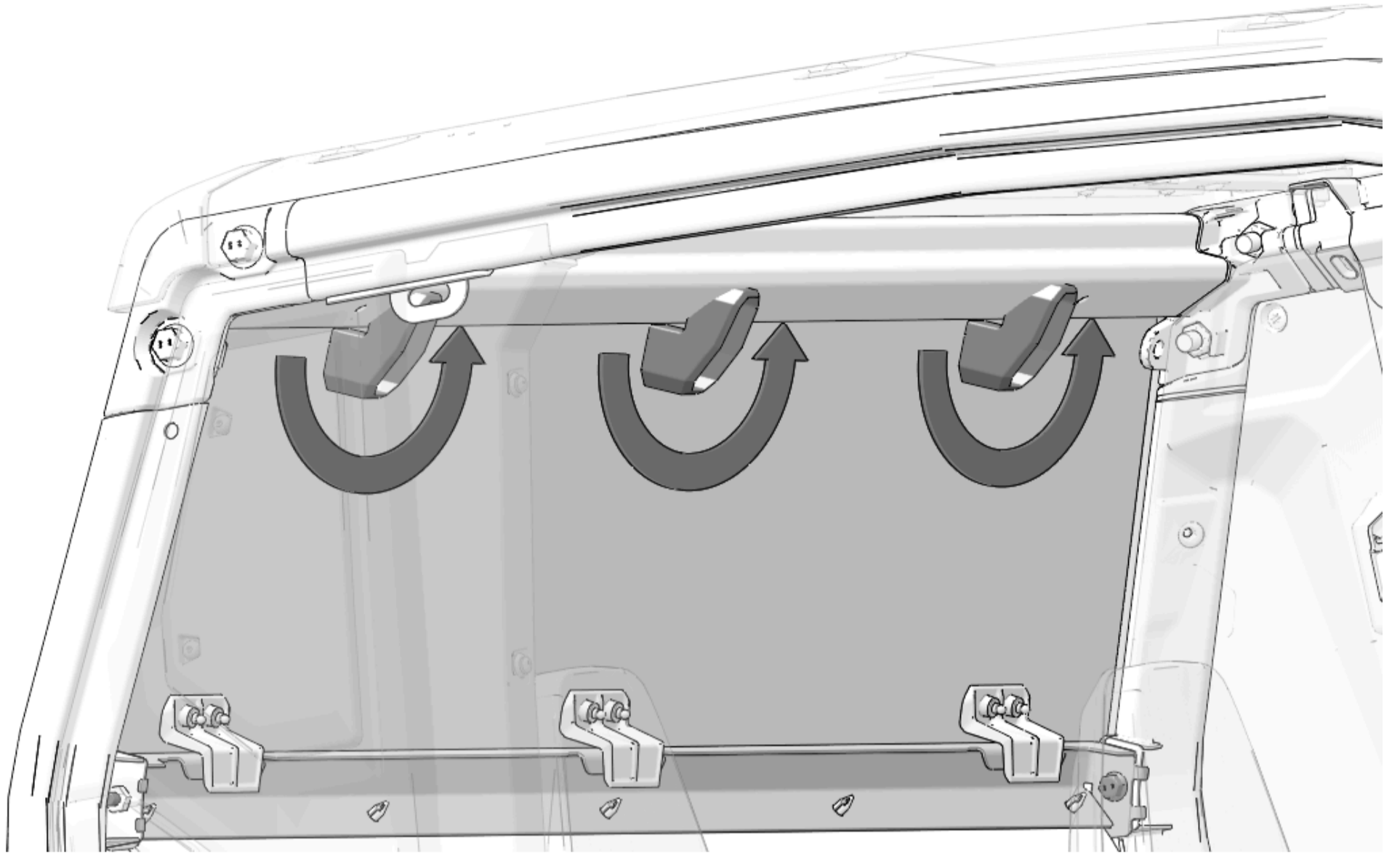

---

[Site Map](#)

[Privacy Policy](#)

[Accessibility](#)

© 2026 Polaris Inc.