

REAR BUMPER KIT



P/N 2881149

APPLICATION

ACE Models

BEFORE YOU BEGIN

Read these instructions and check to be sure all parts and tools are accounted for. Please retain these installation instructions for future reference and parts ordering information.

KIT CONTENTS

This kit includes

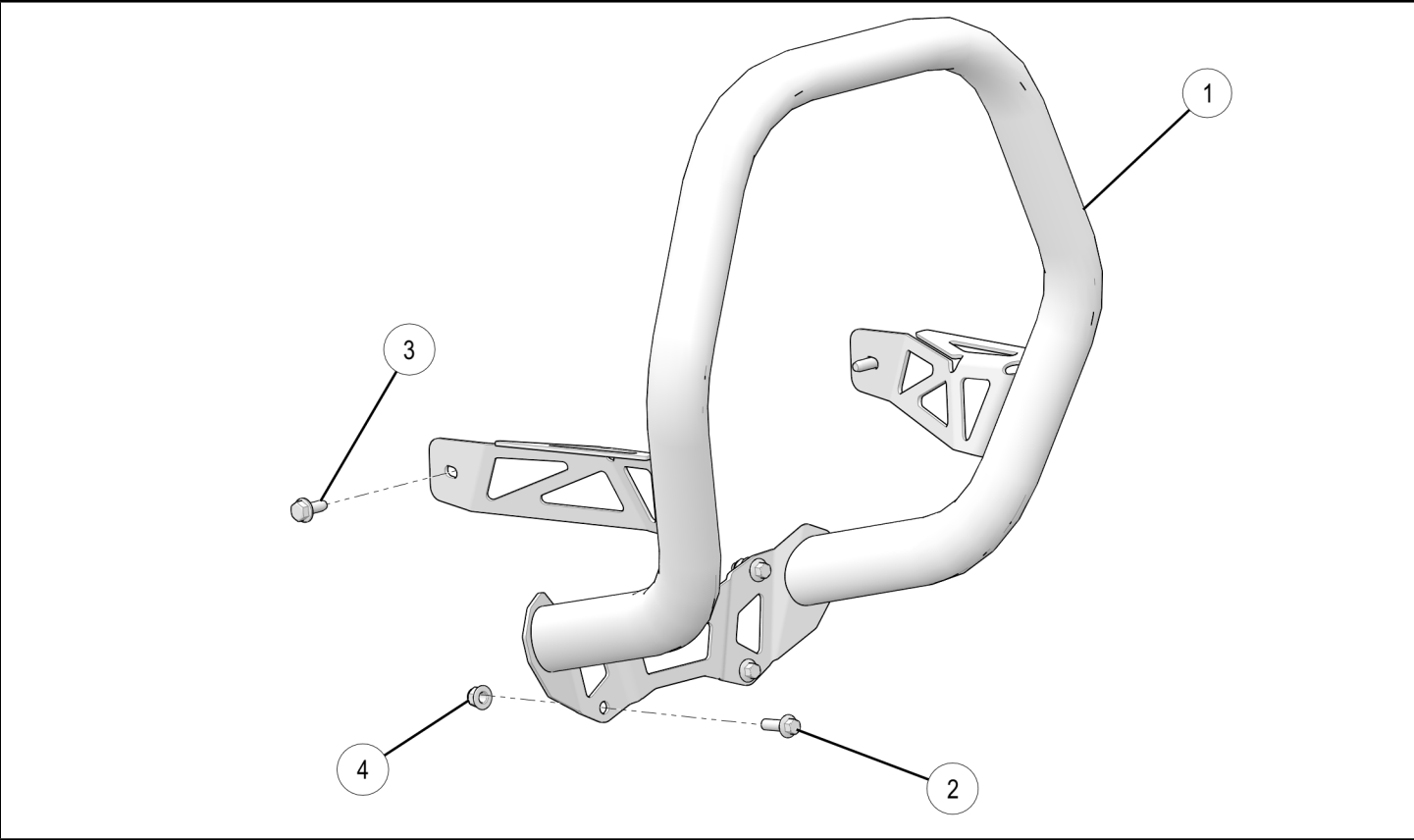

REF	QTY	PART DESCRIPTION	PART NUMBER
1	1	Rear Bumper	-
2*	4	Screw-M8X1.25X25, Hex Flange	7518488
3*	2	Self-Tapping Screw-M8X1.25X22	7519780
4*	4	Nut-M8X1.25, Flange, Nyloc-Olive D	7547332
	1	Instructions	9926264

Items marked (*) are included in Hardware Kit PN 2206041.

TOOLS REQUIRED

- 13 mm Socket/Wrench

- T-30 Torx

ASSEMBLY TIME

Approximately 10 minutes

IMPORTANT

Your REAR BUMPER KIT is exclusively designed for your vehicle. Please read the installation instructions thoroughly before beginning. Installation is easier if the vehicle is clean and free of debris. For your safety, and to ensure a satisfactory installation, perform all installation steps correctly in the sequence shown.

INSTALLATION INSTRUCTIONS

1. Put the vehicle transmission into "PARK" and turn the key to the "OFF" position. Remove the key from the vehicle.
2. Align holes on rear bumper ① with support bracket holes and install bumper using M8 self-tapping screws ③ on both sides. Drive screws in partway to secure bumper in place, but do not fully tighten yet.

NOTE

Have an assistant to hold the rear bumper while you install it.

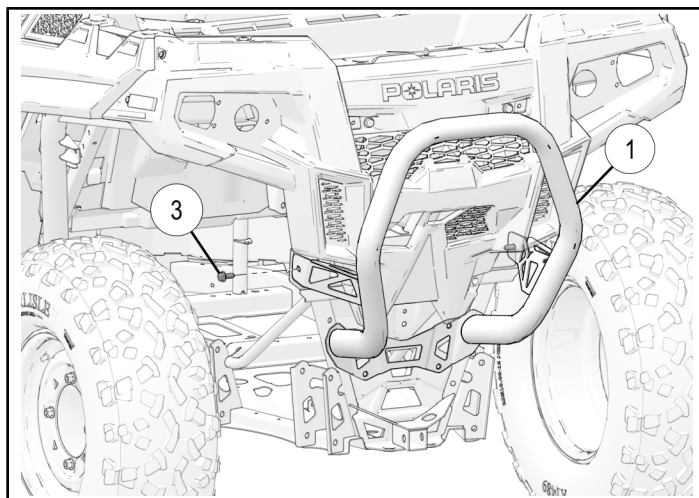

3. Repeat the same for RH side.

4. Align holes on rear bumper ① with hitch bracket holes and install four M8 screws ② and nuts ④ as shown.

TORQUE

13 ft. lbs. (17.6 Nm)

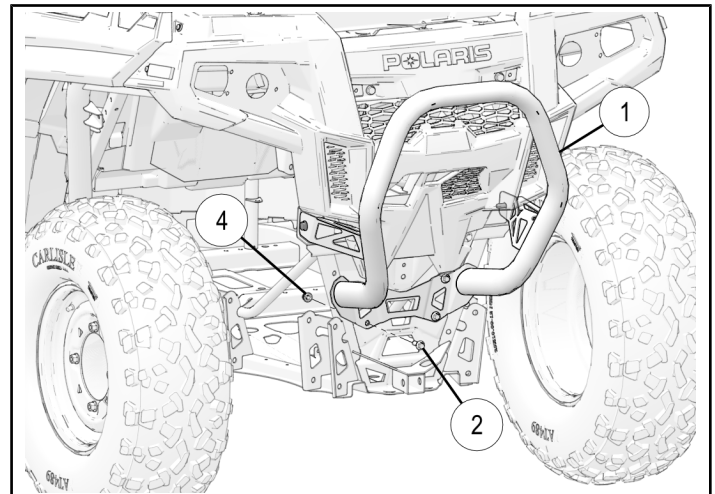

5. Tighten M8 self-tapping screws ③.

TORQUE

13 ft. lbs. (17.6 Nm)

COMPATIBILITY

Note compatibility below.

1. Storage box kit (P/N 2881447)
2. Not compatible with Cab Frame Extension kit (P/N 2881154)