

POLY TIP-DOWN WINDSHIELD KIT

POLARIS

ENGINEERED PARTS
ACCESSORIES & APPAREL

P/N 2881919

APPLICATION

Verify accessory fitment at [Polaris.com](https://www.polaris.com).

BEFORE YOU BEGIN

Read these instructions and check to be sure all parts and tools are accounted for. Please retain these installation instructions for future reference and parts ordering information.

KIT CONTENTS

This Kit includes:

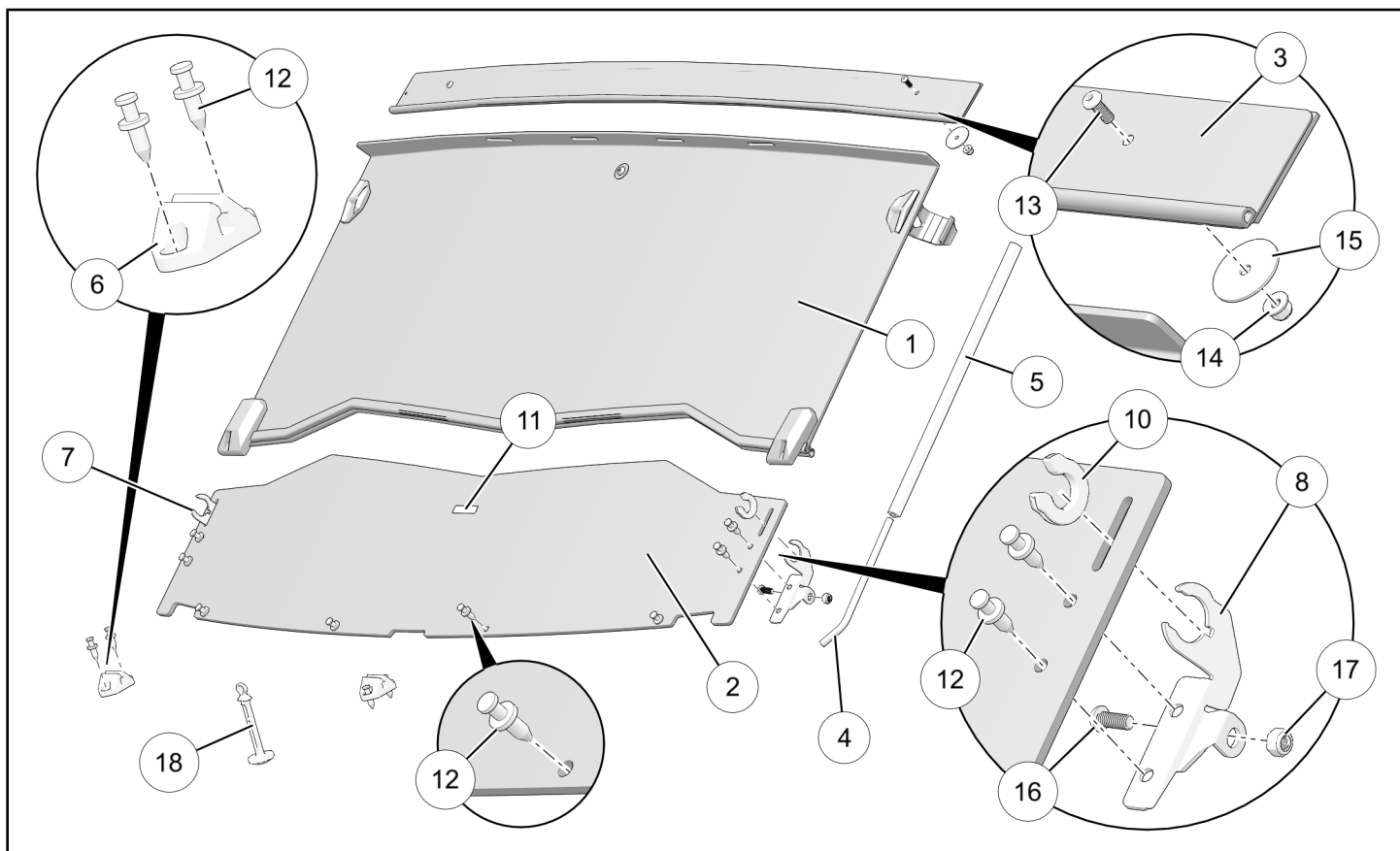

REF	QTY	PART DESCRIPTION	PART NUMBER
1	1	Windshield Panel, Upper	-
2	1	Windshield Panel, Lower	-
3	1	Trim Panel, Upper	-
4*	-	D-Seal - 3/8 wide X 5/16 thick X 18 in long (9.6 X 8.0 X 457 mm)	-
5*	-	D-Seal - 5/8 wide X 5/8 thick X 38.4 in long (15.9 X 15.9 X 975 mm)	-
6*	2	Slot Clamp	-
7*	1	Bracket, ROPS Mounting, RH	-
8*	1	Bracket, ROPS Mounting, LH	-

REF	QTY	PART DESCRIPTION	PART NUMBER
9	-	(unused)	-
10*	2	Insert, ROPS Mounting Bracket	-
11*	1	Protective Tape	-
12*	12	Rivet, Push Pin	-
13*	2	Screw, Button Head Socket - M6 X 1.00 X 16	-
14*	2	Nut, Flange, Locking - M6 X 1.00	-
15*	2	Washer, Fender - 1.5 X 0.25 X 0.059	-
16*	2	Screw, Button Head Socket - M8 X 1.25 X 20	-
17*	2	Nut, locking - M8 X 1.25	-
18*	1	Strap, Windshield Locking	-
	1	Instructions	9927045

Items marked (*) are included in Hardware Kit PN 2206302.

TOOLS REQUIRED

- Safety Glasses
- Drill
- Drill Bit: 5/16 inch (8 mm), 1/2 inch (13 mm)
- Socket Set, Hex Bit, Metric
- Pliers, Push Pin Rivet
- Socket Set, Metric
- Utility Knife/Cutting Tool
- Wrench Set, Metric

IMPORTANT

Your POLY TIP-DOWN WINDSHIELD KIT is exclusively designed for your vehicle. Please read the installation instructions thoroughly before beginning. Installation is easier if the vehicle is clean and free of debris. For your safety, and to ensure a satisfactory installation, perform all installation steps correctly in the sequence shown.

INSTALLATION INSTRUCTIONS

1. Shift vehicle transmission into "PARK". Turn ignition switch to "OFF" position and remove key from switch.
2. Vehicle preparation.
 - a. Ensure vehicle ROPS is at room temperature ($\geq 68^{\circ}\text{F}$ / 20°C).
 - b. Clean adhesive application areas on ROPS and windshield mounting sill at locations shown, then wipe dry.

NOTE

Final locations for D-seals ④ and ⑤, and upper trim adhesive ③, shown for reference only.
Do not install D-seals at this time.

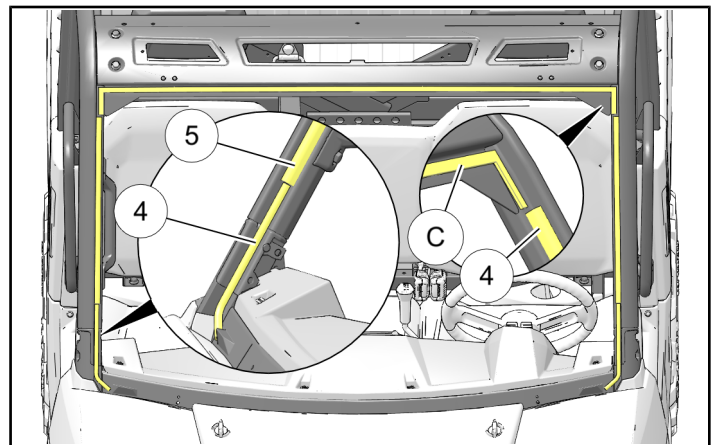

3. Attach upper trim panel

- a. With adhesive backing still attached, place upper trim panel ③ against ROPS and observe panel fitment, including edge spacing. Two fastener holes ①A in panel (located approximately 4-1/2 inches from each side) must be fully exposed below lower edge of ROPS upper mount plate ①B.

NOTE

Fasteners will be used to pinch upper trim panel to ROPS upper mount plate.

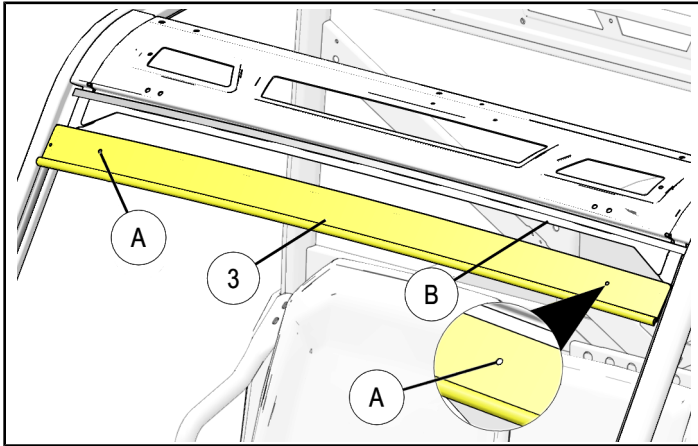

- b. Using fingers, rub adhesive backing on underside of upper trim panel ③ to activate adhesive.
- c. Peel adhesive backing from one end of upper trim panel ③, then attach panel to corner of ROPS. Continue to peel off backing as panel is gradually attached to ROPS, ensuring two fastener holes ①A are fully exposed below lower edge of ROPS upper mount plate ①B as shown. Press panel firmly in place.

TIP

Do not peel entire length of adhesive backing from panel all at once.

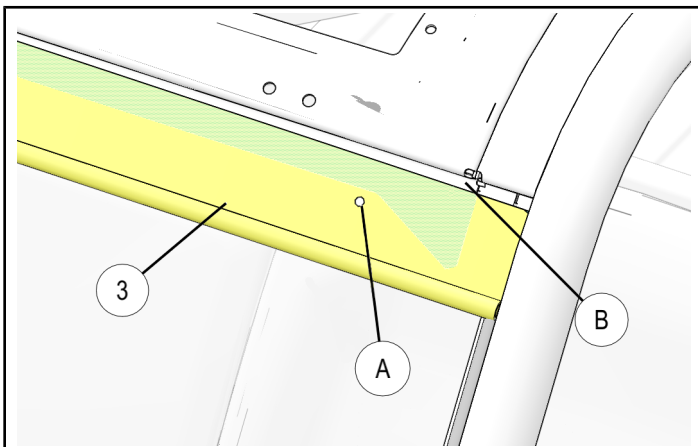

- d. Install two each screws ⑬, washers ⑮, and nuts ⑭. Tighten fasteners.

IMPORTANT

Do NOT drill holes in ROPS upper mount plate! Fasteners are only intended to pinch edge of plate.

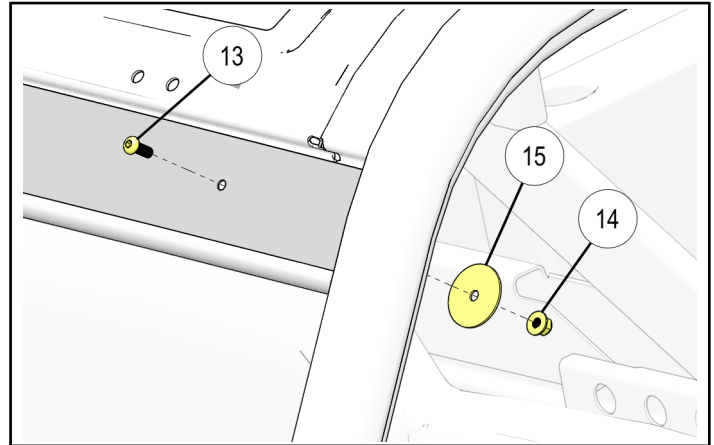

4. Cut larger D-seal ⑤ into two equal halves, each approximately 19.2 in (487 mm) long. Peel adhesive backing from one of the cut D-seals.

Butt seal up against lower edge of upper trim panel ③, then working downward, apply seal to ROPS A-pillar as shown. Trim excess length (as required). Repeat for opposite side.

NOTE

Final position of lower windshield panel ② (not yet installed) shown for reference only. Observe that lower end of D-seal will be flush with top edge of panel.

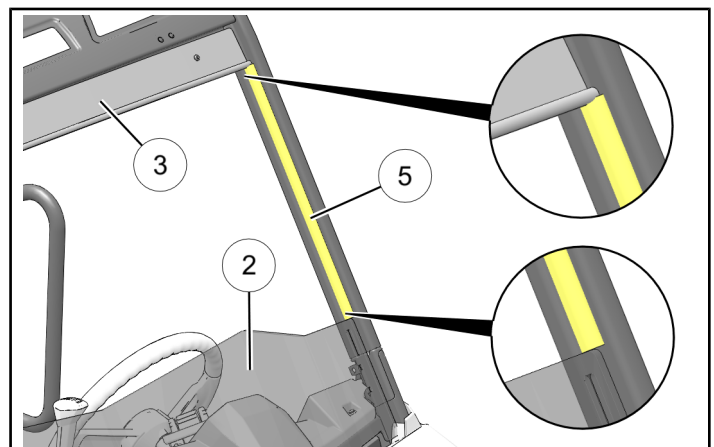

5. Cut smaller D-seal ④ into two equal halves, each approximately 9 in (228 mm) long. Peel adhesive backing from one of the cut D-seals.

Butt seal up against lower end of previously installed D-seal ⑤, then working downward, apply seal to ROPS A-pillar and inboard onto windshield mounting sill as shown. Trim excess length (as required).

NOTE

Final position of lower windshield panel ② (not yet installed) shown for reference only. Observe that joint between D-seals will occur at top edge of panel.

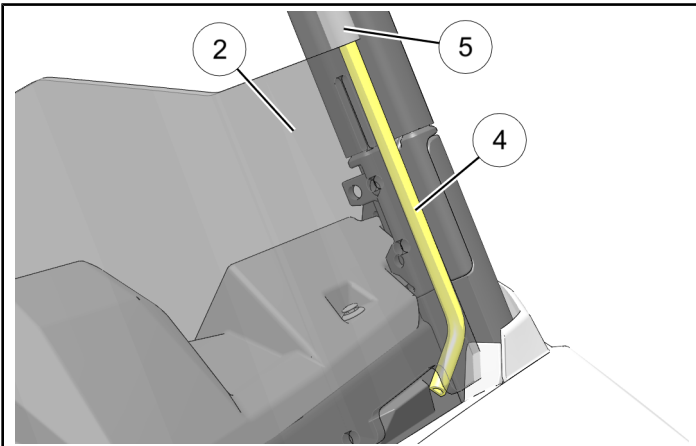

6. Install lower windshield panel.

- a. Identify LH ROPS mounting bracket ⑧. Notice differences from RH bracket ⑦.

NOTE

View looking at front of brackets.

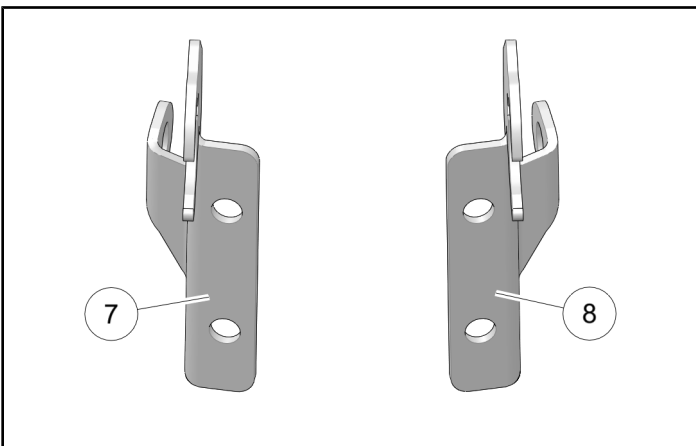

- b. Install LH ROPS mounting bracket ⑧ to lower windshield panel ② using two push pin rivets ⑫. Repeat for RH side using mounting bracket ⑦.

NOTE

LH side shown; RH side opposite. Front and rear sides of lower windshield panel are identical; it does not matter which side brackets are attached to.

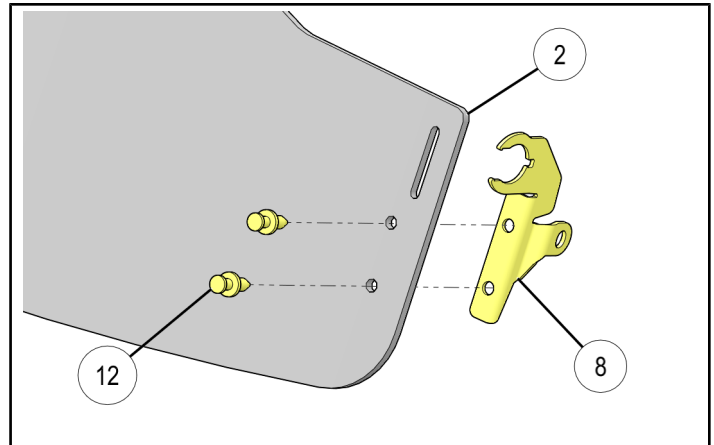

- c. Install inserts ⑩ to ROPS mounting brackets ⑦ and ⑧.

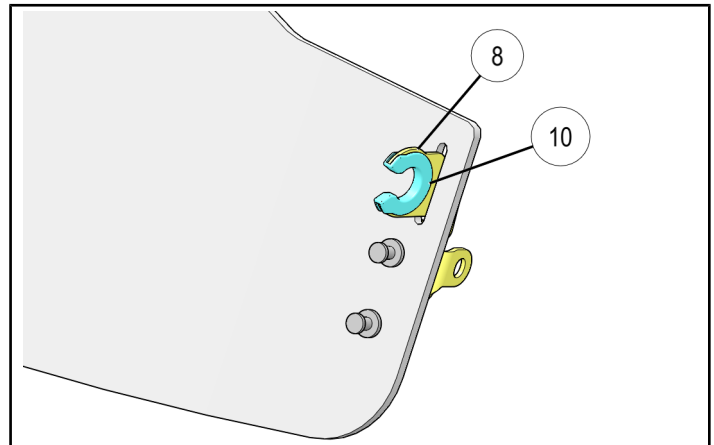

- d. Place lower windshield panel ② into ROPS, then loosely install ROPS mounting brackets ⑦ and ⑧ to ROPS fitting ears using two each screws ⑯ and nuts ⑰. Do not tighten screws at this time.

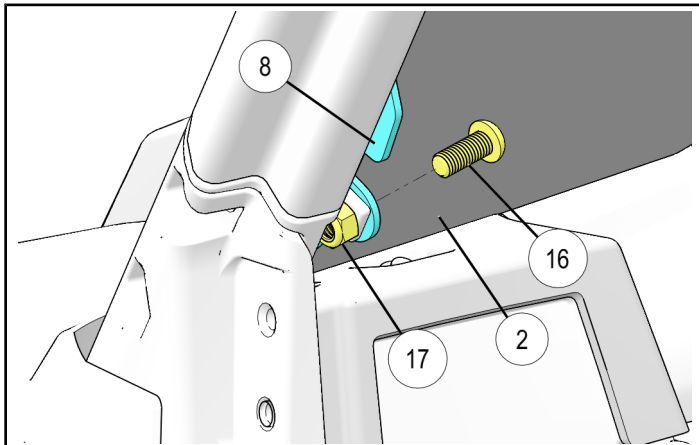

- c. Tighten two each ROPS mounting bracket screws ⑯ and nuts ⑰. See Step 6d.
8. Secure lower edge of lower windshield panel.
- a. Using lower windshield panel ② as template, mark and drill four 5/16 inch (8 mm) holes into windshield mounting sill.

IMPORTANT

Control drill depth to prevent damage to underlying structure or components.

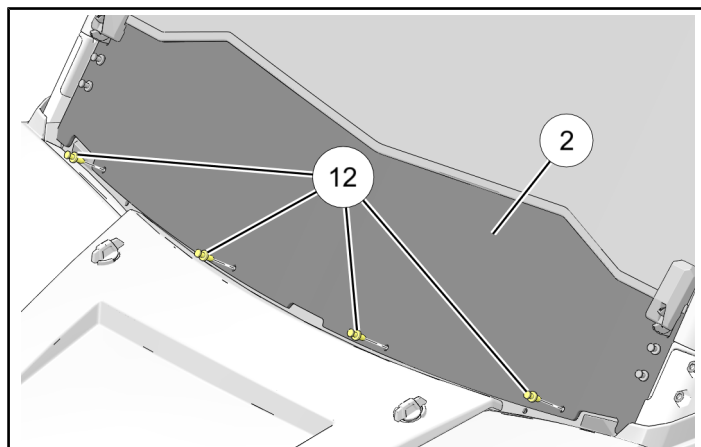

7. Install upper windshield panel.

- a. Install upper windshield panel ① to ROPS mounting brackets ⑦ and ⑧ by holding windshield perpendicular to ROPS as shown, then push into bracket inserts ⑩.

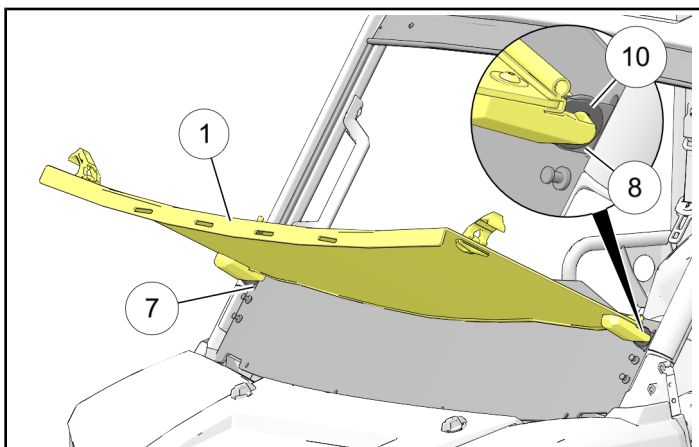

- b. Install four push-pin rivets ⑫ through panel into drilled holes.

9. Install slot clamps to hood.

- a. Install slot clamps ⑥ to upper windshield panel ① (not hood) as follows:
- Vehicles with **RECESSED** hood: Use two **OUTBOARD** slots ⑤.
 - Vehicles with **FLAT** hood: Use two **INBOARD** slots ⑥.

NOTE

Slot clamps shown installed to outboard slots ⑤.

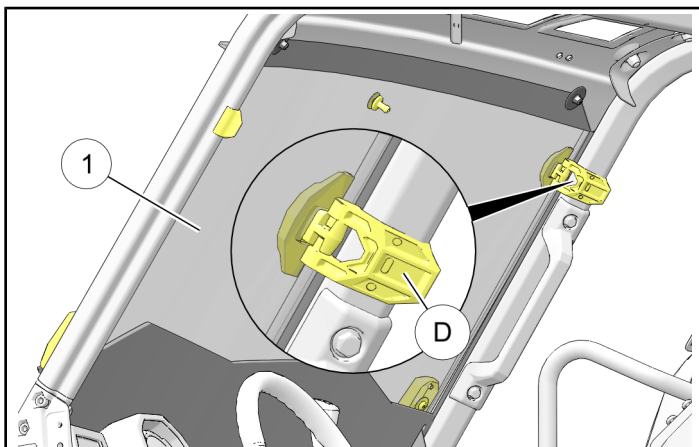
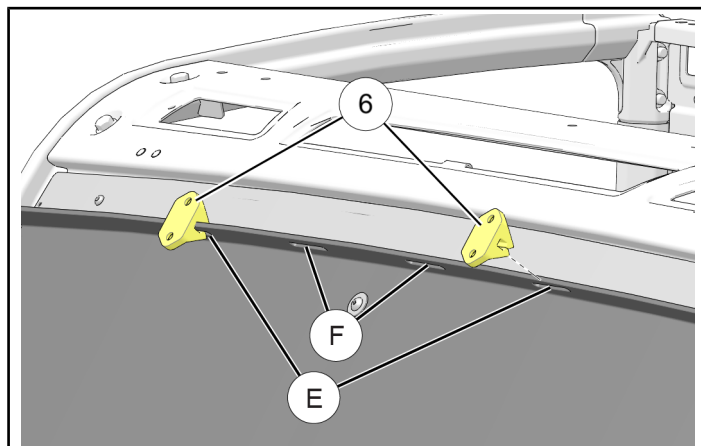

- b. Open windshield ①, gently laying slot clamps ⑥ flat against hood.
- c. Using slot clamps ⑥ as templates, carefully mark two fastener holes on hood (front hole of each clamp). Also mark hole in center of hood, immediately forward of windshield, for locking strap ⑱.

NOTE

Locking strap shown installed for reference. Strap attaches to ball stud ⑥ to secure windshield in open position.

TIP

Place tape along side each slot clamp to ensure proper alignment for next step.

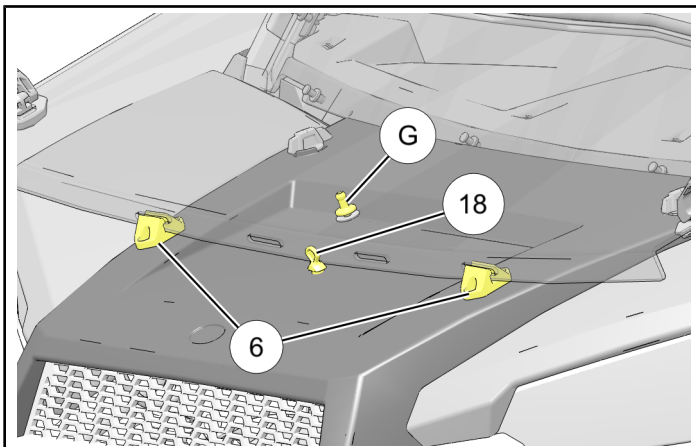

- d. Open windshield panel ①, then mark two additional fastener holes on hood (rear hole of each clamp ⑥).
- e. Remove hood.
- f. Drill four 5/16 inch (8 mm) holes at marked slot clamp locations, and one 1/2 inch (13 mm) hole at marked locking strap location.
- g. Push locking strap up through 1/2 inch (13 mm) hole.

NOTE

Keeper flange on top of strap will prevent it from falling through hole when not in use.

- h. Reinstall hood.

- i. Install two slot clamps ⑥ to hood using four push pin rivets ⑫.

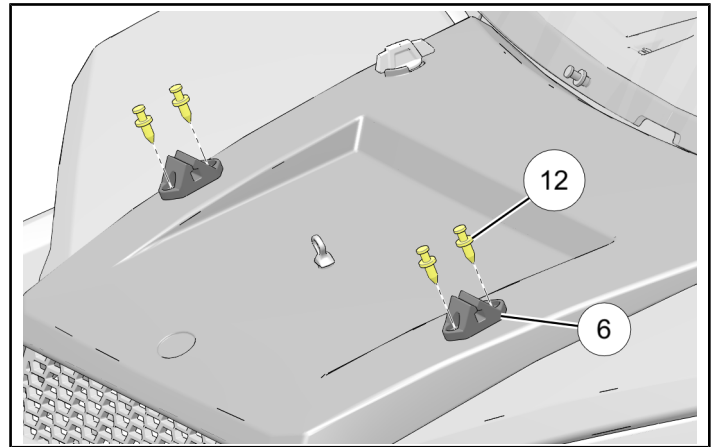

10. With windshield fully open and locked into slot clamps ⑥, observe location where center of upper windshield panel ① contacts center of lower windshield panel ②. Install protective tape ⑪ to lower windshield panel at that location.

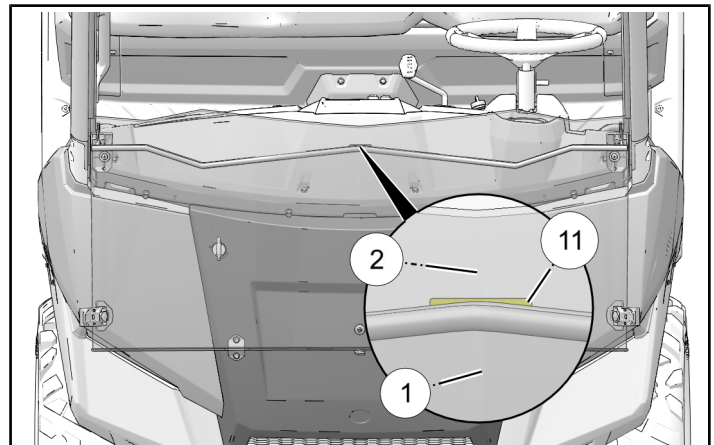

11. OPTIONAL: To remove windshield, rotate until perpendicular to ROPS as shown in Step 8, then pull windshield out of bracket inserts ⑩.

⚠ WARNING

If transporting vehicle in non-enclosed trailer, then windshield must either be removed, or placed in the following configuration:

- If vehicle is trailered facing FORWARD windshield must be CLOSED and LOCKED to A-pillars.
- If vehicle is trailered facing REARWARD windshield must be OPEN and LOCKED to hood.

Failure to comply may allow airflow, vibration, or other factors to separate windshield from vehicle and cause an accident, resulting in serious personal injury or death.

FEEDBACK FORM

A feedback form has been created for the installer to provide any comments, questions or concerns about the installation instructions. The form is viewable on mobile devices by scanning the QR code or by clicking [HERE](#) if viewing on a PC.

FEEDBACK FORM

