



**EXTREME REAR BUMPER
KIT PN 2878842**

Applications:

All 2013 and newer Ranger 900 models

Before you begin, read these instructions and check to be sure all parts and tools are accounted for. Please retain these installation instructions for future reference and parts ordering information.

The contents of this kit include:

<u>Ref.</u>	<u>Qty</u>	<u>Part Description</u>	<u>Ref.</u>	<u>Qty</u>	<u>Part Description</u>
①	8	M8-1.25 X 20 mm Hex Flange Bolt	⑨	2	Support
②	16	1/8" Pop Rivet	⑩	1	Left Section
③	4	M8-1.25 X 20 mm Carriage Bolt	⑪	1	Right Section
④	2	M8-1.25 X 85 mm Carriage Bolt	⑫	1	Cover
⑤	14	M8-1.25 Nylock Flange Nut	⑬	1	Hinge
⑥	12	M6-1.0 X 16 mm Flanged Machine Screw	⑭	1	Latch
⑦	1	Middle Section	⑮	1	Cap
⑧	1	Trim			

Tools Required: 13 mm Open-end Wrench or Socket, 4 mm Allen Key

IMPORTANT: Your Polaris Bumper is designed exclusively for your vehicle. Please read the installation instructions thoroughly before beginning. For your safety and to ensure a satisfactory installation, perform all installation steps correctly and in the sequence shown. Installation is easier if the vehicle is clean and free of debris.

Approximate Installation Time: 45 minutes

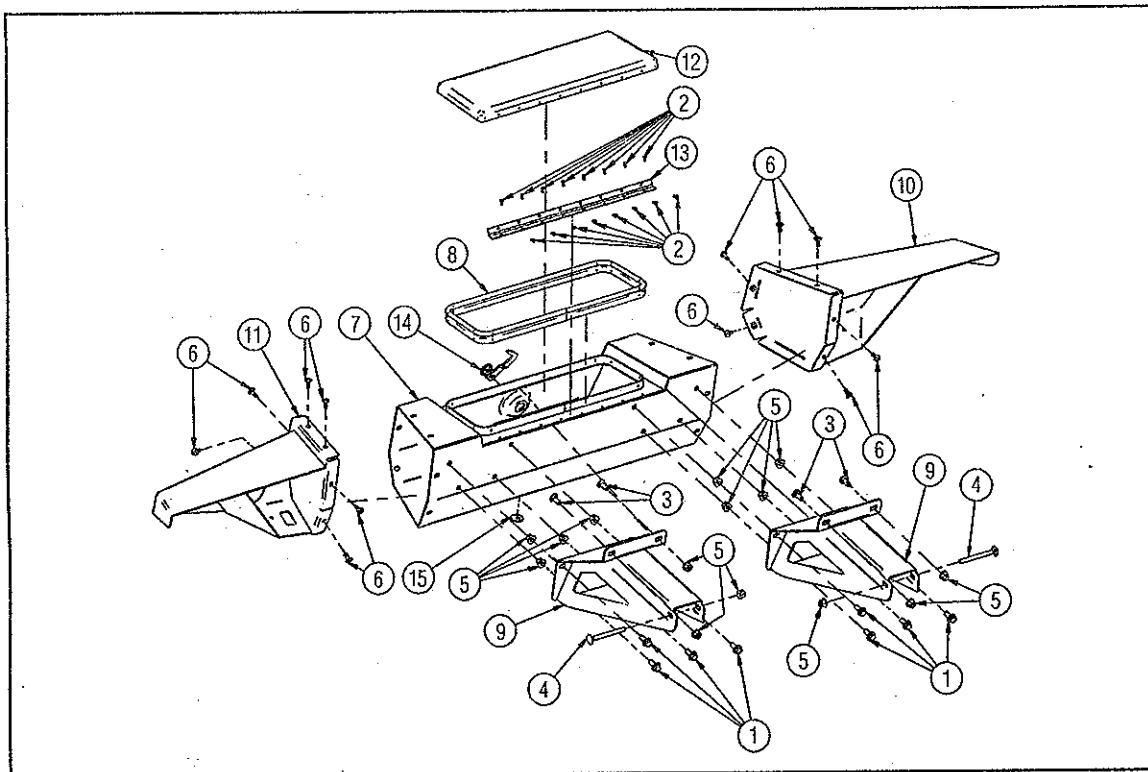



EXTREME REAR BUMPER KIT PN 2878842

INSTALLATION INSTRUCTIONS

1. Position and fasten the front part of the (2) supports (9) to frame using (2) M8-1.25 X 85 mm carriage bolts (4) and (2) M8-1.25 nylock flange nuts (5) (finger tighten at this time).
2. Fasten the rear part of the (2) supports (9) onto the bottom edge of the box using (4) M8-1.25 X 20 mm carriage bolts (3) and (4) M8-1.25 nylock flange nuts (5) (finger tighten at this time).
5. Assemble the left (10) and right (11) sections onto the middle section (7) using the (12) M6-1.0 X 16 mm flanged machine screws (6).

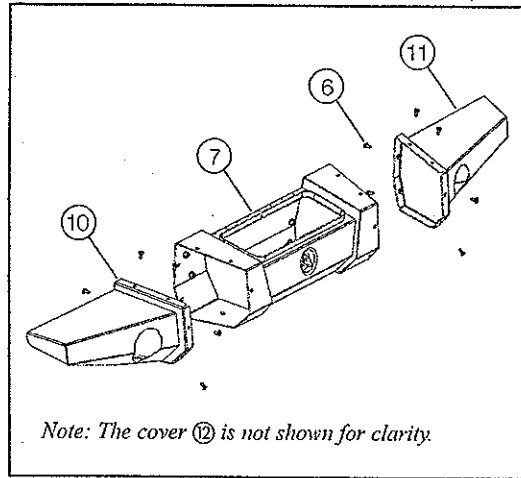
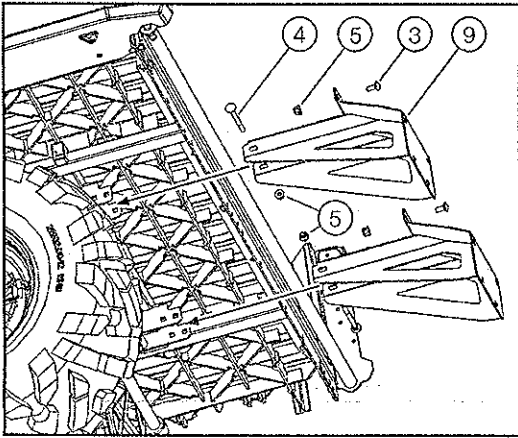

3. Position and fasten the middle section (7) onto the (2) supports (9) using (8) M8-1.25 X 20 mm hex flange bolts (1) and (8) M8-1.25 nylock flange nuts (5) (finger tighten at this time).
4. Tighten firmly all bolts and nuts.

