

HIGH COVERAGE SKID PLATE KIT



P/N 2882748

APPLICATION

Verify accessory fitment at Polaris.com.

BEFORE YOU BEGIN

Read these instructions and check to be sure all parts and tools are accounted for. Please retain these installation instructions for future reference and parts ordering information.

KIT CONTENTS

This Kit includes:

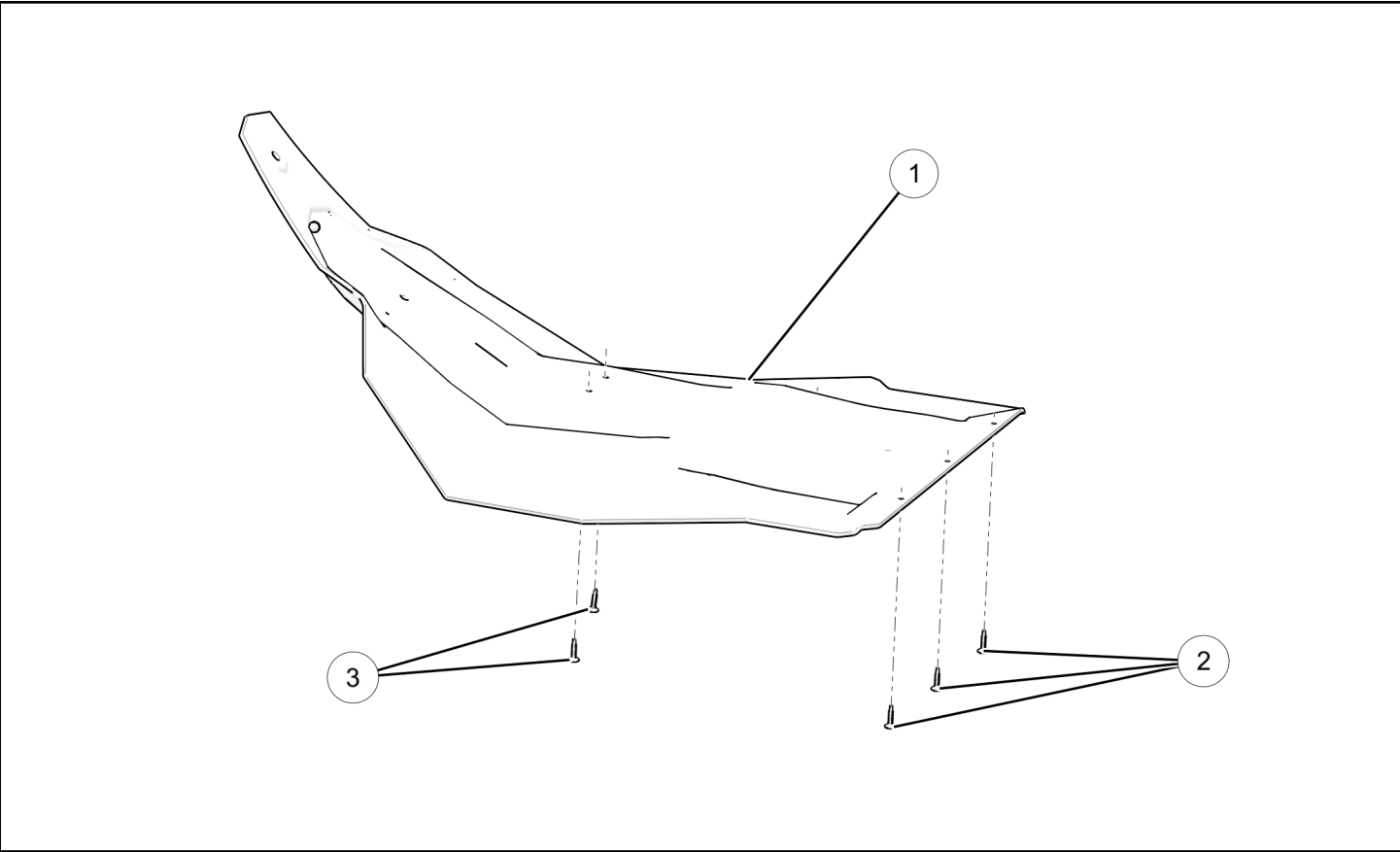

REF	QTY	PART DESCRIPTION		PART NUMBER
1	1	High Coverage Skid Plate		5454131-070
2	3	Screw — 1/4-14 X 1"		-
3	2	Screw — 10-16 X 1"		-
	1	Instructions		9927914

TOOLS REQUIRED

- Safety Glasses
- Socket Set, Torx® Bit
- Socket Set, Metric
- Wrench Set, Metric

IMPORTANT

Your High Coverage Skid Plate Kit is exclusively designed for your vehicle. Please read the installation instructions thoroughly before beginning. Installation is easier if the vehicle is clean and free of debris. For your safety, and to ensure a satisfactory installation, perform all installation steps correctly in the sequence shown.

ASSEMBLY TIME

Approximately 18 minutes

NOTE

Additional time may be required for optional steps, or to accommodate other installed accessories.

INSTALLATION INSTRUCTIONS

1. Remove both side panels.

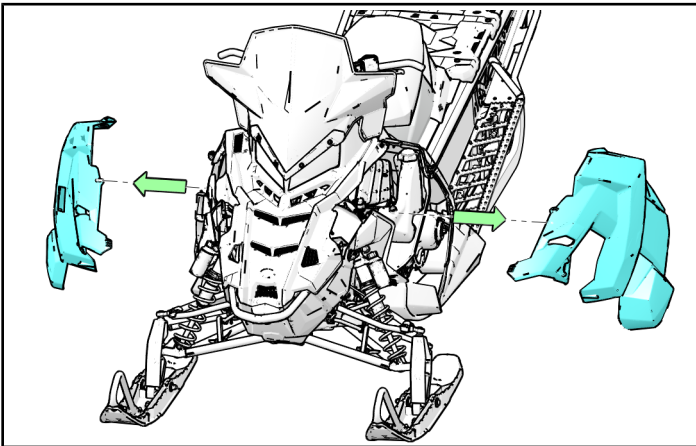

2. Unplug hood harness (A) and remove hood.

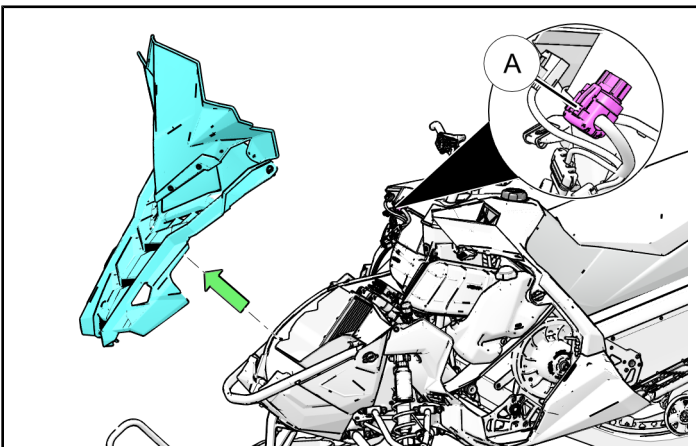

3. Remove the three front bumper fasteners (B) as shown. Retain fasteners for later installation.

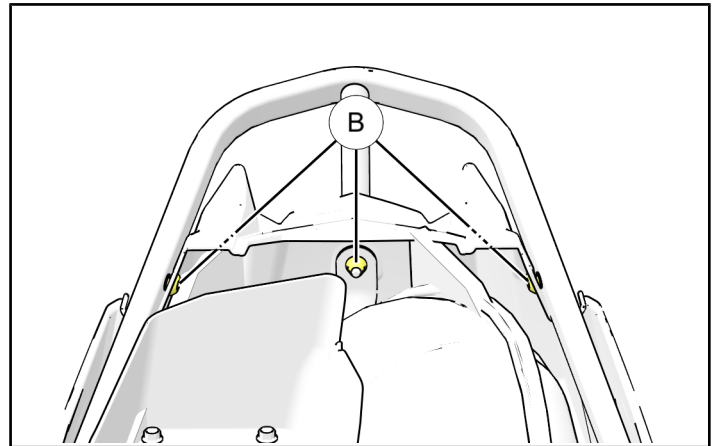

4. Loosen the two rear bumper mounting fasteners (C) but do not remove.

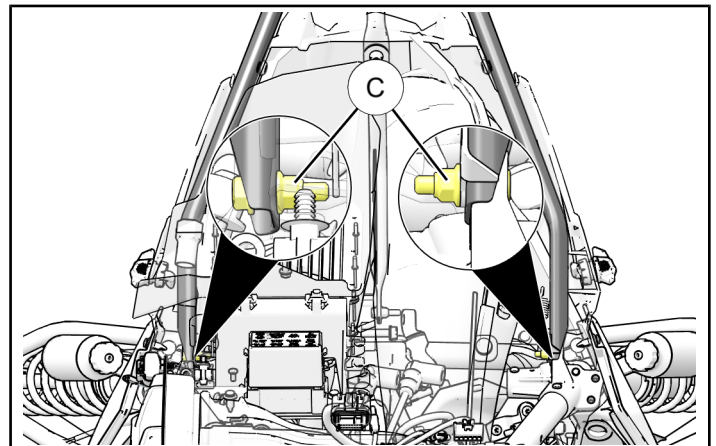

5. Rotate vehicle onto its right side to gain access to the underside of the vehicle.

⚠ WARNING

Use extreme care when rotating vehicle onto the side. Be sure the vehicle is on a suitable surface that is flat and stable before rotating and slowly rotate to avoid over centering the vehicle. Failure to comply could result in severe injury or death.

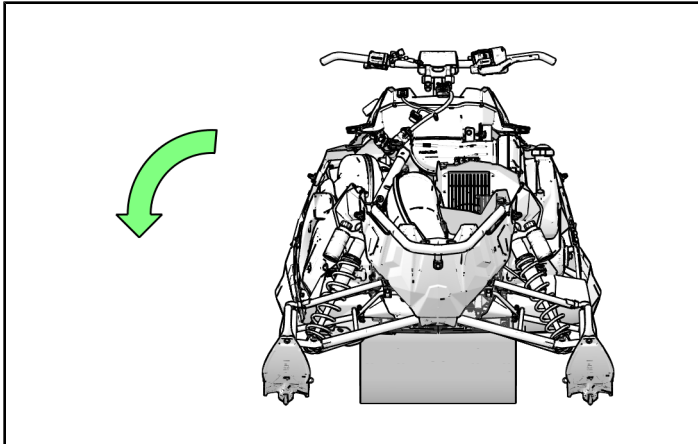

6. Position the High Coverage Skid Plate under the front bumper mounting tab ① as shown and insert the original center bumper mounting bolt ② and loosely install the nut you previously removed onto bumper mounting bolt.

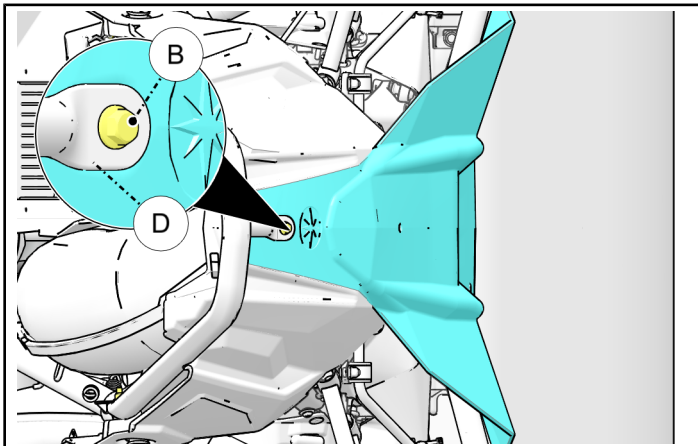

7. Install the three smaller self drilling screws ② in the rear of the skid plate as shown.

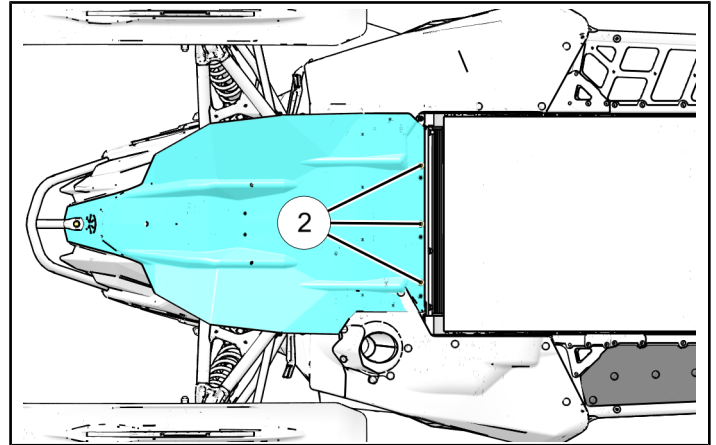

8. Install the two larger self drilling screws ③ into the middle of the skid plate as shown.

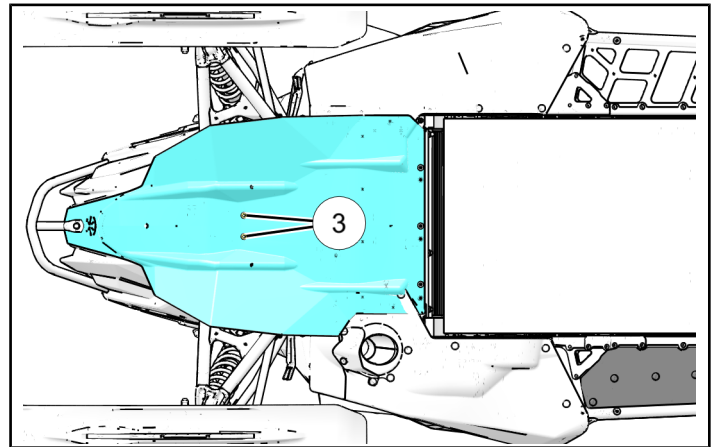

9. Rotate vehicle back on skis.
10. Reinstall all of the remaining front bumper hardware you previously loosened or removed and torque to below specification.

TORQUE

20 ft/lbs (27 Nm)

11. Replace hood and reconnect hood harness plug.
12. Replace side panels.
13. Ensure all tools are accounted for and all steps have been completed.

FEEDBACK FORM

A feedback form has been created for the installer to provide any comments, questions or concerns about the installation instructions. The form is viewable on mobile devices by scanning the QR code or by clicking [HERE](#) if viewing on a PC.

FEEDBACK FORM

