

ROOF KIT



P/N 2883274, 2883277

APPLICATION

Verify accessory fitment at Polaris.com.

BEFORE YOU BEGIN

Read these instructions and check to be sure all parts and tools are accounted for. Please retain these installation instructions for future reference and parts ordering information.

KIT CONTENTS

Roof Kit PNs 2883274 and 2883277 include:

NOTE

Roof Kit PNs 2883274 and 2883277 also include Roof Seal Kit PN 2883276 (with separate instructions).

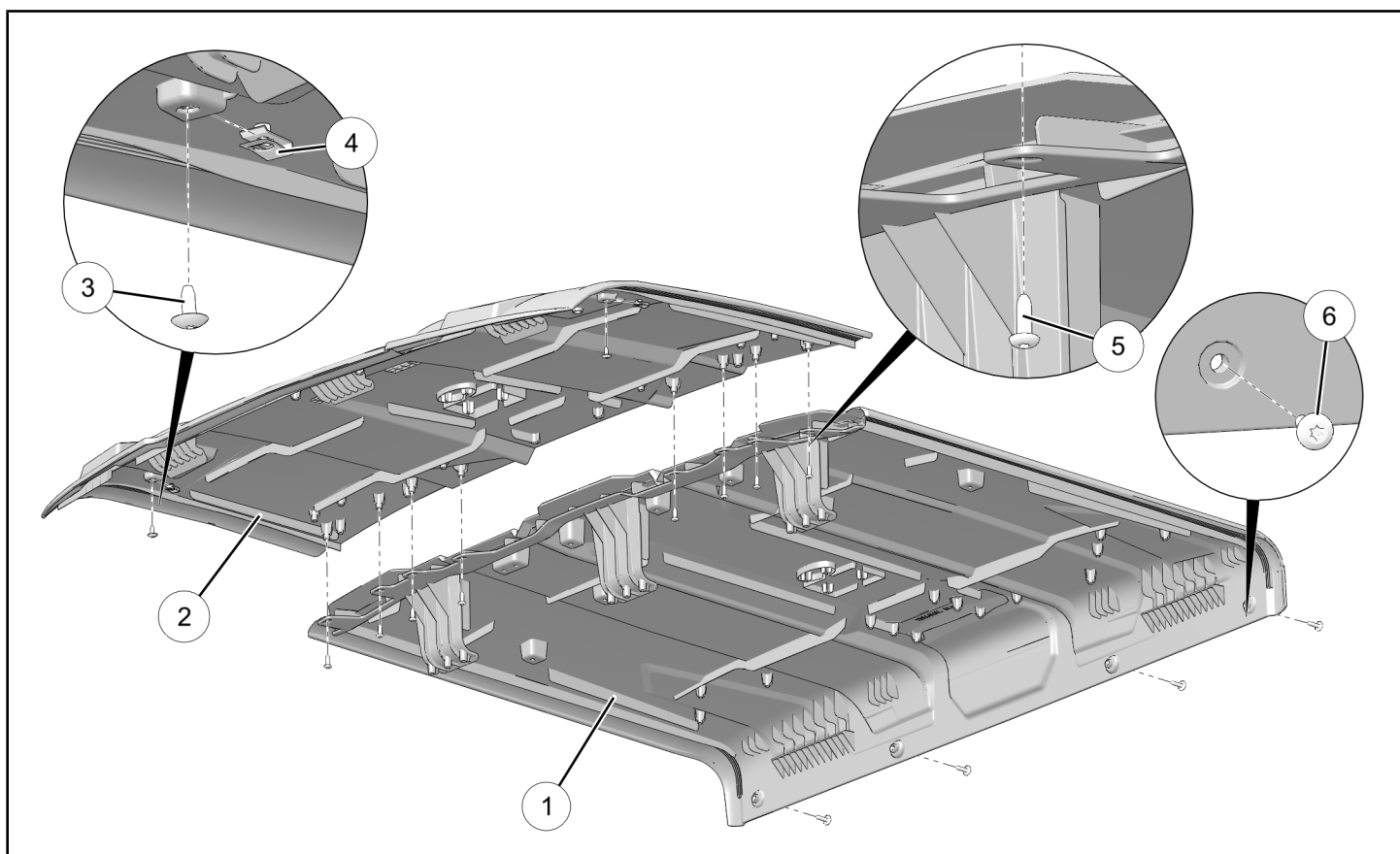

REF	QTY	PART DESCRIPTION	PART NUMBER
1	1	Panel, Roof, Front, Black (Kit 2883274 only)	-
	1	Panel, Roof, Front, Camo (Kit 2883277 only)	-
2	1	Panel, Roof, Rear, Black (Kit 2883274 only)	-
	1	Panel, Roof, Rear, Camo (Kit 2883277 only)	-
3	2	Screw, Torx® Truss Head - M6 X 1.0 X 15	7519092
4	2	Nut, Clip	7081657
5	8	Screw, Torx® Truss Head, High/Low - #14 X 3/4	7519045

REF	QTY	PART DESCRIPTION	PART NUMBER
6	4	Screw, Torx® Truss Head - M6 X 1.0 X 25	7519650
7	1	Roof Seal Kit (not shown)	2883276
	1	Instructions	9928614

Roof Kit PN 2883277 also includes the following roof liner parts:

NOTE	
Roof Liner Kit PN 2883457 also sold separately.	

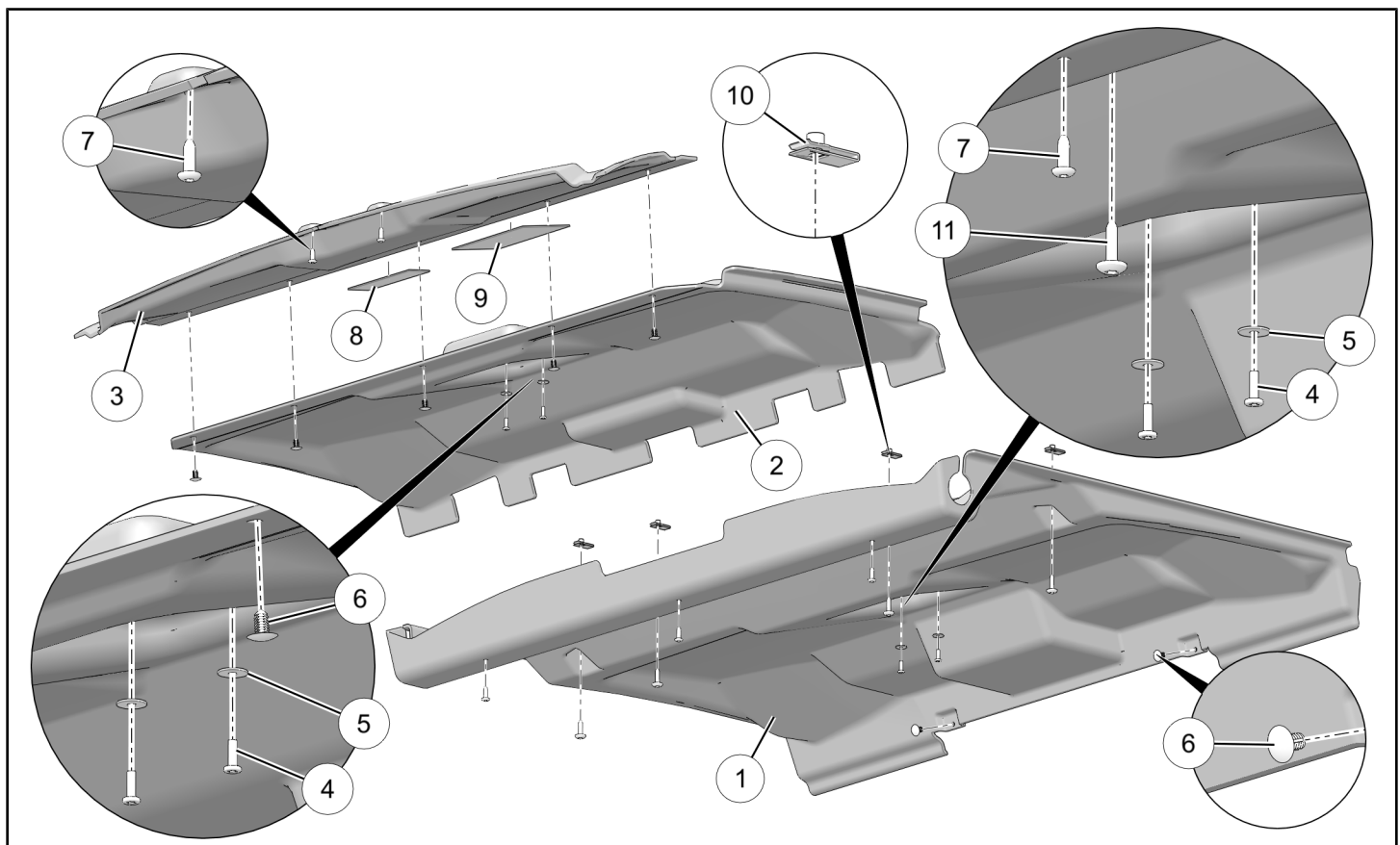

REF	QTY	PART DESCRIPTION	PART NUMBER
1	1	Liner, Roof, Rear	5814814
2	1	Liner, Roof, Mid	5814726
3	1	Liner, Roof, Front	5814774
4	4	Screw, Torx® Pan Head, High/Low - #10 X 5/8	7518238
5	4	Washer - 0.20 X 0.67 X 0.048	7556034
6	7	Push Dart	7670088
7	5	Screw, Torx® Truss Head, High/Low - #14 X 3/4	7519045
8	1	Decal, Warning, Payload	7189382
9	1	Decal, Warning, General Use	7188575

REF	QTY	PART DESCRIPTION	PART NUMBER
10	4	Nut, Clip	7081657
11	4	Screw, Torx® Truss Head - M6 X 1.0 X 25	7519650

TOOLS REQUIRED

- Safety Glasses
- Screwdriver Set, Torx®
- Socket Set, Torx® Bit
- Torque Wrench

IMPORTANT

Your Roof Kit is exclusively designed for your vehicle. Please read the installation instructions thoroughly before beginning. Installation is easier if the vehicle is clean and free of debris. For your safety, and to ensure a satisfactory installation, perform all installation steps correctly in the sequence shown.

ASSEMBLY TIME

Approximately 15 minutes

NOTE

Additional time will be required to install Roof Seal Kit, roof liner (PN 2883277 only), or to accommodate other accessories.

INSTALLATION INSTRUCTIONS

INSTALL ROOF PANELS

1. Shift vehicle transmission into "PARK". Turn ignition switch to "OFF" position and remove key.
2. Install Roof Seal Kit PN 2883276 (included) per separate instructions in that kit.
3. Install two clip nuts ④ to standoffs at front of roof panel ①. Ensure proper orientation: Threaded portion of clip nut is located INSIDE standoff.

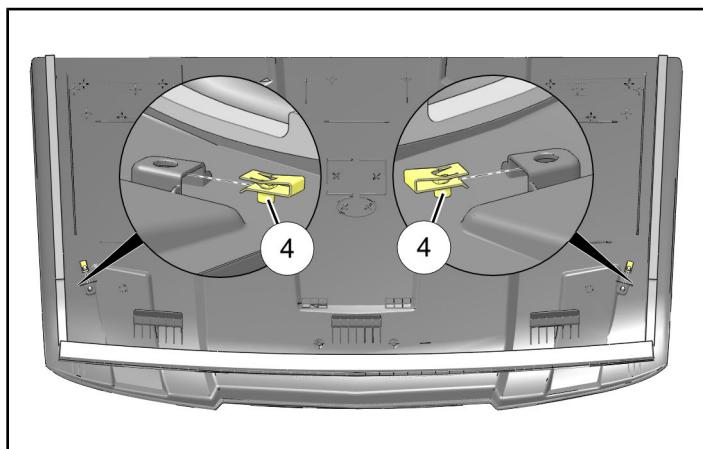

4. Hold rear panel ① at slight angle above ROPS as shown. Snap three hooks (A) into B-pillar cross member (B). Lower rear of panel, snapping two tabs (D) into C-pillar cross member (C).

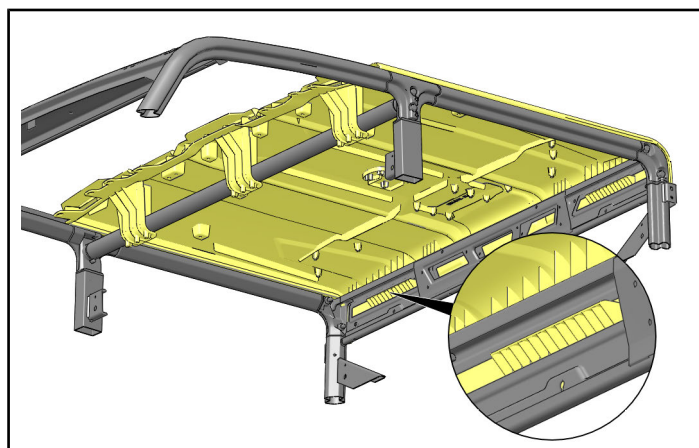
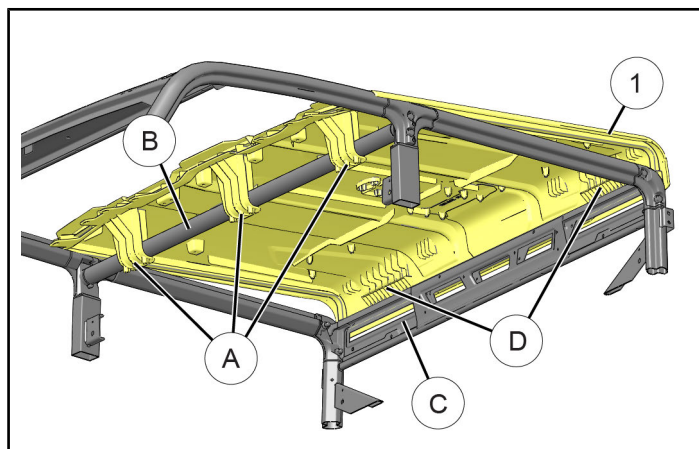

5. Hold front panel ② at slight angle above ROPS as shown. Insert rear edge of front panel ② into channel on front edge of rear panel ①.

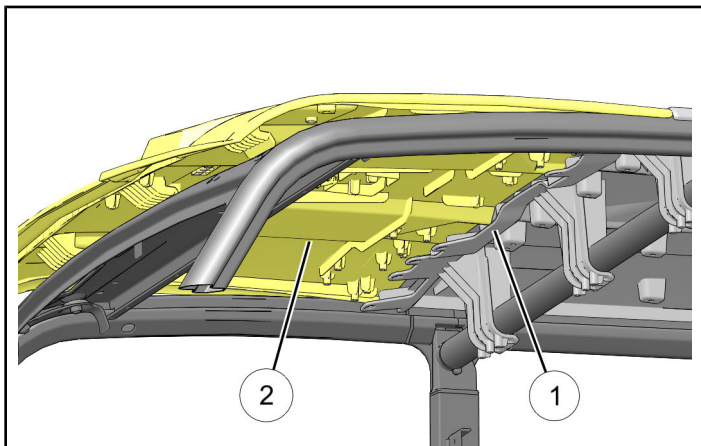

6. Lower front of panel ②, inserting three hooks ⑤ through openings in ROPS visor ⑥, then slide panel rearward until hooks lock into visor.

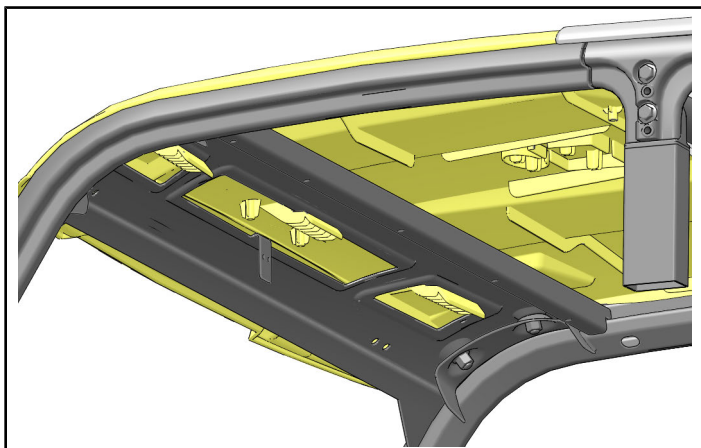
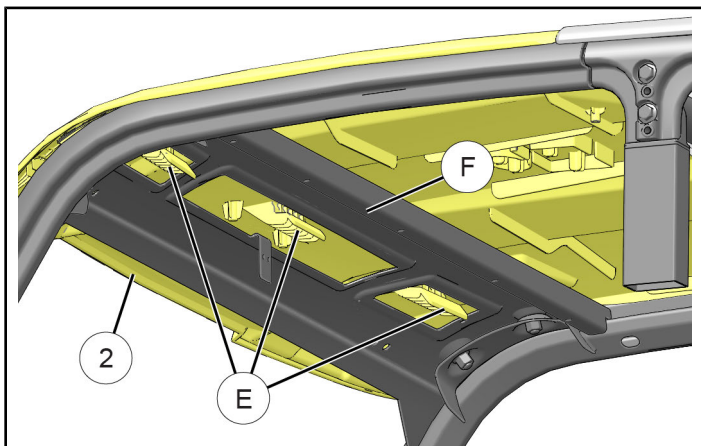

7. Secure rear panel ① to front panel ② using eight screws ⑤.

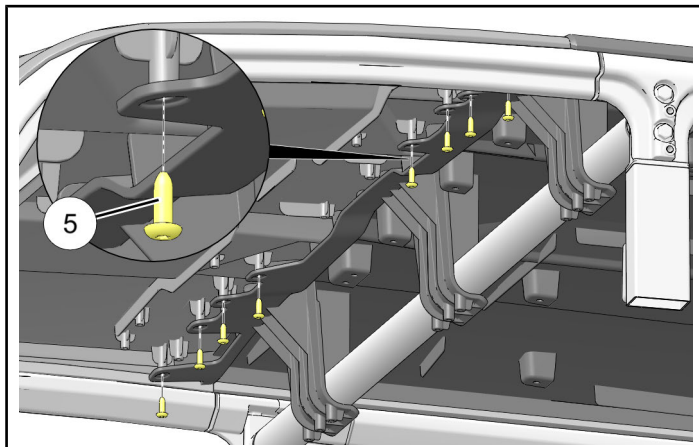

8. Secure rear panel ① to C-pillar cross member ③ using four screws ⑥.

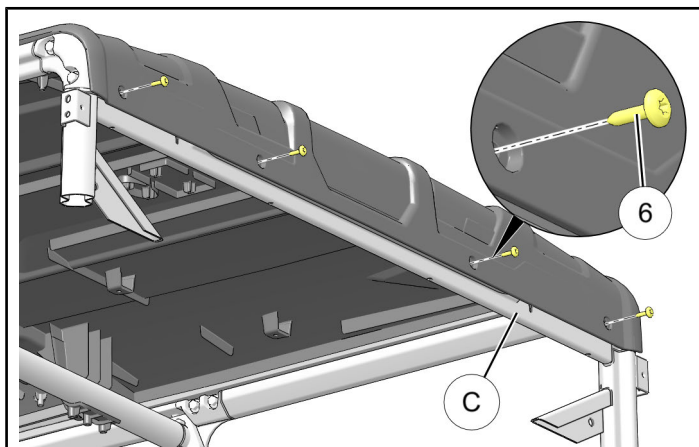

9. Secure front panel ② to ROPS visor using two screws ③.

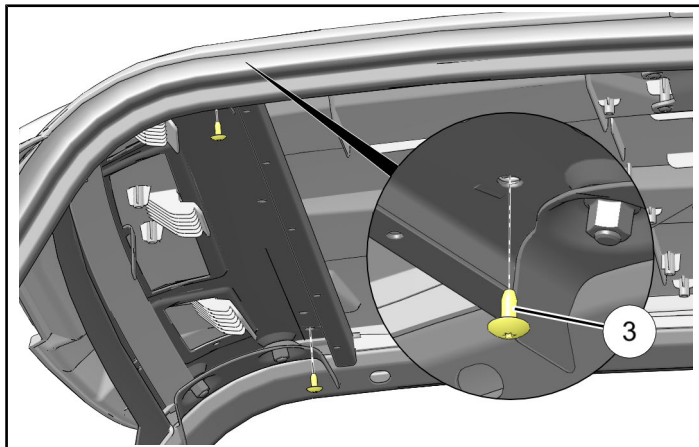

10. Torque all screws to specification.

TORQUE

M6 screws ③ and ⑥: 42 in. lbs. (4.7 Nm) \pm 10%
 #14 screws ⑤: 20 in. lbs. (2.3 Nm) \pm 10%

⚠ WARNING

If transporting vehicle in non-enclosed trailer then vehicle must FACE FORWARD, or roof must be removed.

Failure to comply may allow airflow, vibration, or other factors to separate roof from vehicle and cause an accident, resulting in serious personal injury or death.

INSTALL ROOF LINERS

NOTE

This section applicable to Roof Kit PN 2883277 only.

1. OPTIONAL: If installing interior light and/or rear speakers (accessories sold separately), then modify mid liner ② and/or rear liner ① as follows:
 - Light: Cut oval or rectangular opening ① (as required) to accommodate light. Install light and electrical harness per instructions included with accessory.
 - Speakers: Cut circular openings ② (as required) and open associated fastener holes. Install speakers and electrical harness per instructions included with accessory.

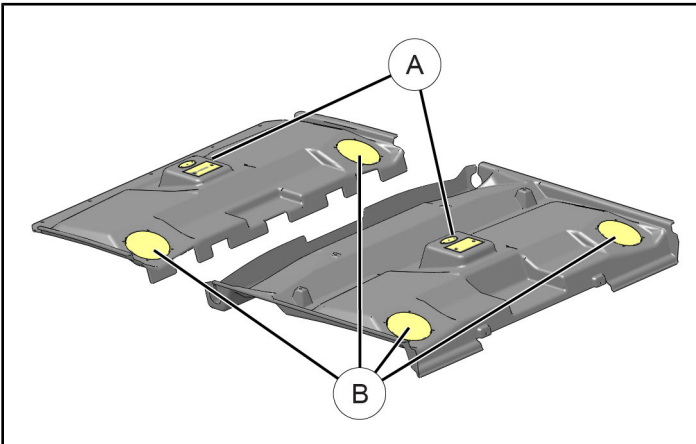

2. Loosely install front liner ③ to ROPS visor using two screws ⑦.

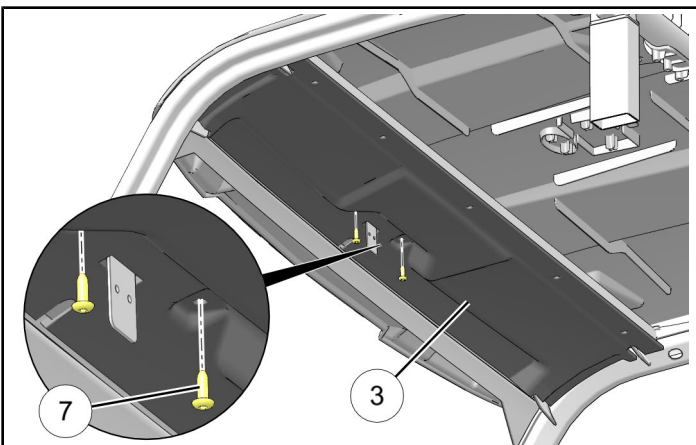

3. If installing optional light, then refer to instructions included with light. Otherwise, loosely install two each screws ④ and washers ⑤ through mid liner ② into roof panel.

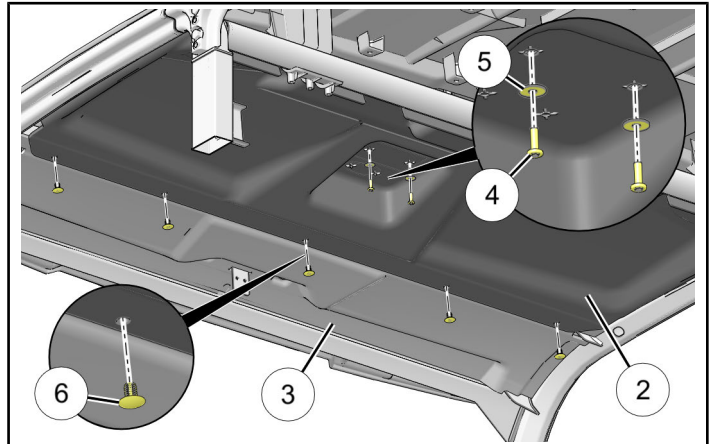

4. Install mid liner ② to front liner ③ and ROPS visor using five push darts ⑥.
5. Install four clip nuts ⑩ to standoffs in rear roof panel. Ensure proper orientation: Threaded portion of clip nut is located INSIDE standoff.

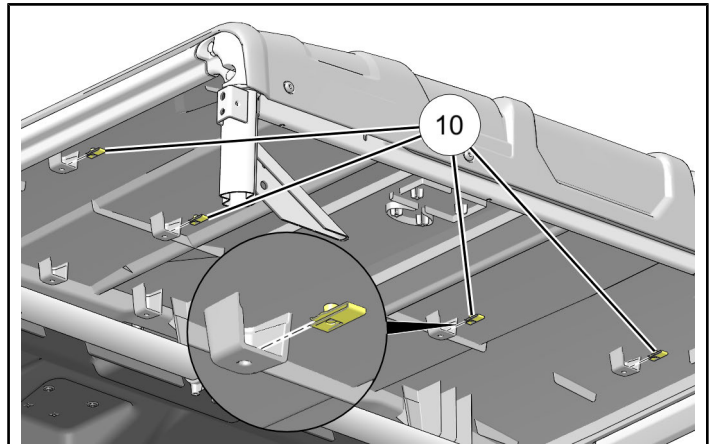

6. Insert rear edges ③ of rear liner ① into roof support channel ④, then tip liner up, inserting LH and RH sides of liner between ROPS and roof seal.

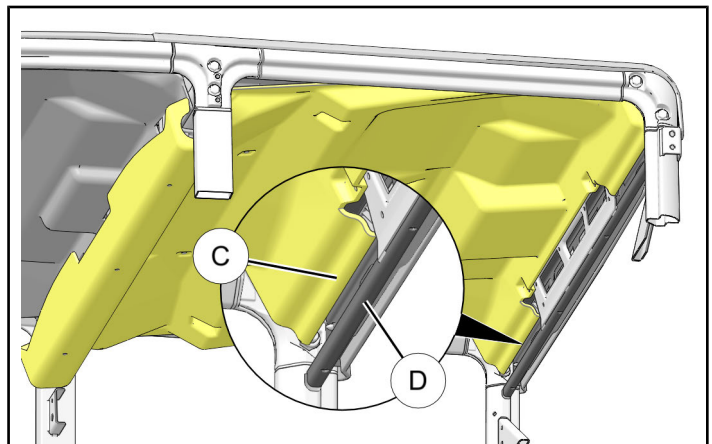

7. If installing optional light, then refer to instructions included with light. Otherwise, loosely install two each screws ④ and washers ⑤ through rear liner ① into roof.

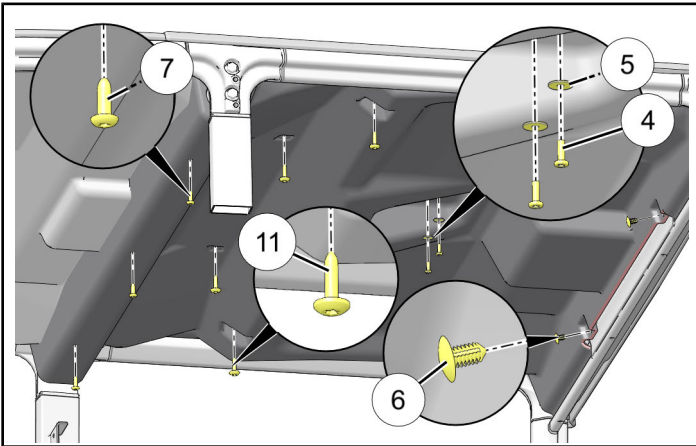

8. Secure rear liner ② by loosely installing three screws ⑦, four screws ⑪, and two push darts ⑥.
9. Tighten all liner screws ④, ⑦, and ⑪. Do not overtighten screws.

10. Decal application.

IMPORTANT

Decals required per ANSI/ROHVA standards.

MY18 and newer *RANGER XP® 1000*

Apply payload decal ⑧ and general use decal ⑨ to front liner ③ as shown.

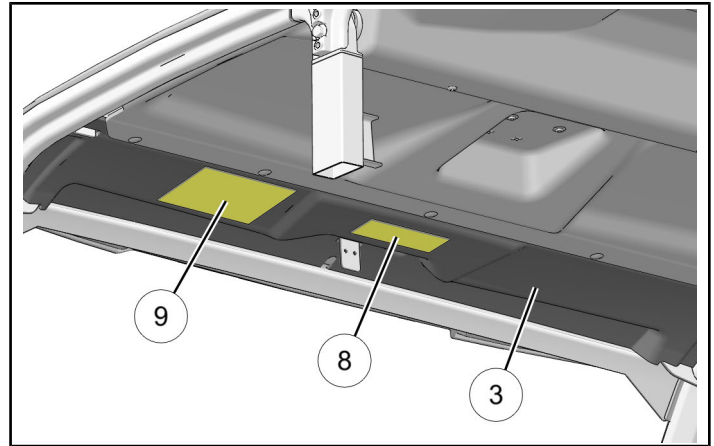

MY19 and older *RANGER XP® 900*

All required decals are applied to vehicle from factory. Decals ⑧ and ⑨ are not used.

11. If installing optional rear speakers, then refer to instructions included with speakers.

FEEDBACK FORM

A feedback form has been created for the installer to provide any comments, questions or concerns about the installation instructions. The form is viewable on mobile devices by scanning the QR code or by clicking [HERE](#) if viewing on a PC.

FEEDBACK FORM

